

T. 30 S., R. 4 W., W.M.
T. 30 S., R. 3 W., W.M.

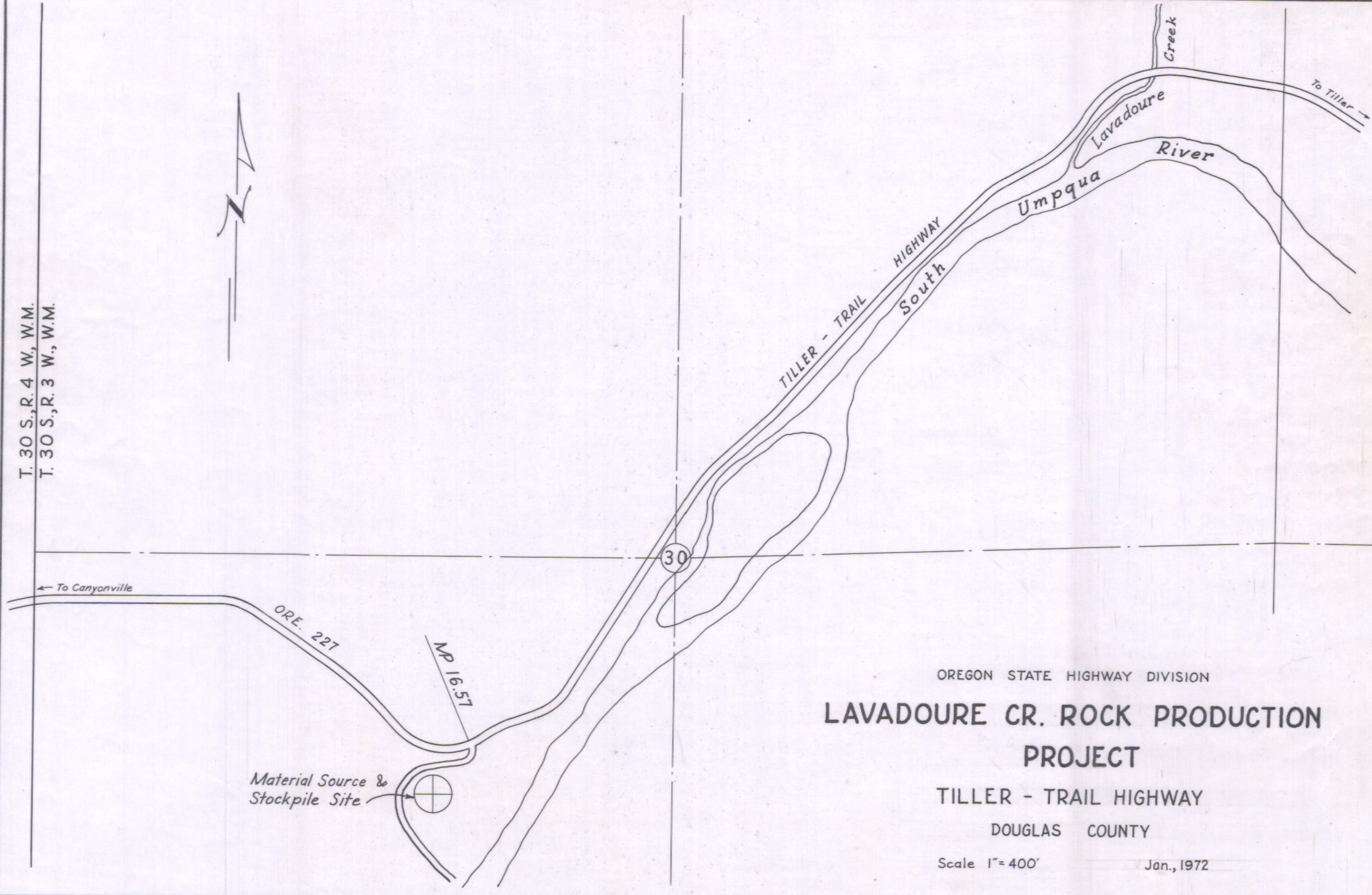

TILLER - TRAIL
HIGHWAY
South

Lavadoire
Creek
Umpqua
River

To Tillier →

← To Canyonville

ORE. 227

MP 16.57

30

Material Source &
Stockpile Site

OREGON STATE HIGHWAY DIVISION

LAVADOIRE CR. ROCK PRODUCTION PROJECT

TILLER - TRAIL HIGHWAY

DOUGLAS COUNTY

Scale 1" = 400'

Jan., 1972