

T.28 S. R.6 W. WM.

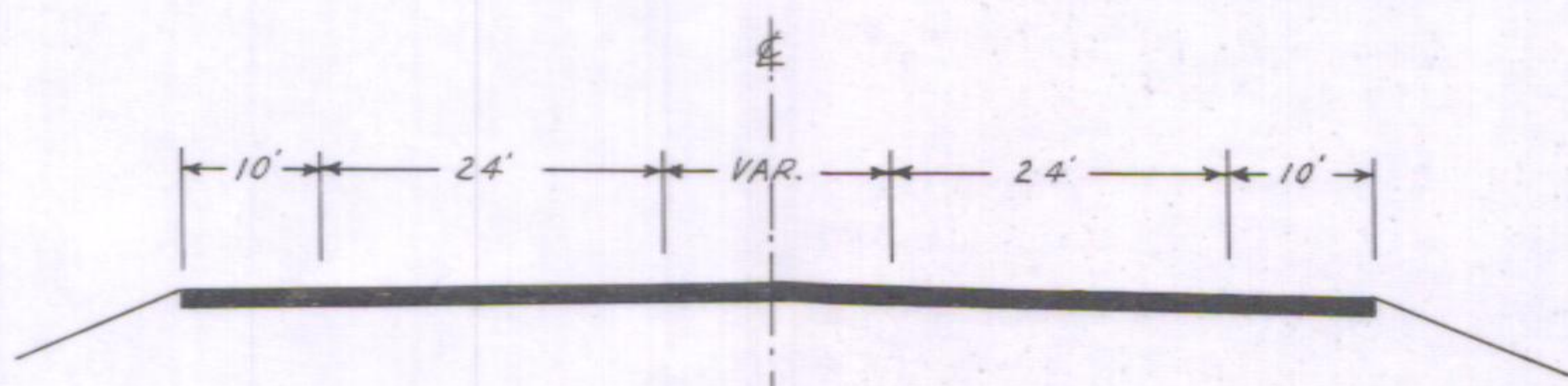
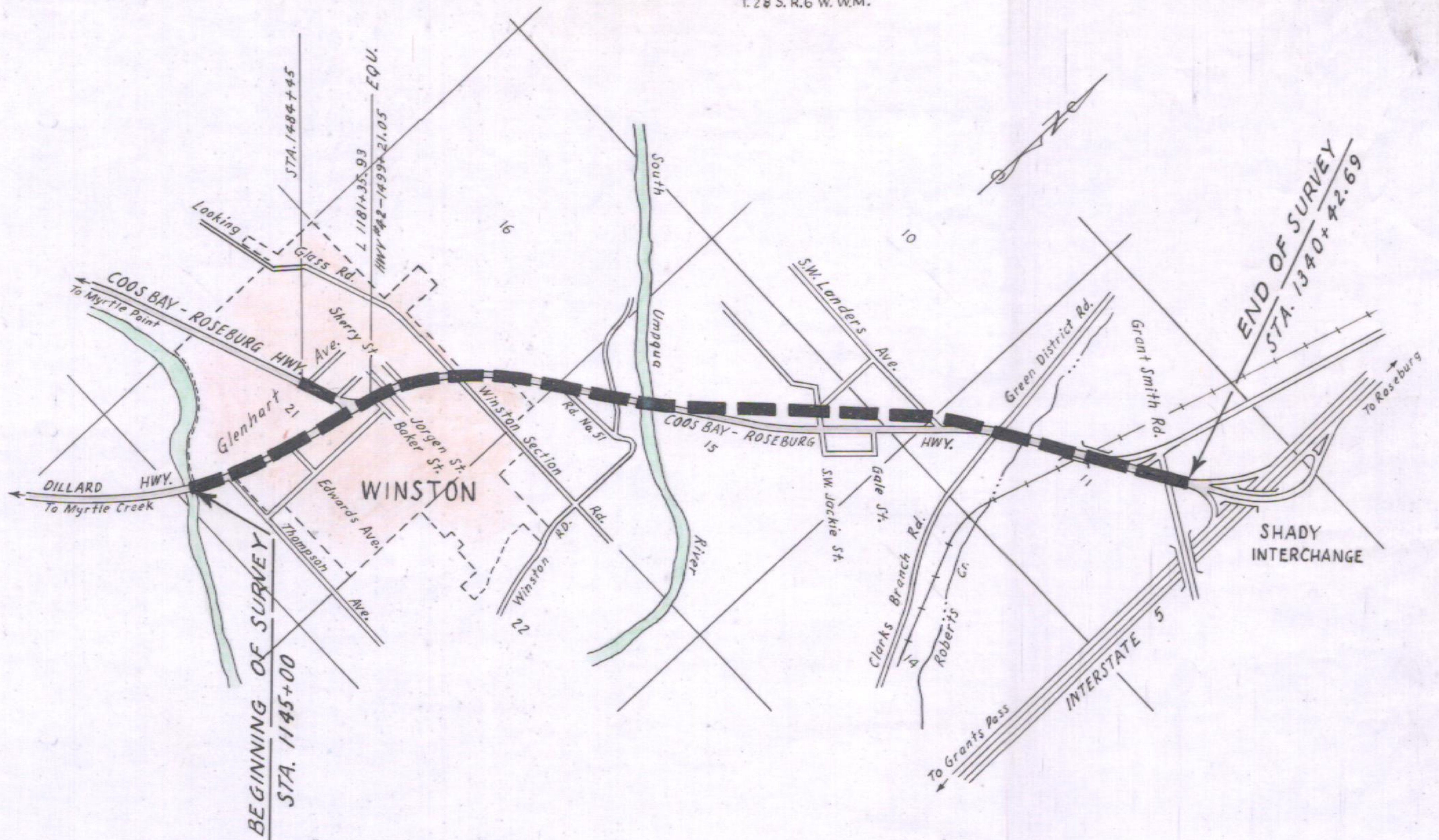

TYPICAL SECTION

PUBLIC HEARING	10-28-69
SYSTEM ACTION	
COUNTY	None Required
STATE HIGHWAY COMMISSION	" "
BUREAU OF PUBLIC ROADS	" "
THROUGHWAY RESOLUTION ADOPTED	" "
ACCESS CONTROL	Limited

APPROVED: \_\_\_\_\_, 19\_\_\_\_  
 DEPUTY STATE HIGHWAY ENGINEER

OREGON STATE HIGHWAY DEPARTMENT  
 SURVEY DESIGN APPROVAL MAP  
**WINSTON-SHADY INTERCHANGE**  
 COOS BAY - ROSEBURG HIGHWAY  
 DOUGLAS COUNTY  
**DRG. NO. 1R-4-446**

SCALE: 2" = 1 Mile ±      DATE: May, 1970  
 FOR DETAILS SEE DRG. NO. 9B-7-5

3.70 Mi.

ADOPTED BY COMM 6-2-70