

T. 24 S., R. 7 W.W.M.

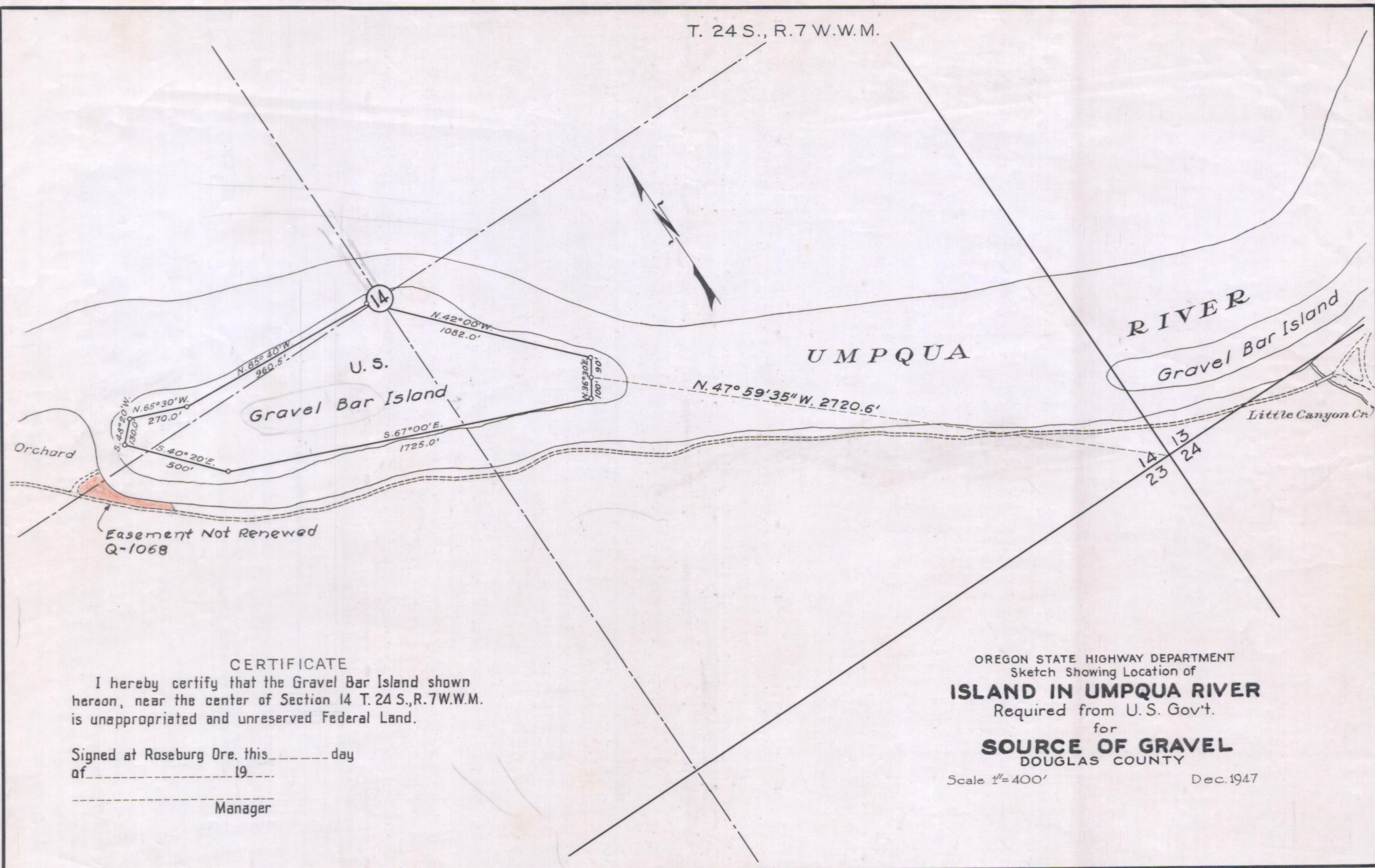

CERTIFICATE

I hereby certify that the Gravel Bar Island shown hereon, near the center of Section 14 T. 24 S., R. 7 W.W.M. is unappropriated and unreserved Federal Land.

Signed at Roseburg Ore. this \_\_\_\_\_ day of \_\_\_\_\_ 19\_\_\_\_

\_\_\_\_\_  
Manager

OREGON STATE HIGHWAY DEPARTMENT  
Sketch Showing Location of  
**ISLAND IN UMPQUA RIVER**  
Required from U.S. Gov't.  
for  
**SOURCE OF GRAVEL**  
DOUGLAS COUNTY

Scale 1"=400'

Dec. 1947