

T. 30 S., R. 3 W.W.M.

023005

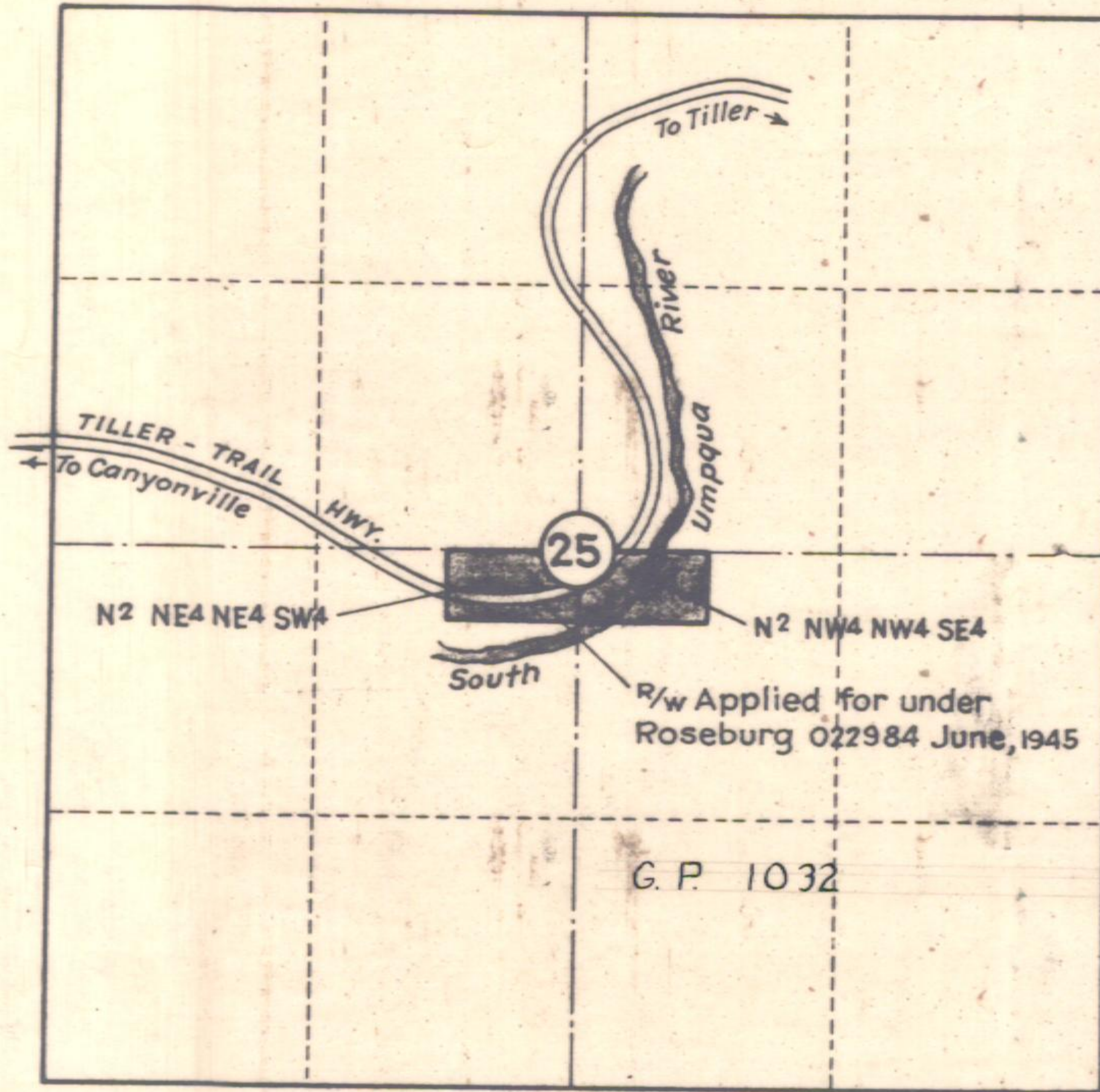

CERTIFICATE

I hereby certify that the following described lands are, as of this date, unappropriated and unreserved Federal Lands.

Signed at Roseburg this 26 day of September, 1945

SEC. 25, T. 30 S., R. 3 W.W.M.

N $\frac{1}{2}$  of NE $\frac{1}{4}$  of NE $\frac{1}{4}$  of S.W $\frac{1}{4}$

N $\frac{1}{2}$  of NW $\frac{1}{4}$  of NW $\frac{1}{4}$  of SE $\frac{1}{4}$

*Richard H. [Signature]*  
Register

OREGON STATE HIGHWAY DEPARTMENT	
Acquire from	U. S. Government
For	GRAVEL PIT
Highway	TILLER - TRAIL
County	Douglas
Scale 1 in. = 1000 ft.	Date Sept, 1945