

SE 1/4 SEC. 35, T. 27 S., R. 6 W., W.M.
 SW 1/4 SEC. 36, T. 27 S., R. 6 W., W.M.
 NE 1/4 SEC. 2, T. 28 S., R. 6 W., W.M.
 NW 1/4 SEC. 1, T. 28 S., R. 6 W., W.M.

FILED
 Date 12/2/2011 By JC
 This survey consists of
 Map ST HWY 15-027A-3
 Narrative: _____
 Corner Rpt: _____
 DOUGLAS COUNTY
 SURVEYOR

NETWORK POINT COORDINATE TABLE

PT. NO.	LDP NORTHING	LDP EASTING	DATE	DESCRIPTION
22	171397.051	376447.477	2-05-02	FND. 16 mm IRON REBAR W/ 38 mm BRASS CAP STAMPED "ODOT CONTROL 22" FLUSH W/ SURFACE, GOOD CONDITION (REF. SURVEY ST HWY 15-006, A-L)
23	171756.566	376393.617	2-05-02	FND. 16 mm IRON REBAR W/ 38 mm BRASS CAP STAMPED "ODOT CONTROL 23" 90 mm ABOVE SURFACE, GOOD CONDITION (REF. SURVEY ST HWY 15-006, A-L)
49	172340.453	377030.012	2-05-02	FND. 16 mm IRON REBAR W/ 38 mm BRASS CAP STAMPED "ODOT CONTROL 49" FLUSH W/ SURFACE, GOOD CONDITION (REF. SURVEY ST HWY 15-006, A-L)
200	170576.829	376669.914	2-05-02	FND 16 mm IRON REBAR W/ 38 mm BRASS CAP STAMPED "ODOT CONTROL 200" FLUSH IN A.C. (REF. SURVEY ST HWY 15-014, A-H)
201	170752.017	376624.799	2-05-02	FND 16 mm IRON REBAR W/ 38 mm BRASS CAP STAMPED "ODOT CONTROL 201" FLUSH IN A.C. (REF. SURVEY ST HWY 15-014, A-H)
202	170906.259	376798.250	2-05-02	FND 16 mm IRON REBAR W/ 38 mm BRASS CAP STAMPED "ODOT CONTROL 202" (REF. SURVEY ST HWY 15-014, A-H)
204	170113.855	376812.277	2-05-02	FND 16 mm IRON REBAR W/ 38 mm BRASS CAP STAMPED "ODOT CONTROL 204" FLUSH W/ SURFACE. (REF. SURVEY 15-014, A-H)
600	170857.354	376752.751	2-13-02	FND RAILROAD SPIKE IN BIKE PATH A.C., FLUSH W/ SURFACE. (REF. SURVEY ST HWY 15-014, A-H)
603	171348.180	376456.357	2-11-02	FND 16 mm IRON REBAR W/ 38 mm ALUM. CAP STAMPED "ODOT HORIZ CONTROL 603", FLUSH W/ SURFACE. (REF. SURVEY ST HWY 15-014, A-H)
750	171087.947	376620.400	7-26-11	SET 13 mm IRON REBAR W/ RPC STAMPED "DEA CONTROL"

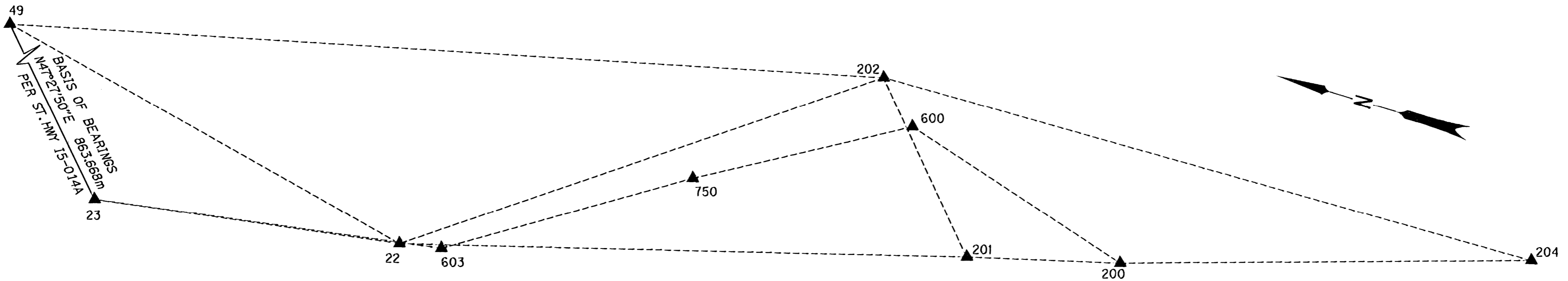

SURVEY NARRATIVE

THE PURPOSE OF THIS SURVEY IS TO SHOW MONUMENTS SET AFTER THE COMPLETION OF CONSTRUCTION OF THE SHADY BRIDGE. MONUMENTS SET ARE LOCATED ON I-5 O'XING: SOUTH UMPQUA RIVER & OR 99 (SHADY) SEC MAP 10B-18-29. PARCELS STAKED ARE 7093001, 7093002, 7093004 AND 7093008. ADDITIONAL MONUMENTS WERE RESET DUE TO BEING DAMAGE OR DESTROYED DURING CONSTRUCTION.

BASIS OF BEARING BETWEEN POINTS 23 AND 49 IS N 47°27'50" E TAKEN FROM DOUGLAS COUNTY SURVEY MAPS ST HWY 1-5 - 006 A-L, ST HWY 1-5 - 014 A-H, AND AS SHOWN ON 10B-18-29.

LEGEND	
★	SET GPS POINT
▲	SET NETWORK POINT

REGISTERED
 PROFESSIONAL
 LAND SURVEYOR

 OREGON
 JULY 11, 2005
 F. DANIEL ADSIT
 75495LS
 EXPIRES: 12/31/2011



DAVID EVANS
 AND ASSOCIATES INC.
 530 CENTER STREET NE, SUITE 605
 SALEM OREGON 97301
 PHONE: 503.361.8635

FILE NAME: 12401POSTMON.DGN

OREGON DEPARTMENT OF TRANSPORTATION

POST CONSTRUCTION MONUMENTATION SURVEY
 I-5 O'XING: SOUTH UMPQUA RIVER AND
 OR99 PACIFIC HWY (SHADY)
 DOUGLAS COUNTY, OREGON

REGION 3 HEADQUARTERS/DISTRICT 7
 3500 NW STEWART PARKWAY
 ROSEBURG, OR 97470

OCTOBER 31, 2011
 SCALE: 1:1000
 SHEET 2 OF 9

ST. HWY. I5 -027 B