

FILED
 Date: 8-16-2004 By: J.C.
 This survey consists of:
 Main: St. Hwy
 Notes: IS-017 A-H
 Corner:
 DOUGLAS COUNTY
 SURVEYOR

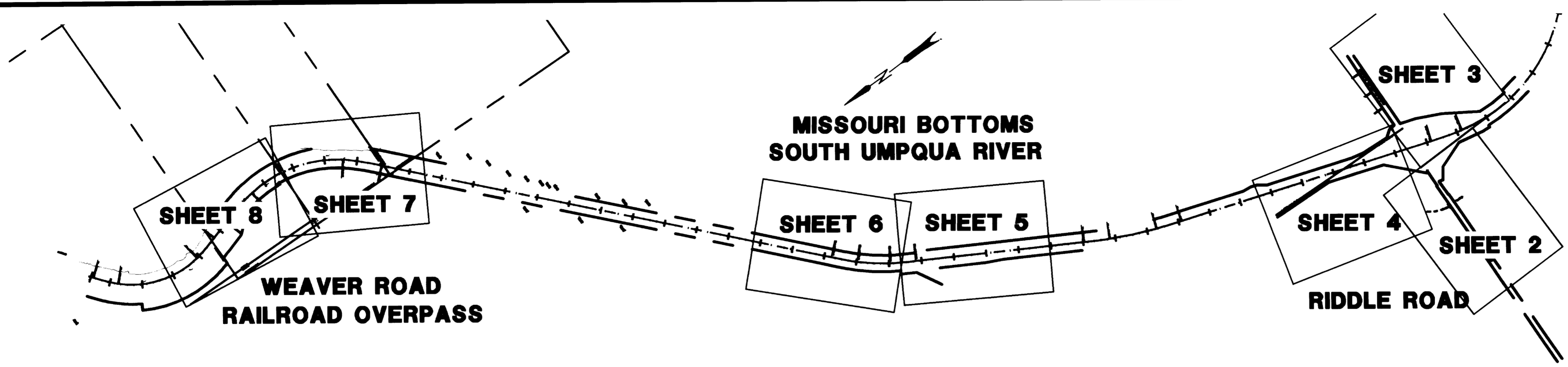

SURVEY NARRATIVE

THIS SURVEY WAS PREPARED AT THE REQUEST OF THE OREGON DEPARTMENT OF TRANSPORTATION FOR THE PURPOSE OF RESOLVING THE CENTERLINE LOCATION OF INTERSTATE HIGHWAY NO.5 FROM APPROXIMATELY MYRTLE CREEK TO THE RIDDLE ROAD INTERCHANGE. IT ALSO RECOVERS AND DOCUMENTS EXISTING SURVEY MONUMENTATION IN DANGER OF DESTRUCTION BY THE CONSTRUCTION OF FIVE NEW STRUCTURES ALONG THAT HIGHWAY. THIS SURVEY BEGAN IN APRIL OF 2004 AND CONCLUDED IN JULY OF THE SAME YEAR. INITIAL CONTROL WAS PROVIDED BY DOUGLAS COUNTY MAP OF SURVEY NO. M129-39. THIS SURVEY WAS PERFORMED FOR THE OREGON DEPARTMENT OF TRANSPORTATION BY CHRISTINE V. BLEVINS, P.L.S. IN DECEMBER OF 1999. MONUMENTS FROM THAT SURVEY WERE RECOVERED USING A COMBINATION OF STATIC AND REAL TIME KINEMATIC GPS SURVEY TECHNIQUES AND THE NETWORK WAS VERIFIED USING A TRIMBLE 5600 TOTAL STATION AND A SOKKIA DIGITAL LEVEL. MONUMENTS WERE FOUND AS THEY ARE DESCRIBED ON THAT MAP AND FOUND TO BE IN HARMONY WITH THE COORDINATES PUBLISHED FOR THAT SURVEY.

THE COORDINATE SYSTEM IS AN ODOT "LOCAL DATUM PLANE" SYSTEM CONSISTING OF OREGON STATE PLANE COORDINATES, (NAD83, 1991), SOUTH ZONE, MODIFIED TO REPRESENT TRUE GROUND DISTANCES. TO RETURN THOSE COORDINATES TO STATE PLANE GRID, MULTIPLY BOTH THE NORTH AND EAST COMPONENTS BY 0.99986780.

OREGON DEPARTMENT OF TRANSPORTATION ROLL MAP #7B-22-19, PUBLISHED IN AUGUST 1953 AND REVISED IN APRIL AND JUNE OF 1973, WAS UTILIZED TO ESTABLISHED THE GEOMETRY OF THE HIGHWAY CENTERLINE. SOME DISCREPANCIES WERE NOTED BETWEEN LOCATED MONUMENTS AND THE PUBLISHED CENTERLINE GEOMETRY BUT THEY WERE CONSIDERED TO BE WELL WITHIN THE STANDARDS OF ACCURACY FOR THAT TIME PERIOD.

AFTER THE CENTERLINE LOCATION WAS RESOLVED, COORDINATES WERE CALCULATED FOR THE CALLED FOR MONUMENTATION FROM MAP 7B-22-19. THE PHYSICAL CHARACTERISTICS OF THE ODOT RIGHT OF WAY MONUMENTS RECOVERED, SMOOTH IRON RODS, WERE DIFFERENT FROM THE CALLED FOR IRON PIPES BUT THEIR LOCATIONS AGREED VERY CLOSELY WITH THOSE PUBLISHED ON 7B-22-19. IN CONJUNCTION WITH THE RECOVERY OF MONUMENTS FROM MAP 7B-22-19, THE RECORDS OF THE DOUGLAS COUNTY SURVEYOR'S OFFICE WERE SEARCHED FOR MONUMENTS FROM PRIVATE SURVEYS ADJOINING THE HIGHWAY RIGHT-OF-WAY. THEIR COORDINATES AND MAP REFERENCES ARE INCLUDED IN THE TABLES PUBLISHED ON THIS SURVEY.

BASIS OF BEARINGS

BEARINGS ARE BASED ON THE OREGON STATE PLANE COORDINATE SYSTEM, SOUTH ZONE.

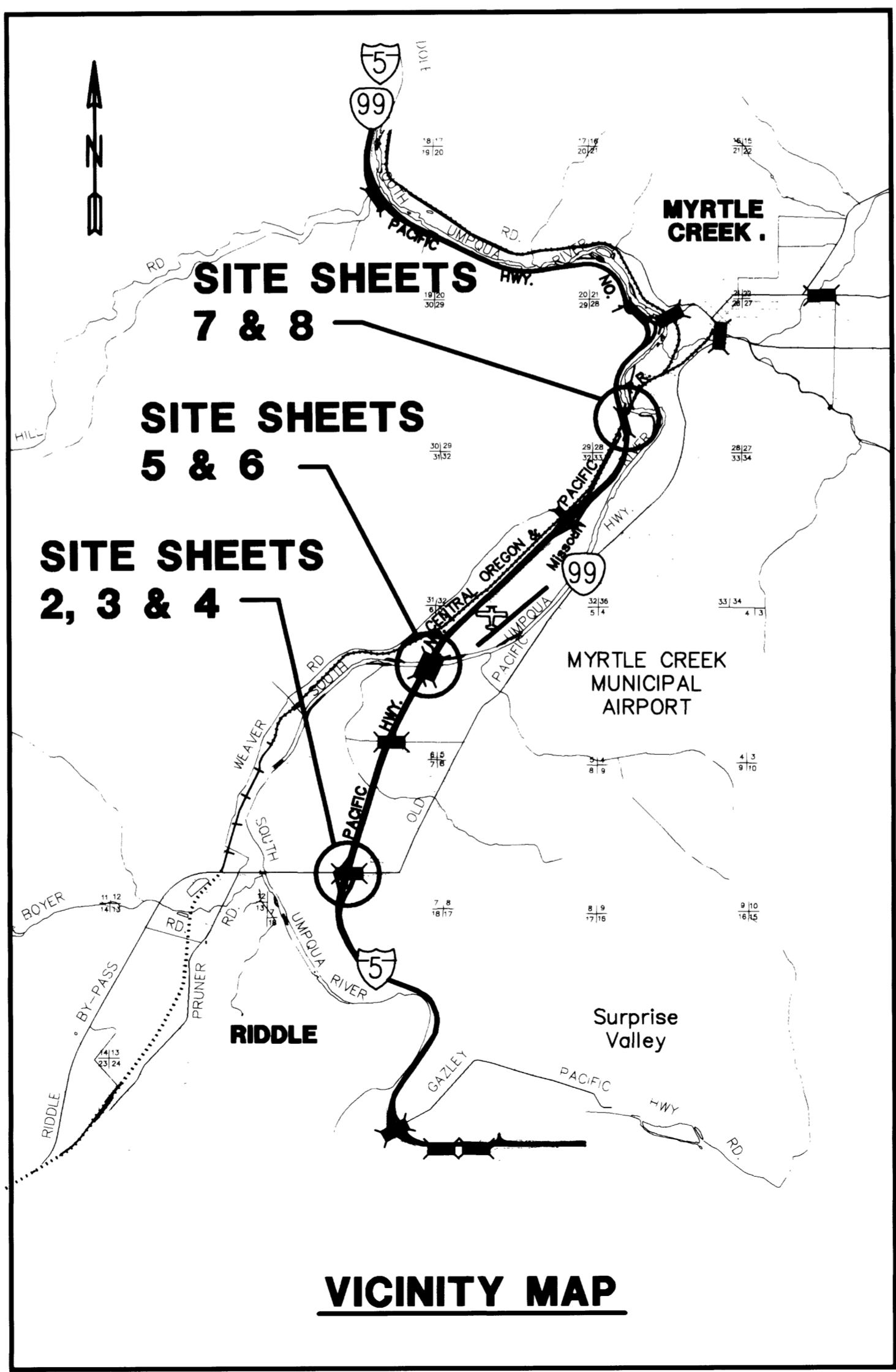

REFERENCE DOCUMENTS

MAPS:
 M 129-39A-H, M 132-54, Vol. 20 Page 51, File 85 Drawer 37, C.S. File No. 42/420, 4/98, C.S. File No. 58/44-3A, C.S. 51/237-3, C.S. 63/118, Vol. 10 Page 6, Vol. 18 Page 20A, C.S. File No. 42/319, Vol. 20 Page 51, M 132-7, M 8-27, M 137-15, M 10-28, C20, M 62-77, M 23-36, O.D.O.T. 7B-22-19.

REGISTERED
 PROFESSIONAL
 LAND SURVEYOR

 OREGON
 JAN. 21, 1908
 HARMON E. MCLENDON
 2837
 Renewed 12/31/04

MONUMENT RECOVERY SURVEY		
SW1/4 SEC. 28, NW1/4 SEC. 33, T29S, R5W, W.M.		
NW1/4 SEC. 5, NE1/4 SEC. 6, T30S, R5W, W.M.		
NW1/4, SW1/4 & SE1/4 SECTION 7, T30S, R5W, W.M.		
DOUGLAS COUNTY, OREGON		
OREGON DEPARTMENT OF TRANSPORTATION		
SCALE: NONE	 anderson perry associates, inc. <small>ENGINEERING SURVEYING MATERIALS TESTING LA GRANDE, OR. WALLA WALLA, WA.</small>	SHEET 1/8
DATE: JULY 2004		
JOB NO. 863-60		