

SW 1/4 & SE 1/4 SEC. 1, AND NE 1/4 & SE 1/4 SEC. 12, T29S, R6W, W.M.,
AND NW 1/4 & SW 1/4 SEC. 7, T29S, R5W, W.M.

FILED
Date: 1/18/2002 By: JP
This survey consists of: 2 Pgs.
Map: ST. HWY I 5-012 B
Narrative: _____
Corner Rpt: _____

DOUGLAS COUNTY
SURVEYOR

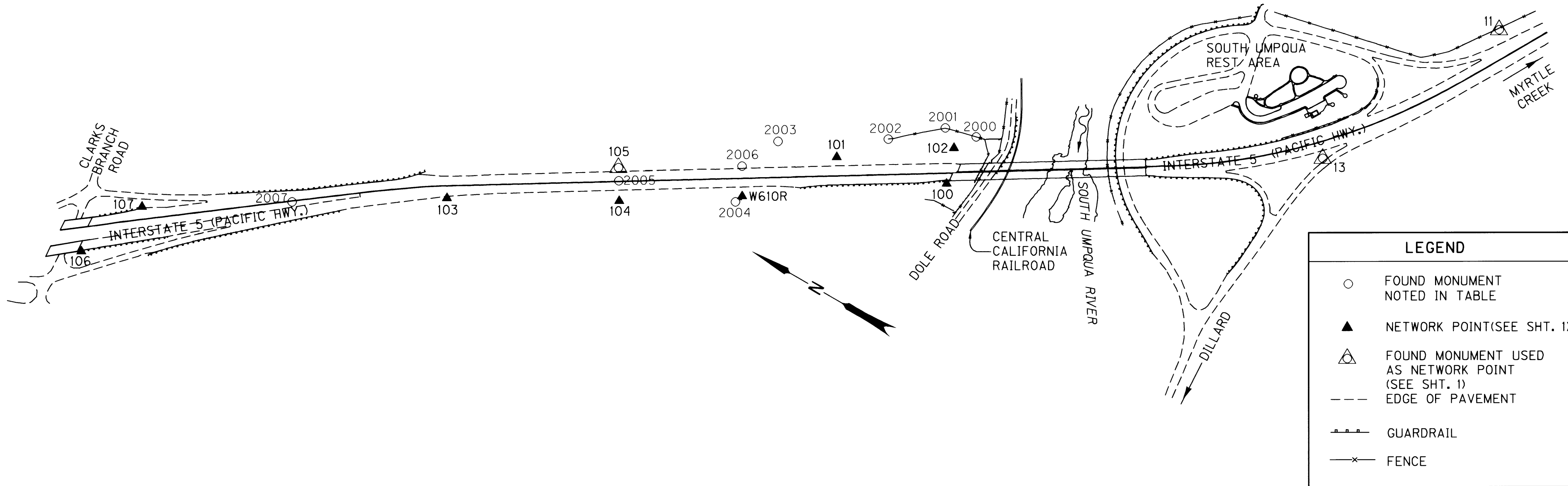

RECOVERED MONUMENT LIST

PT. NO.	LDP NORTHING	LDP EASTING	DATE	DESCRIPTION & REFERENCE DOCUMENTS
2000	159301.133	377733.412	11-20-01	FND. 5/8" I. ROD 100 mm ABOVE SURFACE, GOOD CONDITION, METAL WITNESS POST NEARBY MARKED "SHRW POT 3162+00 175" (ODOT DRG. NO. 8B-29-3)
2001	159344.341	377722.927	11-20-01	FND. 5/8" I. ROD FLUSH W/SURFACE, GOOD CONDITION, METAL WITNESS POST NEARBY (ODOT DRG. NO. 8B-29-3)
2002	159404.836	377669.996	11-20-01	FND. 5/8" I. ROD 80 mm ABOVE SURFACE, GOOD CONDITION, METAL WITNESS POST NEARBY MARKED "SHRW POT 3158+00 175" (ODOT DRG. NO. 8B-29-3)
2003	159535.465	377590.772	11-20-01	FND. 5/8" I. ROD 85 mm ABOVE SURFACE, GOOD CONDITION, METAL WITNESS POST NEARBY MARKED "SHRW 3153+00 175" (ODOT DRG. NO. 8B-29-3)
2004	159544.424	377488.686	11-20-01	FND. 5/8" I. ROD W/ 1 1/2" ALUM. CAP STAMPED "OREG. STATE HWY. DEPT." FLUSH W/SURFACE, GOOD CONDITION, METAL WITNESS POST NEARBY MARKED "SHRW POT 3151+00 90" (ODOT DRG. NO. 8B-29-3)
2005	159698.856	377433.663	11-20-01	FND. 2 3/4" BRASS DISK SET IN CONC. 40 mm BELOW ASPHALT, GOOD CONDITION, STAMPED "STATE HIGHWAY DEPARTMENT BM NO ELEVATION FEET 20.00" (ODOT DRG. NO. 8B-29-3)
2006	159561.283	377536.409	11-23-01	FND. 2 3/4" BRASS DISK IN CONC., FLUSH W/SURFACE, GOOD CONDITION, STAMPED "STATE HIGHWAY DEPARTMENT BM NO. ELEVATION FEET 3151+33.85 33.67", METAL WITNESS POST NEARBY MARKED "SHRP POT L3151+33.85 33.67" (ODOT DRG. NO. 8B-29-3)
2007	160075.887	377182.811	11-27-01	FND. 2 3/4" BRASS DISK IN CONC., FLUSH W/SURFACE, STAMPED "STATE HIGHWAY DEPARTMENT BM NO. ELEVATION FEET POT 3130+86.10 29.3", WITNESS POST NEARBY MARKED "SHRW POT 3130+86.10 29.30" (ODOT DRG. NO. 8B-29-3)

REGISTERED
PROFESSIONAL
LAND SURVEYOR
Christine V. Blewins
OREGON
JULY 19, 1994
CHRISTINE V. BLEWINS
LS2669
EXPIRES 12/31/03

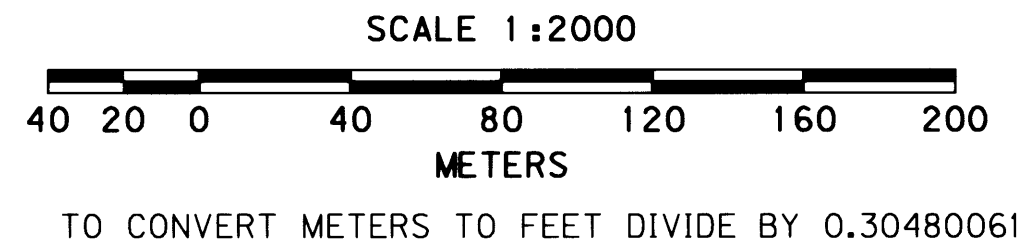

OREGON DEPARTMENT OF TRANSPORTATION
HORIZONTAL CONTROL AND RECOVERY MAP
BOOTH RANCH BRIDGE (VETS BR.-MYRTLE CREEK)
PACIFIC HIGHWAY (INTERSTATE 5)
DOUGLAS COUNTY
JANUARY 17, 2002 FOR ODOT REGION 3
3500 NW STEWART PKWY., ROSEBURG, OR 97470
SHEET 2 OF 2