

COUNTY SURVEYORS FILE DATA
DO NOT REMOVE FROM OFFICE

SE 1/4 SEC. 34, T. 30 S., R. 5 W., W. M.

FILED
Date: 10/30/2000 By: SP
This survey consists of: 16 Pgs.
Map: M135-71C
Narrative: _____
Corner Apt: _____
DOUGLAS COUNTY
SURVEYOR

LEGEND	
▲	SET MONUMENT
○	FOUND MONUMENT
●	BENCH MARK USED AS NETWORK POINT
—	CONCRETE BARRIER
- - -	EDGE OF PAVEMENT

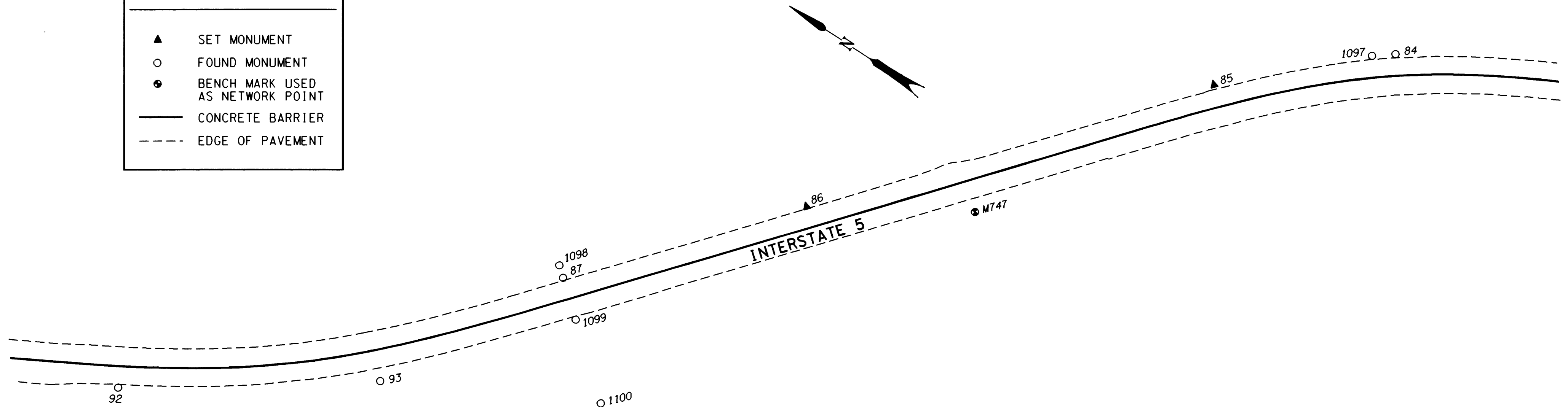

POINT ID	LDP NORTHING	LDP EASTING	DESCRIPTION
84	142238.603	383884.591	FOUND 5/8" IRON ROD W/A 1 1/2" ALUM. CAP STAMPED "OREG. STATE HWY. DIV." 100 mm BELOW SURFACE SET IN CONC. IN GOOD CONDITION. PADDLE BOARD NEARBY MARKED "SHRW P.C.S. LC 106+78.26" REFERENCE LEFT. (DRG. *8B-30-24)
85	142332.831	383797.766	SET 16 mm X 762 mm IRON REBAR W/A 38 mm BRASS CAP STAMPED "ODOT CONTROL 85".
86	142522.340	383570.866	SET 16 mm X 762 mm IRON REBAR W/A 38 mm BRASS CAP STAMPED "ODOT CONTROL 86" 30 mm BELOW SURFACE.
87	142635.288	383435.424	FOUND 5/8" IRON ROD W/A 1 1/2" ALUM. CAP STAMPED "OREG. STATE HWY. DIV." 120 mm BELOW SURFACE SET IN CONC. IN GOOD CONDITION. PADDLE BOARD NEARBY MARKED "SHRW P.T. LC 87+21.37" REFERENCE LEFT. (DRG. *8B-30-24)
92	142851.289	383201.390	FOUND 16 mm SQ. IRON ROD W/A 38 mm ALUM. CAP STAMPED "ODOT HORIZ. CONTROL 92" FLUSH W/ SURFACE IN GOOD CONDITION. ORANGE CARSONITE POST NEARBY. (REF. M129-39)
93	142701.704	383305.384	FOUND 16 mm SQ. IRON ROD W/A 38 mm ALUM. CAP STAMPED "ODOT HORIZ. CONTROL 93" FLUSH W/ SURFACE IN GOOD CONDITION. ORANGE CARSONITE POST NEARBY. (REF. M129-39)
1097	142251.564	383874.598	FOUND 5/8" IRON ROD W/A 1 1/2" ALUM. CAP STAMPED "OREG. STATE HWY. DEPT." SET IN CONC. 100 mm BELOW SURFACE IN GOOD CONDITION. PADDLE BOARD NEARBY MARKED "SHRW P.S.C. LC 106+26.70" REFERENCE LEFT. (DRG. *8B-30-24)
1098	142642.291	383441.315	FOUND 3/4" IRON ROD FLUSH W/ SURFACE IN GOOD CONDITION. PADDLE BOARD NEARBY MARKED "SHRW P.T. L 87+21.37 80", 80 FT. LT. (DRG. *8B-30-24)
1099	142611.937	383415.863	FOUND 5/8" IRON ROD W/A 1 1/2" ALUM. CAP STAMPED "OREG. STATE HWY. DIV." SET IN CONC. 150 mm BELOW SURFACE IN GOOD CONDITION. STATION P.T. 87+21.37 REFERENCE RIGHT. (DRG. *8B-30-24)
1100	142565.267	383376.781	FOUND 5/8" IRON ROD 50 mm ABOVE SURFACE IN GOOD CONDITION. PADDLE BOARD NEARBY MARKED "SHRW PT 87+21.37 250", 250.0 FT. RT. (DRG. *8B-30-24)
M747	142422.026	383631.651	FOUND 3 5/8" BRASS DISK SET FLUSH IN ROCK CUT BANK STAMPED "FOR INFORMATION OR TO REPORT DAMAGE WRITE WASHINGTON DC VERTICAL CONTROL MARK M747 1987 THE DIRECTOR NATIONAL GEODETIC SURVEY". NGS BENCHMARK W/ ORANGE CARSONITE POST NEARBY.

REGISTERED
PROFESSIONAL
LAND SURVEYOR
Christine V. Blawie
OREGON
JULY 19, 1994
CHRISTINE V. BLAWIE
2000
EXPIRES: DEC. 31, 2001



1 METER = 3937 U.S. FEET / 1200
TO CONVERT A METRIC DISTANCE DIVIDE BY 0.30480061

OREGON DEPARTMENT OF TRANSPORTATION
HORIZONTAL CONTROL
AND RECOVERY MAP
CANYONVILLE - AZALEA SECTION
INTERSTATE 5
DOUGLAS COUNTY
3500 STEWART PARKWAY, SUITE 140
ROSEBURG, OREGON 97470

OCTOBER 26, 2000
PROJECT KEY *10832

SHEET 3 OF 16

ST. HWY. 15-010C

MAP FILE M135-71C

MAP FILE M135-71C