

T. 26 S. R. 6 W. W.M., SEC. 24, NE 1/4



FILED  
 Date: 6/13/2000 By: JP  
 This survey consists of: 2 PAGES  
 Map: M135-2A  
 Narrative: \_\_\_\_\_  
 Corner Rpt: \_\_\_\_\_  
 DOUGLAS COUNTY SURVEYOR JP

COUNTY SURVEYORS FILE DATA  
 DO NOT REMOVE FROM OFFICE

MAP FILE M135-2A

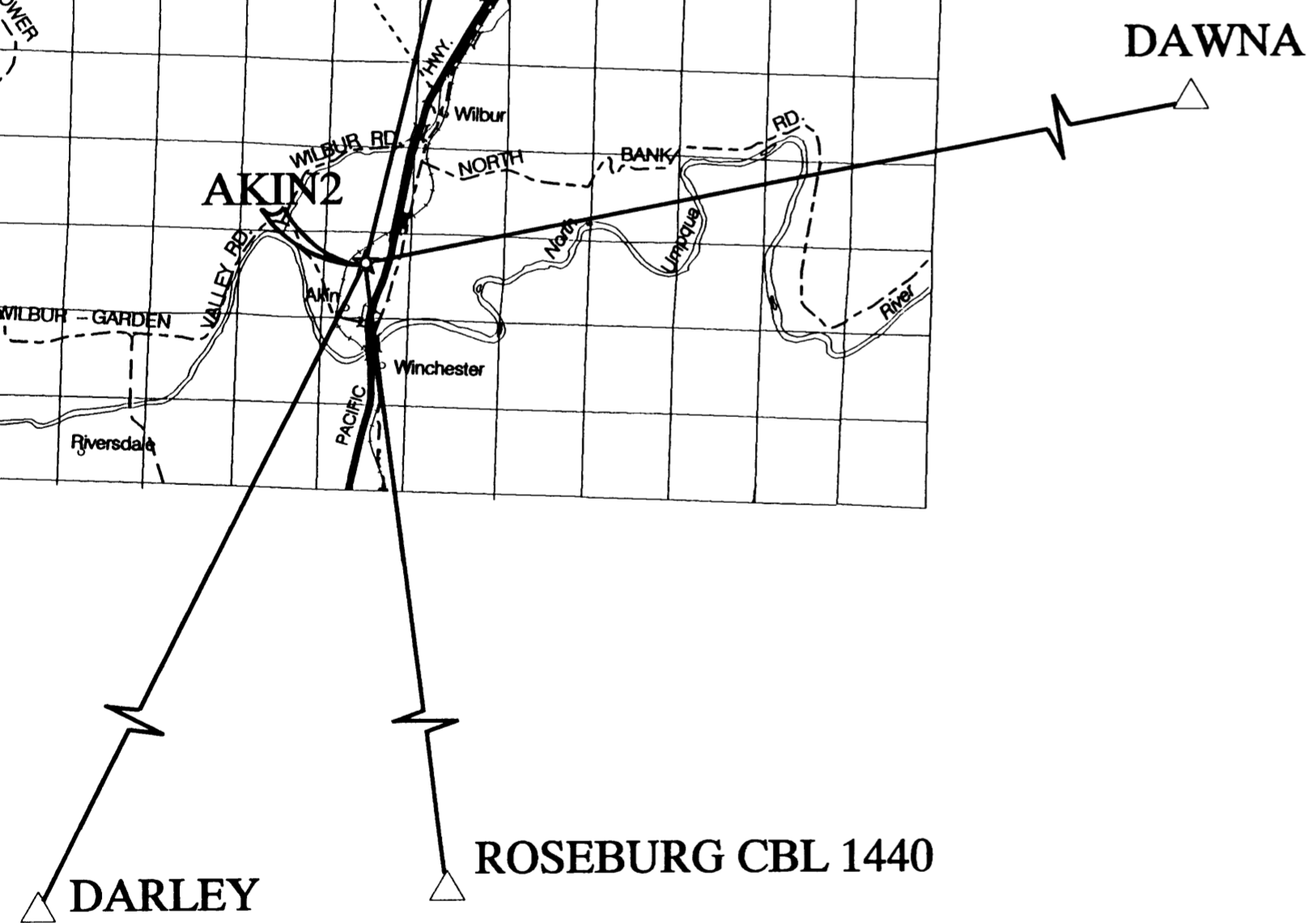
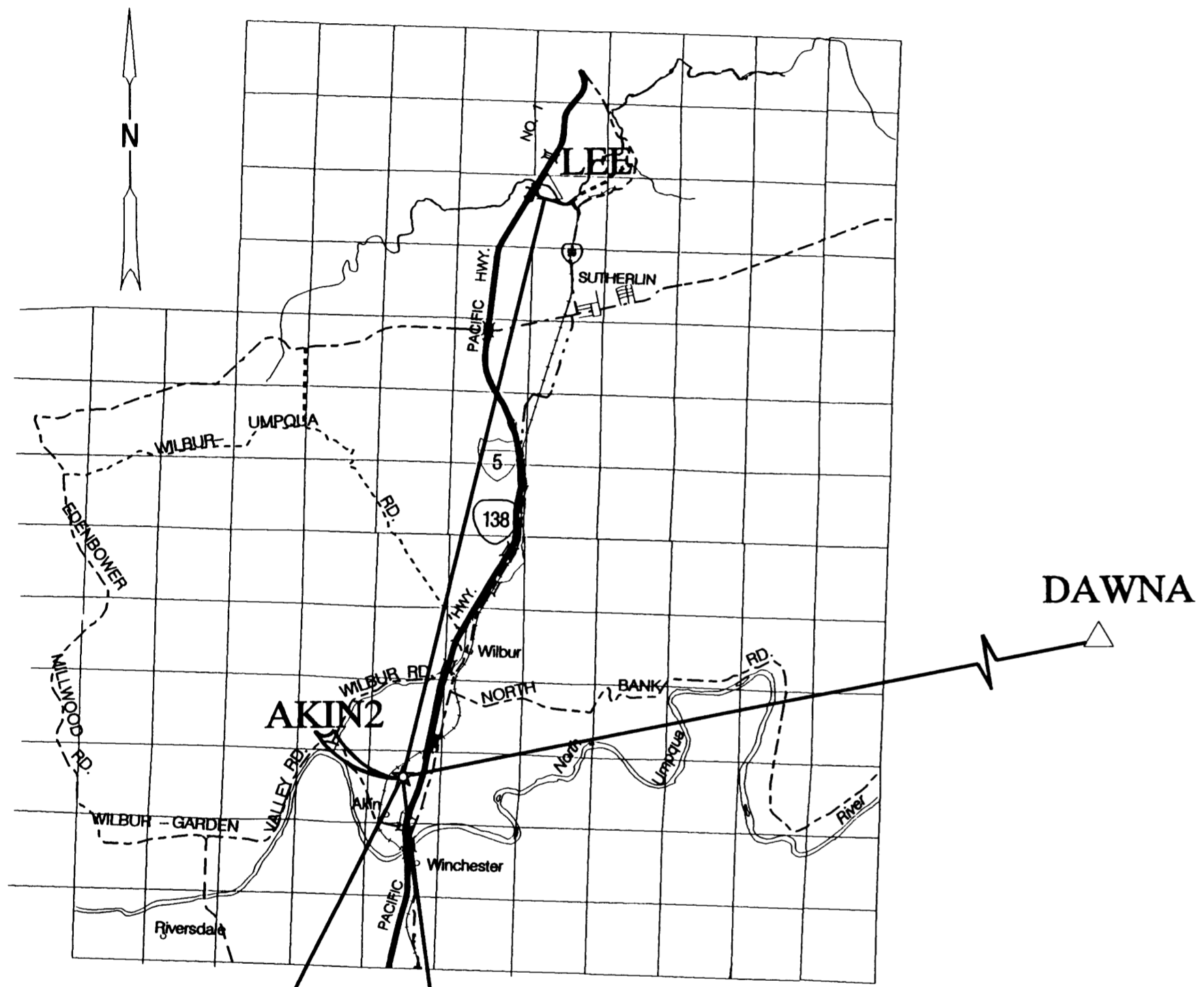

NETWORK MAP



NOT TO SCALE

SITE MAP

LEGEND	
☆	SET GPS POINT
△	NGS MONUMENT
—	HARN TIES

REGISTERED PROFESSIONAL LAND SURVEYOR  
*Wade B. Ansell*  
 OREGON  
 JUNE 30, 1997  
 WADE B. ANSELL  
 02037LS  
 EXPIRES: DEC. 31, 2001

OREGON DEPARTMENT OF TRANSPORTATION  
 GEODETIC SURVEY REPORT  
 GREEN LIGHT PROJECT  
 DOUGLAS COUNTY  
 FOR ODOT - GEOMETRONICS -  
 200 HAWTHORNE AVE. NE, SUITE B250 SALEM ,OR. 97301  
 16 MAY, 2000 SHEET 1 OF 2

ST. HWY. 15-008A

MAP FILE M135-2A