

N.W. 1/4 SEC. 19, T. 27 S., R. 5 W., W.M.
 S.W. 1/4 SEC. 18, T. 27 S., R. 5 W., W.M.
 DOUGLAS COUNTY, OREGON

FILED
 Date: 3/22/2004 By: JP
 This survey consists of: 3 Pgs.
 Map: ST Hwy 138-006A
 Narrative:
 Corner Rpt:

DOUGLAS COUNTY
 SURVEYOR

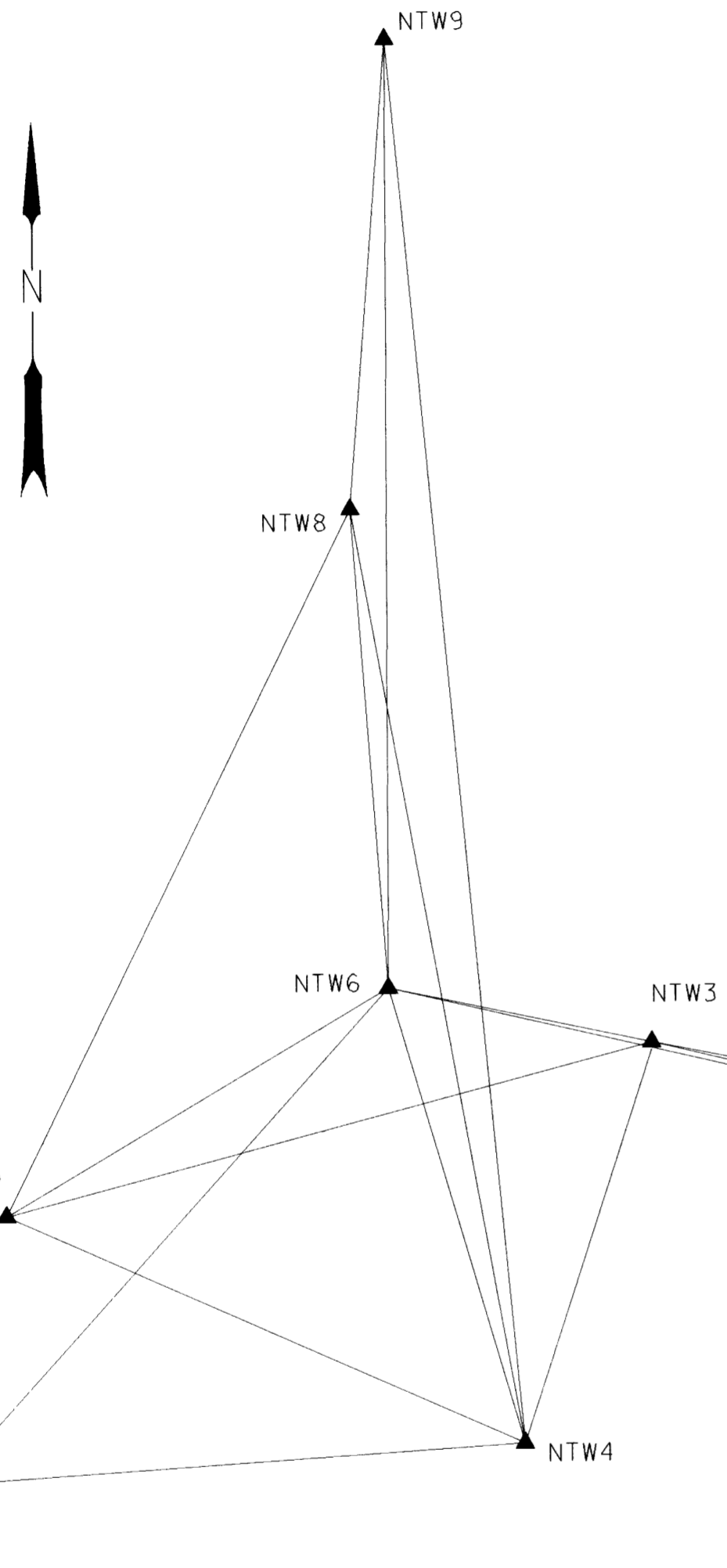

RESIDUALS FOR ANGLES AND DISTANCES

AT	TO	DISTANCE*	DISTANCE RESIDUAL	ANGLE RESIDUAL
5002	5701	1549.093	-0.033	0°00'00"
5002	2	238.181	0.005	0°00'00"
5002	3	763.921	0.005	0°00'00"
2	5701	1786.760	-0.028	0°00'04"
2	3	527.113	0.000	0°00'04"
2	6	705.985	-0.004	0°00'00"
3	4	280.326	-0.003	0°00'05"
3	5	444.961	-0.003	0°00'01"
3	6	178.923	-0.006	0°00'00"
4	5	376.679	0.001	0°00'08"
4	6	316.555	0.004	0°00'03"
4	7	386.316	0.003	0°00'05"
4	8	633.240	0.004	0°00'08"
4	9	940.447	-0.004	0°00'06"
7	6	443.023	0.002	0°00'10"
5	6	296.295	0.001	0°00'05"
6	8	320.270	0.001	0°00'05"
8	9	314.189	0.004	0°00'04"
9	6	632.613	-0.002	0°00'00"

*CALCULATED HORIZONTAL DISTANCE IN FEET
 DERIVED FROM THE MEASURED SLOPE DISTANCE

CONFIDENCE LEVEL LIMITS

POINT ID	SEMI MAJOR	SEMI MINOR	ORIENTATION*
2	0.016	0.013	4°
3	0.026	0.016	11°
4	0.031	0.020	-16°
5	0.043	0.019	-1°
6	0.033	0.017	12°
7	0.056	0.024	-16°
8	0.042	0.023	41°
9	0.056	0.027	64°
5002	0.000	0.000	0°
5701	0.000	0.000	0°

* POSITIVE OR NEGATIVE FROM NORTH

FIXED POINTS NOT SUBJECT TO LEAST SQUARES ADJUSTMENT
 OR CONFIDENCE LEVEL ANALYSIS:

5002
 5701

NETWORK/TRVERSE POINT COORDINATE TABLE

PT. NO.	LDP NORTHING	LDP EASTING	DATE	DESCRIPTION
DLC38	576445.219	1242799.753	12-3-2003	FND 1 3/8" AXEL SHAFT MEASURED AT GROUND LEVEL, TOP OF AXEL IS 1" DIAMETER
KC5701	576546.646	1245647.657	12-3-2003	FND 2 3/4" BRASS DISK SET IN CONCRETE CURB STAMPED CITY OF ROSEBURG 57-1
KC5002	576605.523	1244099.651	12-3-2003	FND 2 1/2" BRASS DISK SET IN CONCRETE WALK STAMPED CITY OF ROSEBURG TO CENTER LINE
NTW2	576631.307	1243862.876	12-3-2003	SET 1 1/8" BRASS PLUG IN CONCRETE WALK STAMPED ODOT CONTROL 2
NTW3	576755.497	1243350.601	12-3-2003	SET 1 1/8" BRASS PLUG IN CONCRETE WALK STAMPED ODOT CONTROL 3
NTW4	576488.816	1243264.200	11-26-2003	SET 1 1/8" BRASS PLUG IN CONCRETE WALK STAMPED ODOT CONTROL 4
NTW5	576642.392	1242920.252	11-26-2003	SET 1 1/8" BRASS PLUG IN CONCRETE WALK STAMPED ODOT CONTROL 5
NTW6	576792.710	1243175.585	11-26-2003	SET 1 1/8" BRASS PLUG IN CONCRETE WALK STAMPED ODOT CONTROL 6
NTW7	576463.891	1242878.692	11-26-2003	SET 12" HUB AND TACK
NTW8	577112.163	1243152.728	11-26-2003	SET 1 1/8" BRASS PLUG IN CONCRETE WALK STAMPED ODOT CONTROL 8
NTW9	577425.320	1243178.120	11-26-2003	SET 1 1/8" BRASS PLUG IN CONCRETE WALK STAMPED ODOT CONTROL 9

BASIS OF BEARINGS

N87°49'19"W

LEGEND	
○	FOUND MONUMENT NOTED IN TABLE
▲	NETWORK POINT
—▲	LINES OF OBSERVATION

SCALE 1" = 100'
 100 50 0 100
 FEET

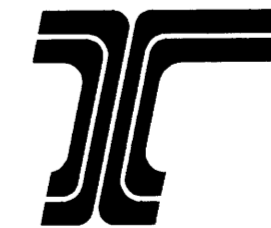

REGISTERED
 PROFESSIONAL
 LAND SURVEYOR

J. David Brinton
 OREGON
 DECEMBER 2, 1983
 J. DAVID BRINTON
 2065

EXPIRES 12/31/2005

OREGON DEPARTMENT OF TRANSPORTATION
 HORIZONTAL CONTROL, RECOVERY AND RETRACEMENT MAP
 OR 138 @ WINCHESTER SIGNALS
 NORTH UMPQUA HIGHWAY (HWY 73)
 DOUGLAS COUNTY
 DECEMBER 3, 2003 FOR ODOT REGION 3
 3500 N.W. STEWERT ST., ROSEBURG, OREGON 97470
 SCALE: 1" = 100' SHEET 1 OF 3

ST. HWY. 138-006A