

Found 2-3/4" Brass Cap set in concrete stamped:

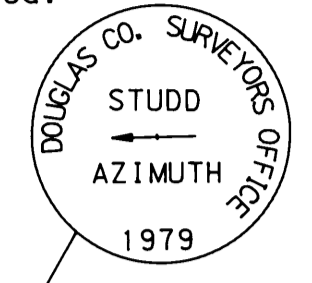

SCALE : 1" = 100'

OREGON DEPARTMENT OF TRANSPORTATION  
 3099 NE Diamond Lake Blvd, Roseburg, OR 97470  
**ROSEBURG EAST CITY LIMITS  
 TO DIXONVILLE INTERSECTION**  
 HORIZONTAL CONTROL MAP  
 Located in the SE1/4 and SW1/4 of Sec 15,  
 the SE1/4 and SW1/4 of Sec 16, the NE1/4  
 of Sec 20, the NW1/4 of Sec 21, the NE1/4  
 of Sec 22, and the NW1/4 of Sec 23,  
 T27S, R5W, WM  
 County: Douglas Highway: North Umpqua  
 EA: 00101402 Key #: 05048  
 Designer: Dave Collier Coordinates Assumed  
 Basis of Bearings: Preliminary R/W Map 98-36-13  
 Project Manager: Roger Pattiz, LS 906  
 Scale: 1" = 100' September 1993

**LEGEND:**  
 ▲ Set 1/2"x30" I.R. w/1-1/2" Alum. cap stamped  
 "OSHD HORIZ CONTROL (Pt. #)".  
 ○ Found Monument as noted (see table).  
 — Control Traverse  
 - - - Existing Edge of Pavement

**COUNTY SURVEYORS FILE DATA  
 DO NOT REMOVE FROM OFFICE**