

SECTION 11, T.28S., R.6W., W.M. SE1/4 SECTION 10, T.28S., R.6W., W.M. SECTION 15, T.28S., R.6W., W.M.
 SE1/4 SECTION 16, T.28S., R.6W., W.M. SECTION 21, T.28S., R.6W., W.M. SE1/4 SECTION 20, T.28S., R.6W., W.M.

FILED

Date: 10-31-2024 By: [Signature]
 This survey consist of:
 Map: ST. HWY 42-022 A-G
 Narrative:
 Corner Rpt: DOUGLAS COUNTY SURVEYOR

LEGEND	
★	SET GPS STATION
☆	FOUND GPS STATION
▲	SET NETWORK POINT
△	FOUND NETWORK POINT
◆	SET STRATEGIC POINT
★---☆	LINES OF OBSERVATION (GPS)
▲---▲	LINES OF OBSERVATION (TERRESTRIAL)

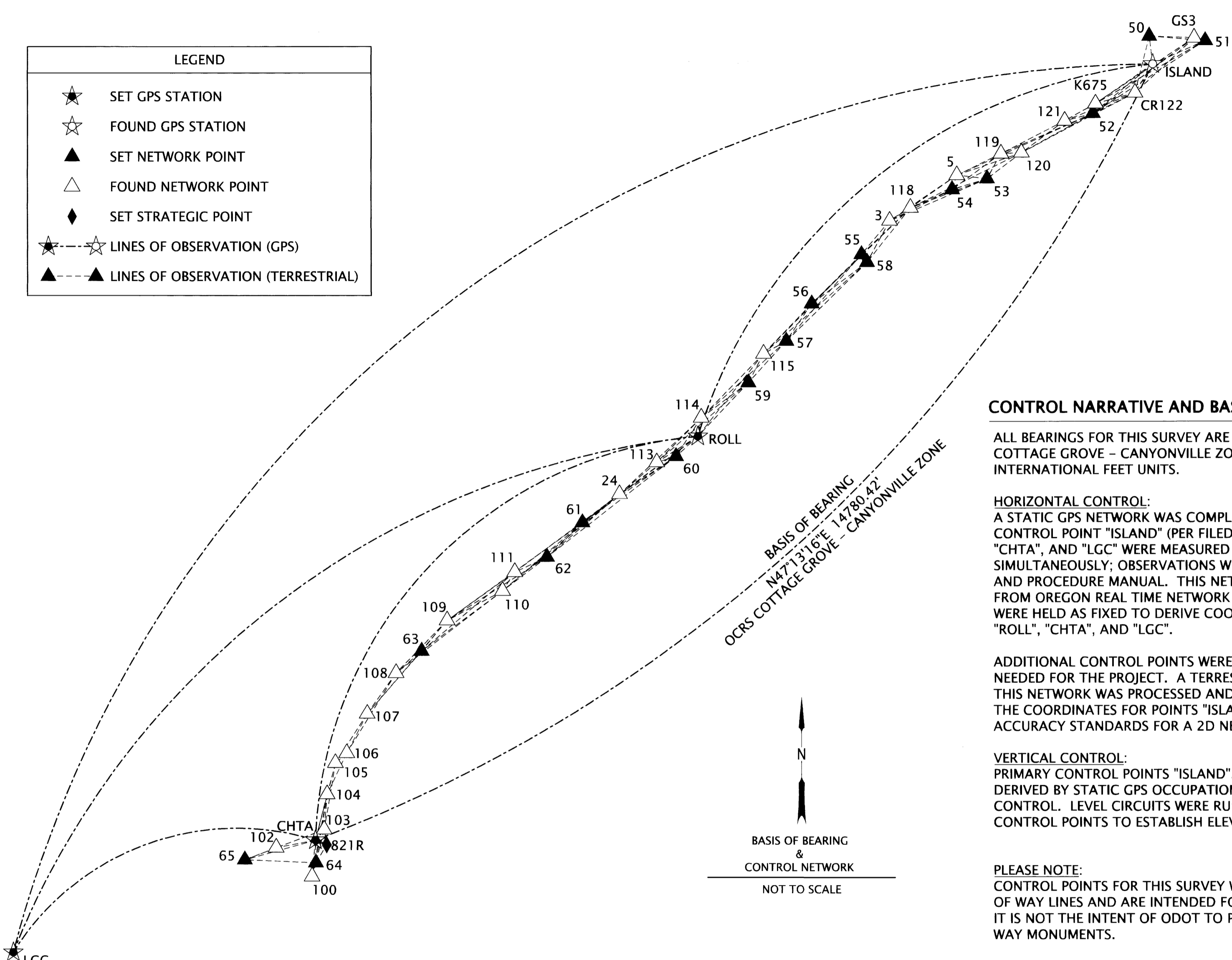

CONTROL NARRATIVE AND BASIS OF BEARINGS

ALL BEARINGS FOR THIS SURVEY ARE BASED ON THE OREGON COORDINATE REFERENCE SYSTEM (OCRS), COTTAGE GROVE - CANYONVILLE ZONE, NAD 83(2011) EPOCH 2010. ALL COORDINATES ARE IN INTERNATIONAL FEET UNITS.

HORIZONTAL CONTROL:
 A STATIC GPS NETWORK WAS COMPLETED AND USED AS PRIMARY CONTROL FOR THE PROJECT. FOUND CONTROL POINT "ISLAND" (PER FILED SURVEY ST. HWY. 42-007) AND SET CONTROL POINTS "ROLL", "CHTA", AND "LGC" WERE MEASURED UTILIZING 2 REDUNDANT 2 HOUR STATIC OCCUPATIONS SIMULTANEOUSLY; OBSERVATIONS WERE SEPARATED BY AT LEAST 45 MINUTES PER ODOT'S SURVEY POLICY AND PROCEDURE MANUAL. THIS NETWORK WAS PROCESSED UTILIZING DOWNLOADED RINEX FILES FROM OREGON REAL TIME NETWORK (ORGN) STATIONS "CABL", "PSPT", AND "YONC". THESE ORGN STATIONS WERE HELD AS FIXED TO DERIVE COORDINATES ON THE PRIMARY PROJECT CONTROL POINTS "ISLAND", "ROLL", "CHTA", AND "LGC".

ADDITIONAL CONTROL POINTS WERE FOUND (PER FILED SURVEY ST. HWY. 42-007) AND SET WHERE NEEDED FOR THE PROJECT. A TERRESTRIAL NETWORK WAS THEN RAN THROUGH ALL CONTROL POINTS. THIS NETWORK WAS PROCESSED AND ADJUSTED UTILIZING A 2D LEAST SQUARE ADJUSTMENT HOLDING THE COORDINATES FOR POINTS "ISLAND", "ROLL", AND "CHTA" AS FIXED. THE ADJUSTMENT PASSED THE ACCURACY STANDARDS FOR A 2D NETWORK PER ODOT'S SURVEY POLICY AND PROCEDURE MANUAL.

VERTICAL CONTROL:
 PRIMARY CONTROL POINTS "ISLAND", "ROLL", AND "CHTA" AND THEIR NAVD88 DATUM ELEVATIONS, DERIVED BY STATIC GPS OCCUPATION DESCRIBED ABOVE AND USING GEOID12A, WERE HELD FOR VERTICAL CONTROL. LEVEL CIRCUITS WERE RUN THROUGH ALL THE CONTROL POINTS BETWEEN THE PRIMARY CONTROL POINTS TO ESTABLISH ELEVATIONS.

PLEASE NOTE:
 CONTROL POINTS FOR THIS SURVEY WERE NOT SET ON AND DO NOT REPRESENT PROPERTY OR RIGHT OF WAY LINES AND ARE INTENDED FOR THE USE BY ODOT IN SUPPORT OF THIS AND FUTURE PROJECTS. IT IS NOT THE INTENT OF ODOT TO PERPETUATE THESE CONTROL POINTS AS PROPERTY OR RIGHT OF WAY MONUMENTS.

CONTROL INFORMATION

SURVEY DATUM- PER OAR 734-005-015 OREGON COORDINATE REFERENCE SYSTEM (OCRS): COTTAGE GROVE - CANYONVILLE ZONE NAD83(2011) EPOCH 2010 (INTERNATIONAL FEET)

EQUIPMENT- THE FIELD WORK FOR THIS PROJECT WAS INITIATED IN MAY OF 2022 AND CARRIED ON INTERMITTENTLY THROUGH SEPTEMBER OF 2024. 2 LEICA GX1230 GNSS RECEIVERS, 2 LEICA GS14 GNSS RECEIVERS, 1 LEICA GS18T GNSS RECEIVER, 1 LEICA MS50 TOTAL STATION, 1 LEICA TS16 TOTAL STATION, 2 LEICA CS20 DATA COLLECTORS AND 1 LEICA DNA10 DIGITAL LEVEL WERE UTILIZED TO PERFORM THE FIELD WORK.

REGISTERED PROFESSIONAL LAND SURVEYOR
 Eric P. Hibbs
 OREGON NOVEMBER 13, 2018 ERIC BENJAMIN HIBBS 90437PLS
 RENEWS: 06/30/2025

OREGON DEPARTMENT OF TRANSPORTATION
 HORIZONTAL CONTROL, RECOVERY AND RETRACEMENT MAP
 OR42: LOOKINGGLASS CREEK
 TO I-5 (WINSTON) SECTION
 COOS BAY - ROSEBURG HIGHWAY
 DOUGLAS COUNTY

ODOT REGION 3 TECH CENTER
 3500 NW STEWART PKWY.
 ROSEBURG, OR 97470 KEY NO. K21677

OCTOBER 30, 2024
 SCALE: NTS
 SHEET 2 OF 7