

SEC. 13, T. 22 S., R. 10 W., AND
SEC. 7, 8, & 18, T. 22 S., R. 9 W., W.M.

FILED

Date: 3/12/2001 By: JP
This survey consists of: 13 PAGES
Map: ST HWY 38-009B
Narrative: _____
Corner Rpt: _____

DOUGLAS COUNTY
SURVEYOR

PRIMARY TRAVERSE #1 (MAY 1991)

AT	TO	DISTANCE	BEARING
2	3	189.456 M	N 73°06'23" E
3	4	285.246 M	N 76°15'50" E
4	5	454.584 M	N 61°13'10" E
5	6	379.121 M	S 68°09'17" E
6	7	241.615 M	S 87°52'46" E
7	8	139.685 M	N 57°42'31" E
8	9	279.011 M	N 26°03'50" E
9	10	517.106 M	N 10°12'40" E
10	11	429.865 M	N 5°11'20" E
11	12	261.425 M	N 25°28'49" W
12	13	201.027 M	N 11°25'38" E
13	14	262.545 M	N 21°54'06" E
14	15	299.873 M	N 43°35'33" E
15	16	415.287 M	N 67°14'41" E
16	17	514.161 M	N 88°49'08" E
17	18	250.717 M	S 51°05'28" E
18	19	322.295 M	S 24°07'59" E
19	20	298.142 M	S 85°26'58" W
20	21	81.955 M	S 65°27'39" W
21	22	129.814 M	S 60°15'58" W
22	23	235.062 M	S 66°18'30" W
23	24	124.694 M	N 72°54'40" W
24	25	115.741 M	N 84°18'22" W
25	26	169.635 M	S 61°08'36" W
26	27	119.082 M	S 30°14'39" W
27	28	212.957 M	S 0°23'32" W
28	29	135.311 M	S 20°17'27" E
29	30	241.364 M	S 3°09'19" E
30	31	264.986 M	S 4°03'01" E
31	32	154.620 M	S 45°00'48" W
32	33	287.414 M	S 17°56'12" W
33	34	214.766 M	S 4°57'44" W
34	35	145.996 M	S 51°09'22" W
35	36	198.554 M	S 41°35'57" W
36	37	184.941 M	S 65°32'18" W
37	38	164.190 M	S 74°26'35" W
38	39	179.048 M	N 89°33'33" W
39	40	284.401 M	N 70°42'22" W
40	41	143.523 M	N 65°22'43" W
41	42	558.044 M	N 57°11'39" W
42	1	373.050 M	S 35°04'58" W
1	2	174.364 M	S 68°30'40" W

SECONDARY TRAVERSE #6 (JUNE 1992)

AT	TO	DISTANCE	BEARING
8	75	38.290 M	N 34°49'34" E
75	76	134.132 M	N 28°05'00" E
76	77	57.317 M	N 22°26'24" E
77	8	218.226 M	S 27°47'53" W

SECONDARY TRAVERSE #7 (JULY 1992)

AT	TO	DISTANCE	BEARING
10	80	403.300 M	S 9°59'51" W
80	81	212.829 M	N 9°19'7" E
81	82	385.735 M	N 9°14'13" E
82	83	123.959 M	N 10°36'26" E
83	84	77.758 M	S 46°09'35" E
84	85	101.249 M	N 39°59'24" W
85	10	341.505 M	S 6°45'36" W

NETWORK POINT CONFIDENCE
LEVEL LIMITS (MAY 2000)

POINT	SEMI MAJOR	SEMI MINOR	ORIENTATION
200	0.008 M	0.004 M	S 1°5'32" E
201	0.007 M	0.003 M	S 3°44'18" E
202	0.008 M	0.003 M	S 16°41'43" E
203	0.017 M	0.004 M	S 20°59'43" E
204	0.021 M	0.004 M	S 21°12'15" E
205	0.005 M	0.003 M	N 66°04'24" E
206	0.020 M	0.004 M	N 77°16'39" E
207	0.032 M	0.004 M	N 76°56'00" E
208	0.049 M	0.006 M	N 74°33'58" E
209	0.004 M	0.003 M	N 45°30'07" E

CONTROL TRAVERSE AND NETWORK DIAGRAM
NOT TO SCALE

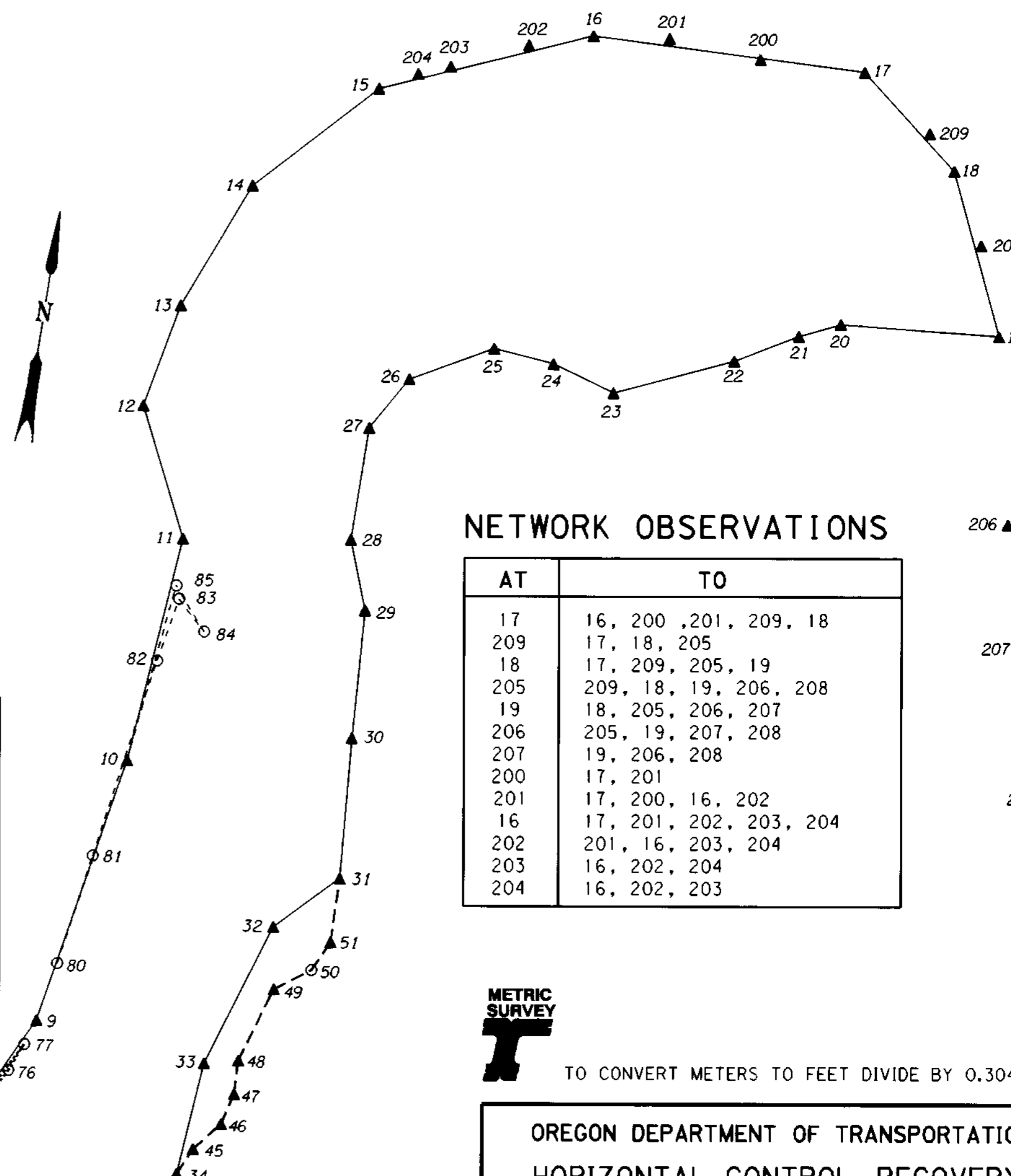

NETWORK OBSERVATIONS

AT	TO
17	16, 200, 201, 209, 18
209	17, 18, 205
18	17, 209, 205, 19
205	209, 18, 19, 206, 208
19	18, 205, 206, 207
206	205, 19, 207, 208
207	19, 206, 208
200	17, 201
201	17, 200, 16, 202
16	17, 201, 202, 203, 204
202	201, 16, 203, 204
203	16, 202, 204
204	16, 202, 203

SECONDARY TRAVERSE #2 (JUNE 1991)

AT	TO	DISTANCE	BEARING
34	45	55.815 M	N 24°38'27" E
45	46	71.200 M	N 39°02'26" E
46	47	62.024 M	N 14°37'26" E
47	48	63.327 M	N 1°57'45" W
48	49	149.628 M	N 17°24'11" E
49	50	79.145 M	N 54°18'45" E
50	51	63.797 M	N 25°30'31" E
51	31	120.860 M	N 0°47'28" W

SECONDARY TRAVERSE #5 (APRIL 1992)

AT	TO	DISTANCE	BEARING
5	68	264.699 M	S 17°58'32" W
68	69	308.788 M	N 80°24'13" W
69	70	307.772 M	N 40°29'37" E
70	71	124.067 M	S 89°59'06" E
71	72	425.942 M	S 67°08'26" E
72	5	355.565 M	N 68°15'06" W

LEGEND

- ▲ SET MONUMENT
- FOUND MONUMENT
- PRIMARY TRAVERSE #1
- - - SECONDARY TRAVERSE #2
- · - · SECONDARY TRAVERSE #5
- · · · SECONDARY TRAVERSE #6
- - - - SECONDARY TRAVERSE #7



TO CONVERT METERS TO FEET DIVIDE BY 0.3048

REGISTERED
PROFESSIONAL
LAND SURVEYOR
Christine V. Blawie
OREGON
JULY 18, 1994
CHRISTINE V. BLAWIE
2000
EXPIRES: DEC. 31, 2001

OREGON DEPARTMENT OF TRANSPORTATION
HORIZONTAL CONTROL, RECOVERY,
AND RETRACEMENT MAP
SCOTTSBURG - WELLS CREEK SECTION
UMPQUA HIGHWAY
DOUGLAS COUNTY
3500 STEWART PARKWAY, SUITE 140
ROSEBURG, OREGON 97470

MARCH 12, 2001
PROJECT KEY #09075