

1/4 S  
S88°58'44.2"E, 5280.25 (1609.420 m.), USGLO record, S89°47'E, 5306.40

2640.13 (804.712 m.)  
(USGLO record, 2653.2)

2640.12 (804.709 m.)  
(USGLO record, 2653.2)

Fd. brass cap mkd.  
County Surveyor's Office  
T31S, R6W  
S8, S9, S17, S16  
1964  
From which a:  
39" Douglas fir original BT  
Bears N72°E, 20.5 ft.  
30" Douglas fir BT stump  
Bears S69°W, 60.6 ft.  
10" madrone BT  
Bears S43 1/2°E, 48.8 ft.  
20" incense cedar BT  
Bears N16°W, 56.4 ft.

Set brass cap mkd.  
T31S, R6W, W. M.  
1/4 S S9, S16  
RLS 430 1980  
From which a:  
40" Douglas fir, 1 scribed  
"1/4 S S9 BT"  
Bears N59°W, 16.0 ft.  
5" madrone, 1 scribed  
"1/4 S S16 BT"  
Bears S6°W, 21.4 ft.  
42" Douglas fir, 1 scribed  
"1/4 S S16 BT"  
Bears S26°E, 18.4 ft.

Fd. brass cap mkd.  
County Surveyor's Office  
T31S, R6W  
S9, S10, S16, S15  
1970  
From which a:  
12" yew original BT  
Windfall with face  
Bears N73°W, 21.1 ft.  
48" Douglas fir BT  
Bears S11°E, 96.7 ft.  
8" alder BT  
Bears N85°E, 10.5 ft.  
40" Douglas fir BT  
Bears S67°W, 10.0 ft.  
18" yew BT  
Bears N14°W, 59.2 ft.  
Corner falls along side  
of main fork Catching Cr.

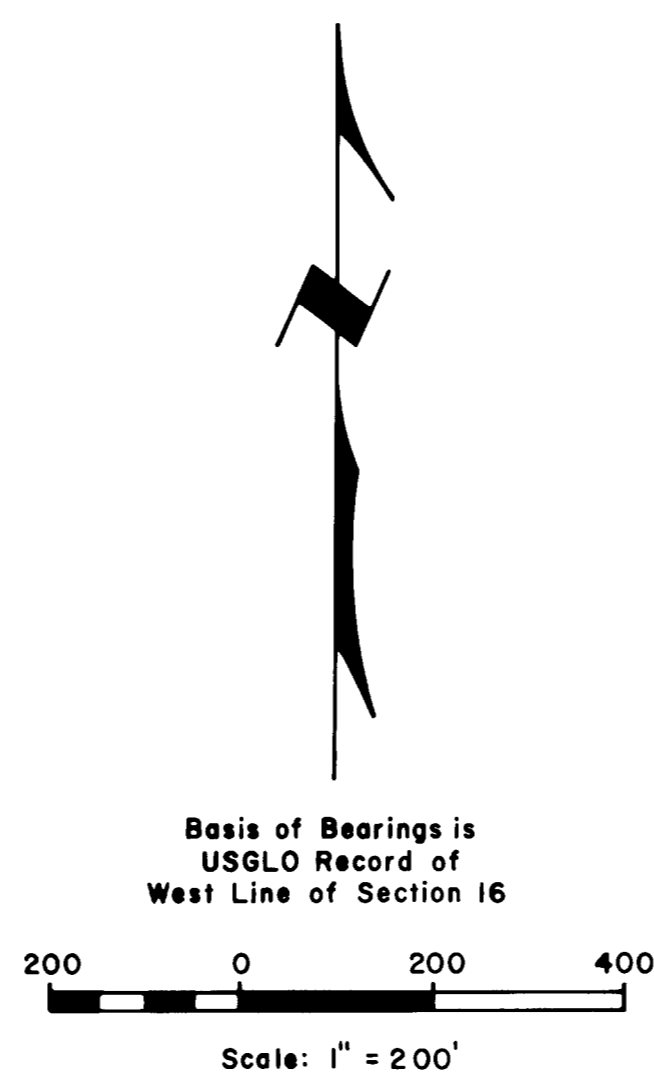

Basis of Bearings is  
USGLO Record of  
West Line of Section 16

LEGEND

- Corner found
- Corner set
- True line marked with blazes and yellow paint
- Line traversed, not marked

PROPERTY LINE SURVEY IN SECTION 16,  
T 31 S, R 6 W, W. M., DOUGLAS COUNTY,  
OREGON

For: C & D Lumber Co.  
Riddle, Oregon 97469  
By: Shaner Engineering, Inc.  
P. O. Box 1430  
Roseburg, Oregon 97470

June 3, 1980

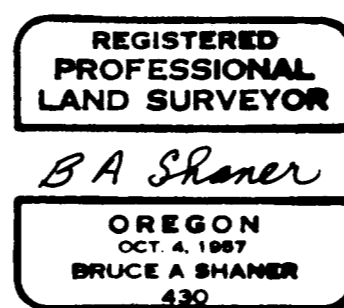

S89°16'55.1"W, 5321.81 (1622.088 m.)  
(USGLO record, S89°50'W, 5326.0)

2639.21 (804.431 m.)  
(USGLO record, 2640.0)

2639.22 (804.434 m.)  
(USGLO record, 2640.0)

50°49'07.7"W, 2568.09 (782.784 m.)  
(USGLO record, South, 2640.0)

S145°03'E, 2551.04 (777.557 m.)  
(USGLO record, South, 2640.0)

Set brass cap mkd.  
T31S, R6W, W. M.  
1/4 S S17, S16  
RLS 430 1980  
From which a:  
6" Douglas fir, 1 scribed  
"1/4 S S16 BT"  
Bears S78°E, 10.9 ft.  
6" Douglas fir, 1 scribed  
"1/4 S S17 BT"  
Bears N88°W, 16.2 ft.  
The brass cap falls snugly  
up against a 6" Douglas fir stump.

Fd. brass cap mkd.  
County Surveyor's Office  
T31S, R6W  
17, 16, 20, 21  
1964  
From which a:  
17" madrone original BT  
With face  
Bears N50°E, 28.0 ft.  
(Record, 30.4 ft.)  
12" madrone original BT stump  
Bears S51°E, 42.2 ft.  
30" madrone original BT  
With face  
Bears S40°W, 72.4 ft.  
(Record, 68.0 ft.)  
27" madrone original BT  
With face  
Bears N54°W, 66.8 ft.  
(Record, N60°W, 69.3 ft.)  
6" Douglas fir BT  
With face  
Bears S46°E, 36.3 ft.

Set brass cap mkd.  
T31S, R6W, W. M.  
1/4 S S16, S15  
RLS 430 1980  
From which a:  
28" Douglas fir original BT  
Bark scribe vis., 1 bark rescribe  
"1/4 S S16 BT"  
Bears S18°W, 19.8 ft. to face  
36" Douglas fir original BT  
Snag, no marks vis.  
Bears N20°E, 32.3 ft. to face  
30" Douglas fir, 1 bark scribed  
"1/4 S S15 BT"  
Bears S8°E, 28.8 ft. to center

Fd. 38" Douglas fir snag  
Original corner tree  
From which a:  
30" Douglas fir original BT  
Snag, no marks  
Bears N57°W, 14.0 ft. to face  
48" Douglas fir original BT  
Snag, no marks  
Bears S35°E, 44.2 ft. to face  
8" Douglas fir original BT  
Down snag, scribes vis.  
Bears N36°E, 10.6 ft. to face  
Fd. brass cap witness corner  
Bears West, 4.0 ft. mkd.  
County Surveyor's Office  
T31S, R6W  
WC 4 ft. E  
S16, S15, S21, S22 1964  
From which a:  
3" Douglas fir BT now down  
Bears N6°E, 4.0 ft.  
4" Douglas fir BT now down  
Bears S58°E, 14.3 ft.  
10" Douglas fir BT with face  
Bears S10°W, 23.4 ft.  
10" Douglas fir, 1 scribed  
"T31S R6W WC S16 BT"  
Bears N48°W, 4.1 ft.  
10" Douglas fir, 1 scribed  
"T31S R6W WC S15 BT"  
Bears N26°E, 18.0 ft.  
8" Douglas fir, 1 scribed  
"T31S R6W WC S22 BT"  
Bears S58°E, 9.8 ft.  
Corner lies 60.0 ft. East from top  
of ridge and main access road.

26-6 MR

MAP FILE 203-32

203-32