

# TAFT HEIGHTS PHASE 3B

## GENERAL STREET IMPROVEMENT NOTES

- ALL STREET IMPROVEMENT WORK SHALL BE IN CONFORMANCE WITH THE LATEST VERSION OF CITY OF ROSEBURG DOUGLAS COUNTY DRAINAGE MANAGEMENT PLAN DESIGN STANDARDS AND ADDENDUM DATED MAY 1990 AND DOUGLAS COUNTY PUBLIC WORKS DEPARTMENT DESIGN STANDARDS AND STANDARD DRAWINGS. IN CASES OF CONFLICT THE DOUGLAS COUNTY STANDARDS SHALL TAKE PRECEDENCE OVER THE STANDARD SPECIFICATIONS.
- ALL TRENCHES IN DOUGLAS COUNTY ROADWAYS SHALL BE BACK FILL WITH SAND SLURRY.
- ALL ASPHALT PAVEMENT SHALL BE "C" MIX MEETING OREGON STATE HIGHWAY DEPARTMENT STANDARDS.
- TWO CURB WEEP HOLES PER LOT SHALL BE PROVIDED AT EITHER END OF FRONTAGE OR AS DESIGNATED BY THE ENGINEER.
- CONTRACTOR TO INSTALL SIDEWALK ACCESS RAMPS (SAR) PER STANDARD DRAWING. RAMPS SHALL BE POURED MONOLITHICALLY WITH CURB.
- ENGINEER AND CITY TO BE NOTIFIED FOR INSPECTION AS SHOWN ON SCHEDULE OR AS SPECIFIED IN "GENERAL NOTES" FOR THAT SPECIFIC CONSTRUCTION ITEM.

## INSPECTION SCHEDULE

- THE ENGINEER SHALL BE NOTIFIED FOR INSPECTION AT LEAST 24 HOURS PRIOR TO THE ACCOMPLISHMENT OF THE FOLLOWING STAGES OF CONSTRUCTION. PHONE: 673-0166 FAX: 440-9392.
- ANY STORM SEWER CONSTRUCTION (INCLUDING STRUCTURES)
  - FINISH SUB-GRADE. (PRIOR TO FABRIC INSTALLATION)
  - SOIL STABILIZATION FABRIC INSTALLATION
  - ANY CONCRETE WORK
  - FINISH BASE COURSE GRADE
  - PAVING
- NONE OF THE ABOVE ITEMS OF WORK SHALL BE COVERED UNTIL INSPECTED BY THE ENGINEER.

## GENERAL NOTES

- THE 2002 EDITION OF THE STANDARD SPECIFICATIONS FOR CONSTRUCTION PREPARED BY THE OREGON DEPARTMENT OF TRANSPORTATION AND THE AMERICAN PUBLIC WORKS ASSOCIATION OREGON CHAPTER WILL BE CONSIDERED THE STANDARD SPECIFICATIONS
- TRENCH BACK FILL SHALL BE CLASS B (3/4"-0" CRUSHED ROCK) WITHIN ALL STREET RIGHT OF WAYS AND UNDER ALL PARKING LOTS., AND CLASS A (SUITABLE EXCAVATED MATERIAL) ELSEWHERE, UNLESS SHOWN DIFFERENT ON TRENCH DETAIL OR IN SPECIFICATIONS. ALL TRENCHES WILL BE COMPACTED WITH HAND-OPERATED PNEUMATIC COMPACTOR.
- THE CONTRACTOR SHALL REPLACE ANY AND ALL SURVEY MONUMENTS WHICH ARE AFFECTED BY THE CONSTRUCTION. ALL MONUMENTS WILL BE RESET BY A LICENSED LAND SURVEYOR.
- LOCATIONS SHOWN ON ENGINEERING DRAWINGS ARE APPROXIMATE. THE EXACT LOCATION WILL BE STAKED IN THE FIELD BY THE ENGINEER. CONTRACTOR TO GIVE SEVEN (7) DAYS NOTICE TO ENGINEER FOR STAKES.
- CONTRACTOR SHALL MAINTAIN A MINIMUM HORIZONTAL SEPARATION OF TEN (10) FEET BETWEEN WATER MAINS AND SEWER MAINS MEASURED EDGE TO EDGE.
- INSULATED COPPER TONING WIRE APPROVED FOR DIRECT BURY SHALL BE PLACED IN ALL TRENCHES WHERE PIPE HAS BEEN LAID. ALL TONE WIRE SHALL BE TESTED PRIOR TO ACCEPTANCE.
- THE CONTRACTOR SHALL NOTIFY ALL AFFECTED UTILITY COMPANIES FOR LOCATIONS OF MAINLINE AND SERVICE LINE LOCATIONS PRIOR TO DIGGING. CONTRACTOR TO CONTACT ONE-CALL AT LEAST 48 HOURS PRIOR TO CONSTRUCTION AT 1-800-332-2344.  
ATTENTION:  
OREGON LAW REQUIRES YOU TO FOLLOW RULES ADOPTED BY THE OREGON UTILITY NOTIFICATION CENTER. THOSE RULES ARE SET FORTH IN THE OAR 952-001-0010 THROUGH OAR 952-001-0090, AND OREGON LAWS 1995, CHAPTER 691, SECTION 7. YOU MAY OBTAIN COPIES OF THE RULES BY CALLING THE CENTER.
- ENGINEER AND CITY TO BE NOTIFIED FOR INSPECTION AS SHOWN ON SCHEDULE OR AS SPECIFIED IN "GENERAL NOTES" FOR THAT SPECIFIC CONSTRUCTION ITEM.
- CONTRACTOR TO FIELD VERIFY TYPE, LOCATION, AND ELEVATIONS OF EXISTING UNDERGROUND UTILITIES PRIOR TO INSTALLATION OF NEW PIPING.
- CONTRACTOR RESPONSIBLE FOR OBTAINING ALL REQUIRED PERMITS FOR WORKING IN PUBLIC RIGHT OF WAYS. (i.e. ODOT, CITY, COUNTY).
- COMPACTION TESTS SHALL BE REQUIRED ON ALL MAINLINE TRENCHES AND ON SUB GRADE MATERIAL. ALL TESTING SHALL BE AT THE APPLICANT/DEVELOPER'S COST.
- STANDARD DRAWINGS SHOWN ON PLANS ARE SUBJECT TO CHANGE WITHOUT NOTIFICATION. CONTRACTOR TO VERIFY WITH AGENCY PRIOR TO CONSTRUCTION.
- A PRE CONSTRUCTION CONFERENCE WITH THE CITY AND ALL INTERESTED PARTIES SHALL BE HELD PRIOR TO ANY CONSTRUCTION.

## GENERAL SANITARY SEWER NOTES

- ALL SANITARY SEWER WORK SHALL BE IN CONFORMANCE WITH ROSEBURG URBAN SANITARY AUTHORITY SPECIFICATIONS AND ORDINANCE. IN CASES OF CONFLICT ROSEBURG URBAN SANITARY AUTHORITY SPECIFICATIONS SHALL TAKE PRECEDENCE OVER THE STANDARD SPECIFICATIONS.
- SANITARY SEWER PIPE SHALL BE AS NOTED ON PLANS OR AS APPROVED BY ENGINEER. STANDARD GRAVITY SANITARY SEWER PIPE SHALL BE PVC PIPE CONFORMING TO ASTM D 3034 SDR 35 STANDARDS.
- ALL GRAVITY SANITARY SEWER MAINLINES AND LATERALS SHALL BE AIR TESTED IN ACCORDANCE WITH STANDARD SPECIFICATIONS, UNIBELL B-06.85, AFTER COMPACTION OF BACK FILL.
- SANITARY SEWER LATERALS FROM THE BUILDING TO THE SEWER MAIN SHALL BE CONSTRUCTED IN ACCORDANCE WITH OREGON STATE DEPARTMENT OF COMMERCE, BUILDING CODES DIVISION, 1994 UNIFORM PLUMBING CODE AND ITS AMENDMENTS, EXCEPT FOR 8" AND LARGER PUBLIC SEWERS WHICH SHALL BE CONSTRUCTED IN ACCORDANCE WITH DEQ STANDARDS FOR PUBLIC SEWERS AND TO THE LINES, GRADES AND DETAILS SHOWN ON THE PLANS. 4" AND 6" LATERALS SHALL BE PVC ASTM 3034. ALL LINES SHALL HAVE TONING WIRE INSTALLED IN THE TRENCH FOR FUTURE LOCATING.
- ALL MANHOLE CONNECTIONS TO BE FACTORY CONNECTORS WITH NON-SHRINK GROUT OR A CORED HOLE WITH FLEXIBLE BOOT. I.E.: KOR-N-SEAL. CONNECTIONS TO EXISTING MANHOLES SHALL BE CORED OR SAW CUT.
- CONTRACTOR TO PROVIDE PREFORMED PLASTIC GASKETS IN ALL MANHOLE JOINTS.
- GROUT FOR TOP OF MANHOLE FRAMES AND BASES SHALL BE NON-SHRINK GROUT.
- A COMMERCIAL CONCRETE BONDING AGENT SHALL BE USED ON ALL CONCRETE TO BE GROUTED.
- CONCRETE SHALL BE CLASS 5 (1-1/2" MAX. AGGREGATE SIZE) WITH 6 SACKS OF CEMENT PER CUBIC YARD OF CONCRETE, WITH A MINIMUM COMPRESSIVE STRENGTH OF NOT LESS THAN 3,000 PSI AT 28 DAYS WHEN TESTED IN ACCORDANCE WITH ASTM C-39.86.
- WHEREVER SEWER MAINS CROSS WATER LINES WITH LESS THAN 18" VERTICAL CLEARANCE, THE SEWER MAIN SHALL BE C900 PVC OR DUCTILE IRON PIPE FOR THE ENTIRE DISTANCE BETWEEN MANHOLES. WHEREVER SEWER LATERALS CROSS WATER LINES WITH LESS THAN 18" VERTICAL CLEARANCE, THE SEWER LATERAL SHALL BE C900 PVC OR DUCTILE IRON PIPE FOR A MINIMUM DISTANCE OF 9' ON EACH SIDE OF THE WATERLINE. A MIN. OF 10' HORIZONTAL SEPARATION SHALL BE MAINTAINED BETWEEN SEWER & WATER MAINS.
- MANHOLES WILL BE TESTED ACCORDING TO 1990 APWA STANDARD SPECIFICATION 306.3.03. WATER TO BE FILLED TO THE RIM. CONTRACTOR MAY VACUUM TEST MANHOLES WITH ENGINEER'S APPROVAL.
- ALL MANHOLES SHALL BE 48" DIAMETER WITH CONCENTRIC CONES.
- NO FLAT-TOP MANHOLES TO BE USED WITHOUT ROSEBURG URBAN SANITARY AUTHORITY'S PRIOR APPROVAL.
- 12-GAGE STRANDED COPPER TONING WIRE WITH GREEN THHN INSULATION SHALL BE PLACED IN ALL TRENCHES WHERE SEWER LINE HAS BEEN LAID. ALL TONING WIRE SHALL BE TESTED PRIOR TO ACCEPTANCE.
- DEFLECTION TESTING SHALL BE CONDUCTED ON ALL SEWERS CONSTRUCTED OF FLEXIBLE PIPE NOT LESS THAN 30 DAYS AFTER TRENCH BACK FILL AND COMPACTION. TESTING WILL CONFORM TO APWA SECTION 303.3.10.
- LINE AND GRADE SHALL BE MAINTAINED AS SHOWN ON THE PLANS OR AS ESTABLISHED BY THE ENGINEER. VARIATIONS OF MORE THAN 1/2 INCH FOR LINE AND 1/4 INCH FOR GRADE WILL NOT BE PERMITTED.
- ALL MANHOLES WILL NEED A FLEXIBLE JOINT WITHIN 1.5 FT. OF MANHOLE WALL.
- ALL TESTING SHALL BE WITNESSED BY A RUSA INSPECTOR. PRIOR NOTICE OF AT LEAST FOUR (4) HOURS SHALL BE GIVEN TO RUSA INSPECTOR PRIOR TO TESTING.

## GENERAL WATER NOTES

- ALL WATER SYSTEM WORK SHALL BE IN CONFORMANCE WITH SECTIONS 2, 3 & 4 OF THE CITY OF ROSEBURG "GENERAL SPECIFICATIONS... MATERIALS AND INSTALLATION OF WATER MAINS" CURRENT EDITION, AVAILABLE FROM THE CITY OF ROSEBURG WATER DEPARTMENT. IN CASES OF CONFLICT THE CITY OF ROSEBURG SPECIFICATIONS SHALL TAKE PRECEDENCE OVER THE STANDARD SPECIFICATIONS.
- ALL PIPE FOR WATER MAINLINES SHALL BE CLASS 50 DUCTILE IRON (DI) PIPE, EXCEPT 4" WHICH SHALL BE CLASS 52 AND 6" WHICH SHALL BE CLASS 51.
- THE CONTRACTOR SHALL FLUSH, HYDROSTATICALLY TEST, AND CHLORINATE ALL NEW WATER MAINLINES INSTALLED. THE ENGINEER SHALL WITNESS ALL TESTS MADE BY THE CONTRACTOR TO INSURE THEY ARE PERFORMED PROPERLY. TEST PRESSURES SHALL BE DETERMINED BY THE ENGINEER PRIOR TO TESTING.
- ALL CONSTRUCTION & TESTING IS SUBJECT TO INSPECTION BY THE CITY OF ROSEBURG WATER DEPARTMENT AND THE ENGINEER. THE CONTRACTOR SHALL GIVE THE CITY AND THE ENGINEER 48 HOURS NOTICE PRIOR TO BEGINNING CONSTRUCTION AND 24 HOURS NOTICE PRIOR TO TESTING.
- NO OTHER MAJOR UTILITIES SHALL RUN PARALLEL WITHIN THREE (3) FEET OF THE NEW WATER MAIN.
- THRUST BLOCKS SHALL BE INSTALLED AT ALL BENDS AND FITTINGS AS PER CITY OF ROSEBURG STANDARD DRAWING NO. 102.
- SERVICE WORK SHALL BE PROVIDED BY THE CONTRACTOR. FOR STANDARD SERVICE CONNECTION SEE CITY STANDARD DRAWING 108A.
- ALL CITY WATER FACILITIES OUTSIDE RIGHT-OF-WAYS SHALL BE WITHIN EASEMENTS.
- THE CITY OF ROSEBURG SHALL BE THE SOLE OPERATOR OF ALL WATERLINE VALVES ON THE EXISTING WATER SYSTEM. AT NO TIME SHALL THE CONTRACTOR OPERATE EXISTING VALVES TO SHUT OFF OR PRESSURIZE THE PIPELINE.
- TONING WIRE FOR WATER LINES SHALL BE 12-GAGE STRANDED COPPER WIRE WITH BLUE THHN INSULATION. ALL TONE WIRE SHALL BE TESTED PRIOR TO ACCEPTANCE.

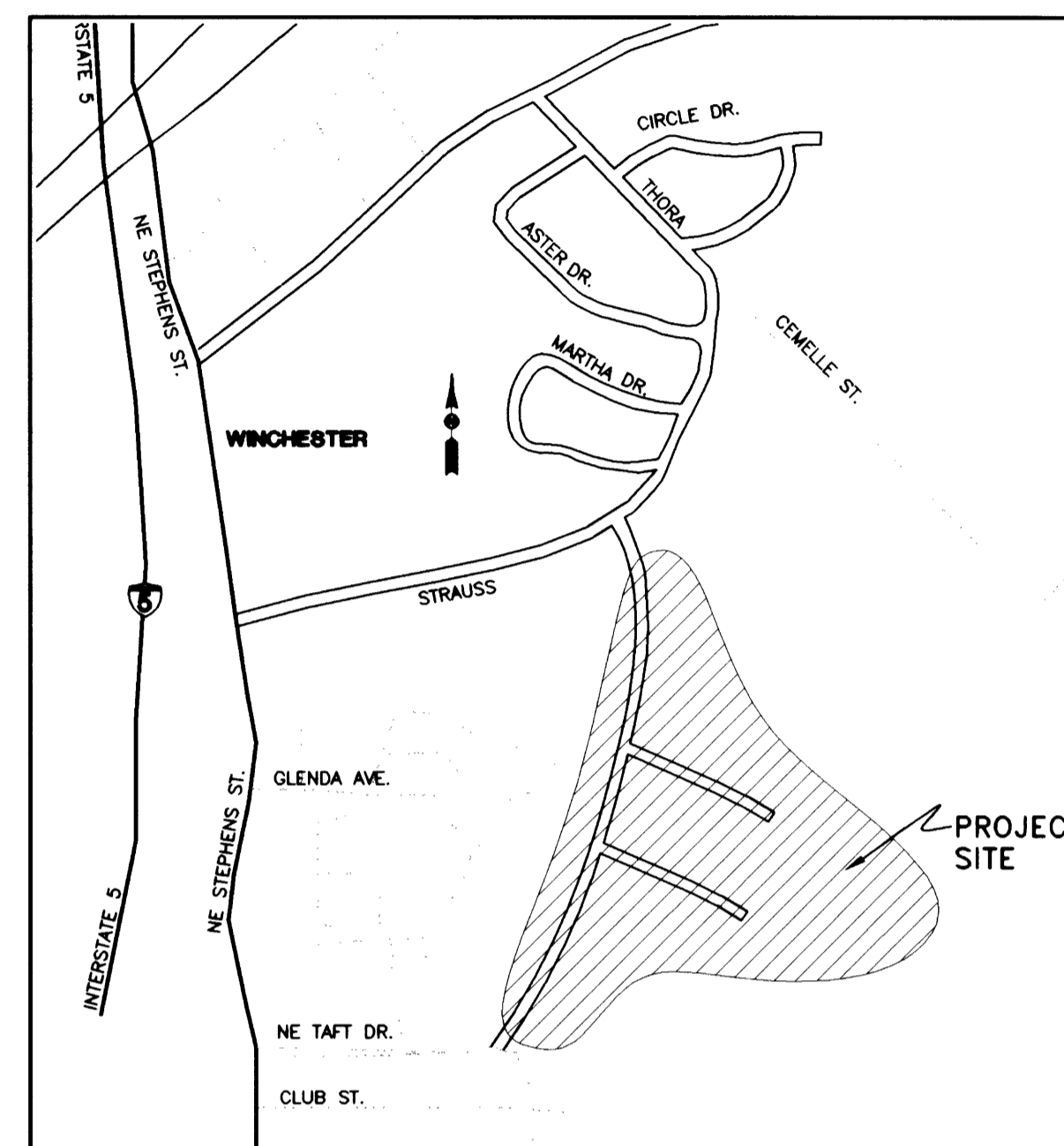

CITY OF ROSEBURG  
 Public Works Dept.  
 Development Plan Review

Approved for Development  Approved with Conditions

By \_\_\_\_\_  
 Date \_\_\_\_\_

## LEGEND

(ELEV.) ELEV.	EXISTING ELEV.	<input type="checkbox"/>	EXISTING CURB INLET (CI)
---	NEW ELEV.	<input type="checkbox"/>	NEW CURB INLET (CI)
---	SAW CUT	<input type="checkbox"/>	EXISTING CATCH BASIN (CB)
---	EXISTING CABLE TV	<input type="checkbox"/>	NEW CATCH BASIN (CB)
---	EXISTING EDGE OF AC OR GRAVEL	<input type="checkbox"/>	CLEAN OUT
---	EXISTING POWER (OVERHEAD)	<input type="checkbox"/>	GUY WIRE
---	EXISTING POWER (UNDERGROUND)	<input type="checkbox"/>	GAS METER
---	NEW UNDERGROUND (TV, POWER, PHONE)	<input type="checkbox"/>	EXISTING FIRE HYDRANT
---	EXISTING GAS	<input type="checkbox"/>	NEW FIRE HYDRANT
---	EXISTING RIGHT-OF-WAY	<input type="checkbox"/>	LANDSCAPING
---	NEW RIGHT-OF-WAY	<input type="checkbox"/>	EXISTING VALVE
---	EXISTING FENCE	<input type="checkbox"/>	NEW VALVE
---	NEW FENCE	<input type="checkbox"/>	EXISTING MANHOLE (MH)
---	EXISTING WATER	<input type="checkbox"/>	NEW MANHOLE (MH)
---	EXISTING WATER MAIN	<input type="checkbox"/>	POWER POLE
---	NEW WATER	<input type="checkbox"/>	PHONE PED
---	EXISTING STORM SEWER (STS)	<input type="checkbox"/>	EXISTING LIGHT POLE
---	NEW STORM SEWER (STS)	<input type="checkbox"/>	NEW LIGHT POLE
---	EXISTING SANITARY SEWER (SS)	<input type="checkbox"/>	MAIL BOX
---	NEW SANITARY SEWER (SS)	<input type="checkbox"/>	EXISTING WATER SERVICE
---	EXISTING PRESSURE SEWER (PS)	<input type="checkbox"/>	NEW WATER SERVICE
---	NEW PRESSURE SEWER (PS)	<input type="checkbox"/>	BLOW OFF
---	EXISTING FORCE MAIN (FM)	<input type="checkbox"/>	CABLE TV PED (TV)
---	NEW FORCE MAIN (FM)		
---	SILT FENCE (S-F)		
---	NEW ELECTRICAL CONDUIT		
---	TOP OF CURB		
---	ASPHALT		
---	BACK OF WALK		
---	FINISH GRADE		
---	FINISH FLOOR		
---	ORIGINAL GROUND		
---	TOP OF WALK		

CALL BEFORE YOU DIG I  
 ONE CALL (800) 332-2344  
 OAR 952-001-0010 THROUGH  
 OAR 952-001-0090

**i.e.** 741 SE Jackson Street  
 Roseburg, Oregon 97470  
 PHONE (541) 673-0166  
 FAX (541) 440-9392  
 iemail@ieengineering.com

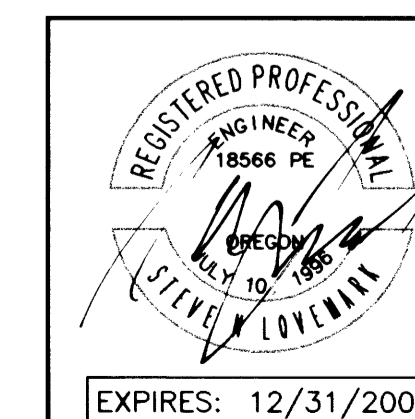

Rev.	Date	Dwg	Description
1	2/21/05	ANV	CITY OF ROSEBURG
2	12/13/05	JDL	AS-BUILT

Project Name: TAFT HEIGHTS PHASE 3B  
 Title: COVER  
 DES DMA PROJECT NO. 1733-06  
 DWG ANV DATE: JANUARY 11, 2004  
 CHK SNL SCALE: AS SHOWN  
 APP SNL SHEET: 1 OF 8

C.R.D. # 908A & 908B

DO NOT DUPLICATE

CO RD #908A & 908B

R908ABC

81