

CATCH BASIN		MANHOLES AND CLEANOUT	
CB1 T/C= 697.53± INV= 694.4	CB5 T/C= 713.98± INV= 709.7	MH1 "DROP" STAT= 7+45.78 RIM= 695.4 INV. OUT= 690.8 INV. IN= 694.2	MH3 STAT= 11+83.62 RIM= 723.8 INV. OUT= 717.4 INV. IN= 717.5
CB2 T/C= 710.77± INV= 707.3	CB18 T/C= 706.86± INV= 702.48	MH2 STAT= 8+77.17 RIM= 711.3 INV. OUT= 704.8 INV. IN= 704.9	MH4 STAT= 11+19.05 RIM= 715.8 INV. OUT= 709.7 INV. IN= 709.9
CB3 T/C= 712.41± INV= 708.2	CB21 T/C= 706.86± INV= 703.56	MH5 STAT= 2+65 RIM= 715.8 INV. OUT= 704.8 INV. IN= 704.9	MH2 TO MH5 STAT= 11+83.62 RIM= 723.8 INV. OUT= 717.4 INV. IN= 717.5
CB4 T/C= 719.24± INV= 714.99			

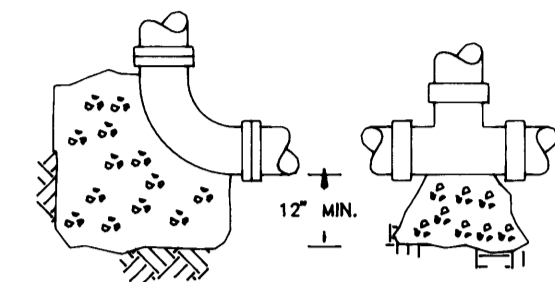

THRUST BLOCKS

PIPE DIA. OR WYE	90° ELL	45° ELL	22.5° ELL
8"	2.8	4.0	2.2
10"	3.0	4.3	2.5
12"	3.3	4.6	2.8

SOIL = 1,500 #/SQ. FT. PRESSURE = 150 PSI

FILED
Date: 1/16/2003 By: JP
This survey consists of:
Map:
Name:
Corner: Rpt.
DOUGLAS COUNTY SURVEYOR

MONA STREET SCALED ELEVATIONS PER CONSTRUCTION PLANS VERT: 1"=40' HORZ: 1"=40'

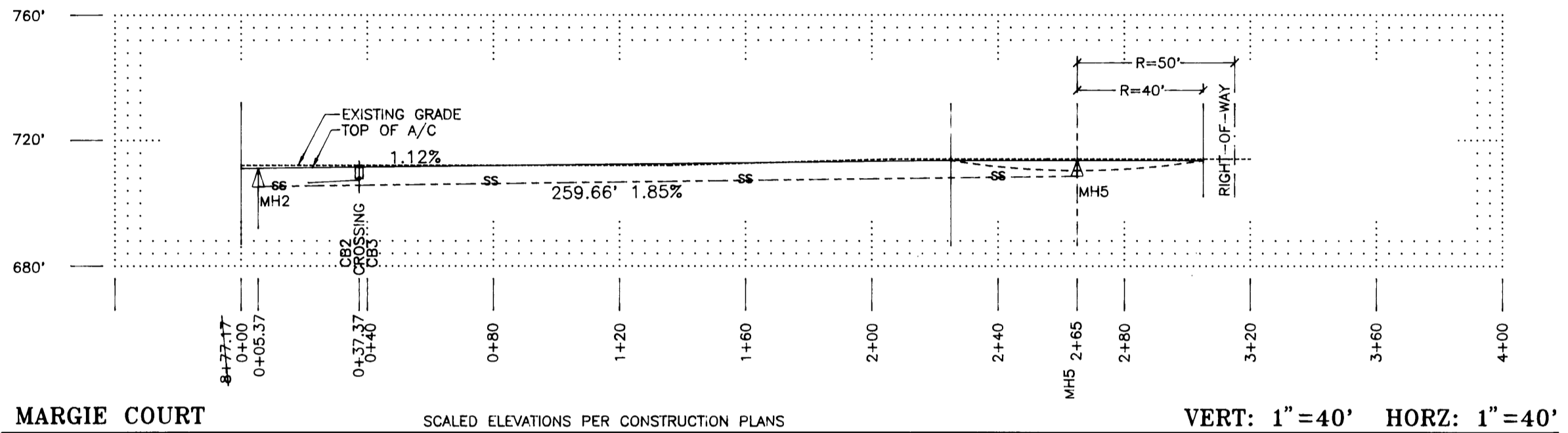

MARGIE COURT SCALED ELEVATIONS PER CONSTRUCTION PLANS VERT: 1"=40' HORZ: 1"=40'

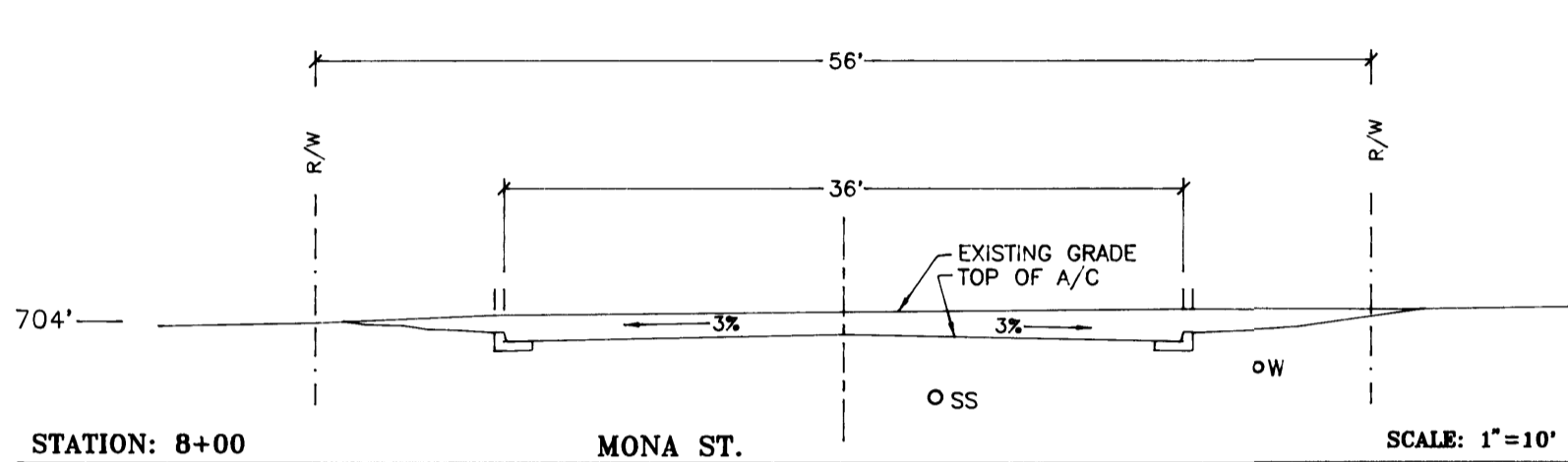

MONA ST. SCALE: 1"=10'

- GENERAL NOTES
- NOTICE TO EXCAVATORS: ATTENTION: OREGON LAW REQUIRES YOU TO FOLLOW RULES ADOPTED BY THE OREGON UTILITY NOTIFICATION CENTER. THOSE RULES ARE SET FORTH IN OAR 852-001-0010 THROUGH OAR 852-001-0090. YOU MAY OBTAIN COPIES OF THE RULES BY CALLING THE CENTER. PHONE NUMBERS ARE: (503) 233-1987 AND 1-800-332-2344.
 - THE CONTRACTOR SHALL REPLACE ANY AND ALL SURVEY MONUMENTS WHICH ARE AFFECTED BY THE CONSTRUCTION OF THE PROJECT PRIOR TO CONSTRUCTION.
 - LOCATIONS OF ALL UTILITIES SHOWN HEREON ARE APPROXIMATE AND SHALL BE VERIFIED PRIOR TO CONSTRUCTION.
 - ALL CHANGES SHALL BE APPROVED BY THE ENGINEER AND THE AFFECTED AGENCY PRIOR TO CONSTRUCTION.
 - THE CONTRACTOR SHALL SUPPLY PIPING MATERIALS, BACK FILL MATERIALS, SURFACE REPAIR, TIE-IN MATERIAL, ETC. AS REQUIRED BY THESE PLANS AND SPECIFICATIONS.
 - ALL WORK WITHIN THE RIGHT-OF-WAY SHALL CONFORM TO THE SPECIFICATIONS AND REQUIREMENTS OF THE PUBLIC WORKS DEPARTMENT OF DOUGLAS COUNTY.
 - THE CONTRACTOR SHALL PROVIDE ALL TRAFFIC CONTROL DEVICES AND PERSONNEL TO CONFORM WITH REQUIREMENTS OF THE MULTIC.D. AND THE DOUGLAS COUNTY P.W. DEPT.
 - CONTRACTOR SHALL OBTAIN PERMIT FROM DOUGLAS COUNTY-PUBLIC WORKS FOR WORK WITHIN R/W.
 - NUMBER OF TRENCH COMPACTION TEST PER PHASE SHALL BE A MINIMUM OF THREE PER PHASE 1 AND 2, PHASE 3 SHALL BE A MINIMUM OF 2 TRENCH COMPACTION TEST.
 - WHENEVER SEWER LINES CROSS WATER LINES WITH LESS THAN 18" CLEARANCE (VERTICAL) THE SEWER LATERAL SHALL BE ONE CONTINUOUS MINIMUM 6" DIA. PVC OR DUCTILE IRON PIPE 9" MINIMUM EACH SIDE OF THE WATER LINES.
 - SEWER LINES PARALLEL WITH WATER LINES SHALL HAVE 10" MINIMUM (HORIZONTAL) SEPARATION UNLESS OTHERWISE NOTED ON PLANS.
 - MANHOLES SHALL BE VACUUM TESTED IN ACCORDANCE WITH DEO'S GUIDELINES AND CURRENT VERSION OF THE 1990 APWA STANDARD SPECIFICATION JOB.306.3. TESTING SHALL BE WITNESSED BY THE ENGINEER OF RECORD.
 - ALL MANHOLE CONNECTIONS SHALL BE FACTORY CONNECTIONS WITH NON-SHRINK GROUT OR A CORED HOLE WITH FLEXIBLE BOOT, 14" KOR-N-SEAL.
 - CONTRACTOR TO PROVIDE PREFORMED PLASTIC GASKETS IN ALL MANHOLE JOINTS.
 - GROUT FOR TOP OF MANHOLE FRAMES AND BASSES SHALL BE NON-SHRINK GROUT.
 - USE COMMERCIAL CONCRETE BONDING AGENT ON ALL CONCRETE TO BE GROUTED.
 - ALL MANHOLES TO BE 48" CONCENTRIC CONES.
 - THE MANHOLE SHALL PASS A 5% DEFLECTION TEST, 30 DAYS AFTER CONSTRUCTION.
 - LINE AND GRADE SHALL BE MAINTAINED AS SHOWN ON THE PLANS, OR AS ESTABLISHED BY THE ENGINEER. VARIATIONS MORE THAN 1/2" FOR LINE AND 1/4" FOR GRADE WILL NOT BE PERMITTED.
 - ENGINEER OF RECORD SHALL BE GIVEN AT LEAST 48 HOURS PRIOR NOTICE OF ANY MANHOLE AND/OR SEWER LINE TESTING.
 - COMPACTION TESTS SHALL BE AT SPECIFIC LOCATIONS AS REQUESTED BY THE ENGINEER OF RECORD OR TRI CITY WATER/SANITARY DISTRICT.
 - ALL TESTING OF MANHOLES, PIPES AND FITTINGS FOR FINAL ACCEPTANCE SHALL BE AFTER ALL BACK-FILL IS COMPLETED INCLUDING COMPACTION AND AC.
 - NO FLAT TOP MANHOLES TO BE USED WITHOUT TRI CITY'S SANITARY AUTHORITY'S PRIOR APPROVAL.
- STREET IMPROVEMENT NOTES
- ALL STREET IMPROVEMENT WORK SHALL BE IN CONFORMANCE WITH THE LATEST VERSION OF DOUGLAS COUNTY DRAINAGE MANAGEMENT PLAN DESIGN STANDARDS AND ADDENDUM DATED MAY 1990 AND THE COUNTY DEPARTMENT OF PUBLIC WORKS SPECIFICATIONS.
 - ALL ASPHALT PAVEMENT SHALL BE "C" MIX MEETING OREGON STATE HIGHWAY DEPARTMENT STANDARDS.
- SANITARY SEWER NOTES
- ALL SANITARY SEWER SHALL BE IN COMPLIANCE WITH THE TRI-CITY SANITARY DISTRICT SPECIFICATIONS AND ORDINANCES. IN CASES OF CONFLICT THE TRI-CITY SANITARY DISTRICT SPECIFICATIONS SHALL TAKE PRECEDENCE OVER THE STANDARD SPECIFICATIONS.
 - SANITARY SEWER LATERALS SHALL BE CONSTRUCTED IN ACCORDANCE WITH OREGON STATE DEPARTMENT OF COMMERCE, BUILDING CODES DIVISION, 1991 UNIFORM PLUMBING CODE AND ITS AMENDMENTS. PUBLIC SEWER SHALL BE CONSTRUCTED IN ACCORDANCE WITH D.E.O. STANDARDS FOR PUBLIC SEWERS AND TO THE LINES, GRADES AND DETAILS SHOWN ON THE PLANS.
 - ALL LINES SHALL HAVE TONING WIRE INSTALLED IN THE TRENCH FOR FUTURE LOCATING. ALL TONING WIRE TO BE TESTED WITH LOCATING EQUIPMENT. THE TESTING SHALL BE WITNESSED BY THE ENGINEER OF RECORD.
 - ALL SANITARY SEWER LINES AND LATERALS SHALL BE AIR TESTED IN ACCORDANCE WITH STANDARD SPECIFICATIONS, UNLESS OTHERWISE NOTED. AFTER COMPACTION OF BACK FILL, THE MAINS SHALL BE TESTED WITH A MOVABLE EYE CAMERA, AND TAPES AND WRITTEN RECORDS SHALL BE FURNISHED TO THE DISTRICT SHOWING AN ACCEPTABLE INSTALLATION. THE TESTING SHALL BE WITNESSED BY THE ENGINEER OF RECORD.
 - SANITARY SEWER PIPE SHALL BE PVC SDR 35 WITH ASTM D3034 FOR DIAMETERS FROM 4" TO 18" AND ASTM F2919 FOR 18"-24" DIAMETERS. MAINS SHALL BE 8" AND LATERALS SHALL BE 6" WITH "T" CONNECTIONS.
 - CONCRETE SHALL BE CLASS 5 (1 1/2" MAX. AGGREGATE SIZE) WITH 8 BAGS CEMENT PER CUBIC YARD OF CONCRETE, WITH A MINIMUM COMPRESSIVE STRENGTH OF NOT LESS THAN 3,000 P.S.I. AT 28 DAYS WHEN TESTED IN ACCORDANCE WITH ASTM C-39.86.

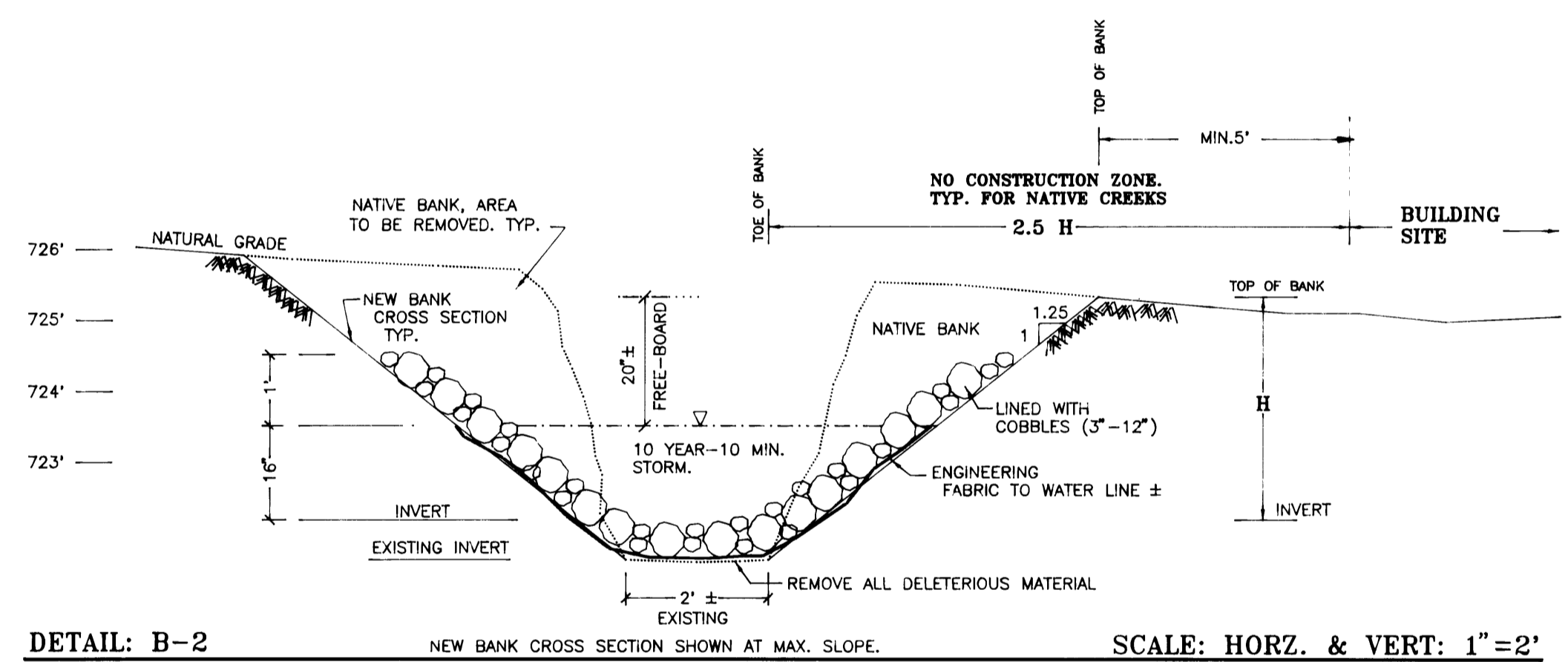

DETAIL: B-2 NEW BANK CROSS SECTION SHOWN AT MAX. SLOPE. SCALE: HORZ. & VERT: 1"=2'

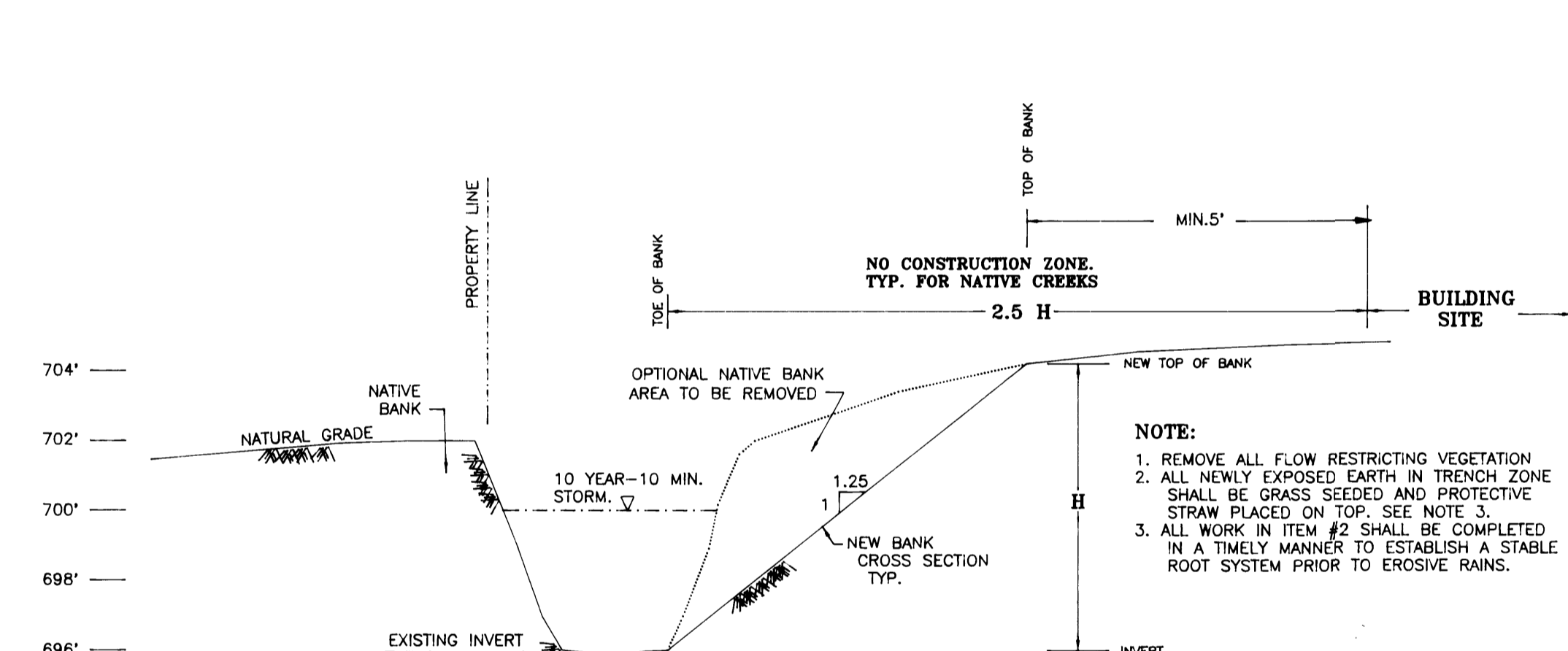

DETAIL: C-2 NEW BANK CROSS SECTION SHOWN AT MAX. SLOPE. SCALE: HORZ. & VERT: 1"=2'

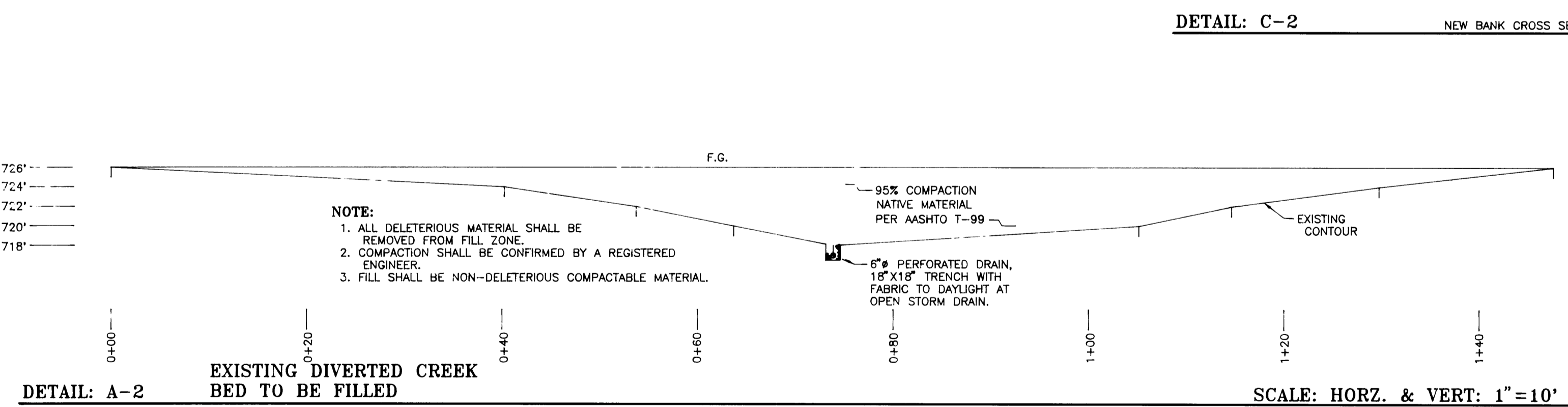

DETAIL: A-2 EXISTING DIVERTED CREEK BED TO BE FILLED. SCALE: HORZ. & VERT: 1"=10'

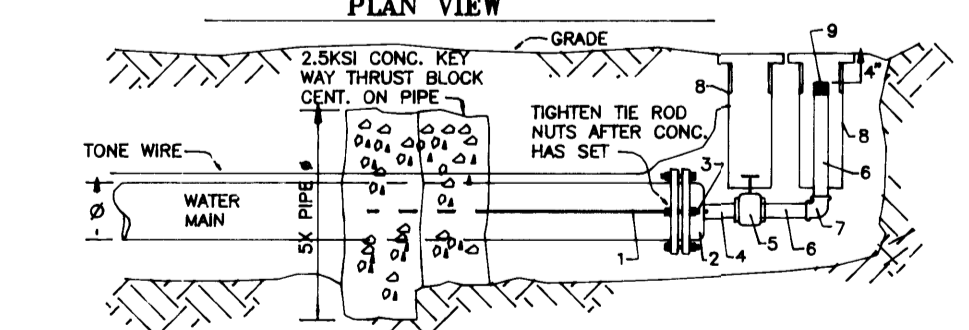
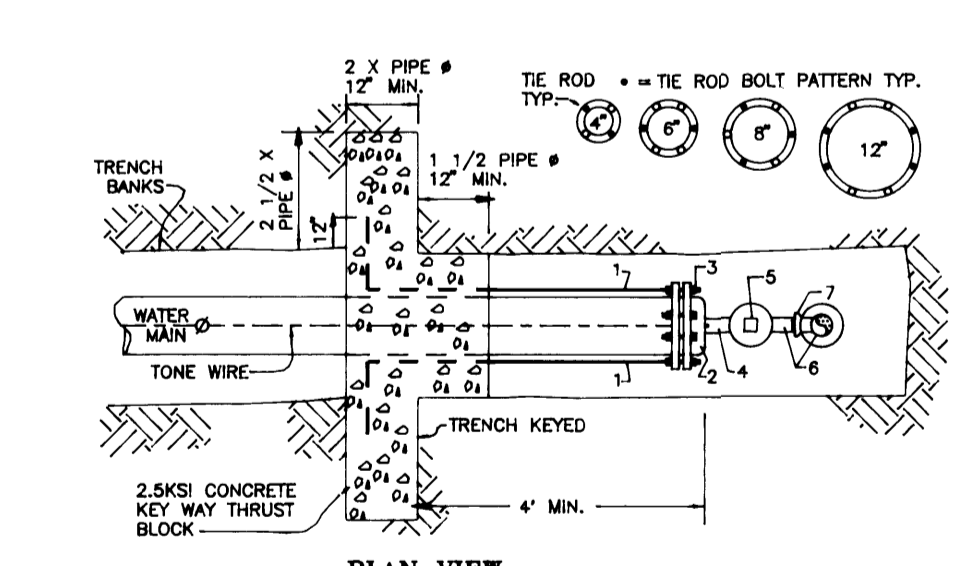

- TYPICAL 2' BLOWOFF ASSEMBLY
- 1 1/4" DIA. STEEL TIE ROD, N.C. THD. ONE END, BUTYRAMASTIC COATED AFTER INSTALLATION.
 - MAN SIZE GAP WITH 2" L.P. OUTLET (M.I. 7 F.L.P.1)
 - 2" GALVANIZED IRON PIPE NIPPLE, BUTYRAMASTIC COATED AFTER INSTALLATION.
 - 2" GATE VALVE (FL.13) WITH 2" S.S. OPERATING NUT
 - 2" GALVANIZED IRON PIPE LENGTH AS REQUIRED.
 - 2" STANDARD VALVE BOX WITH LID
 - 2" CAP, HAND TIGHTEN ONLY

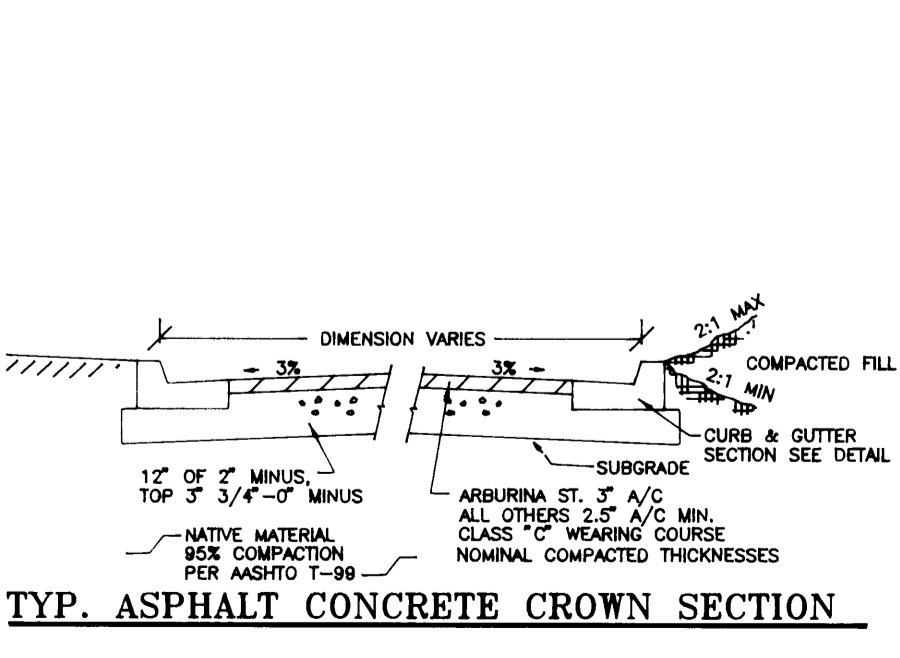
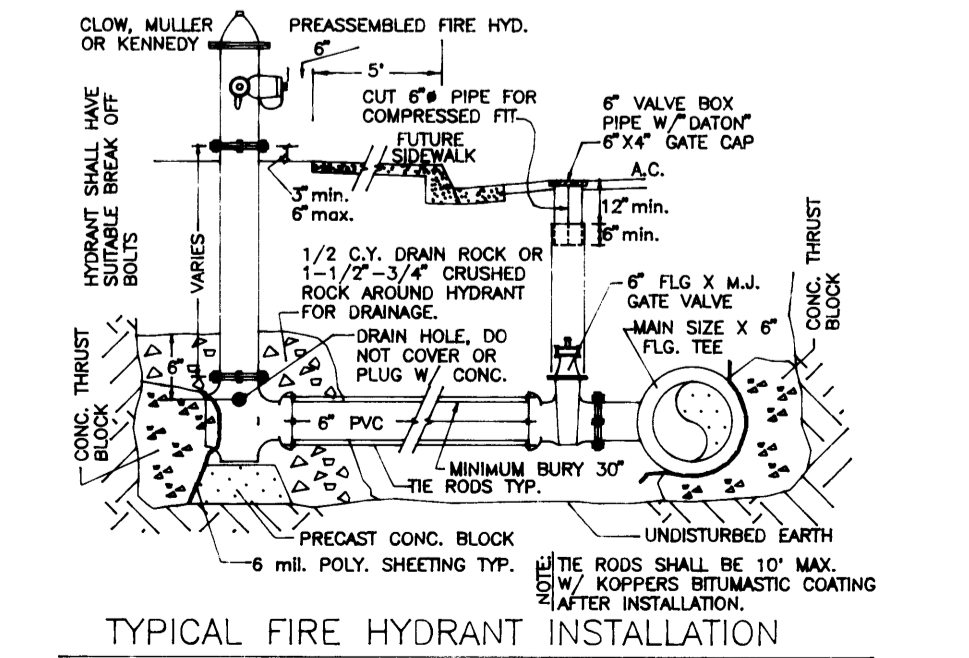
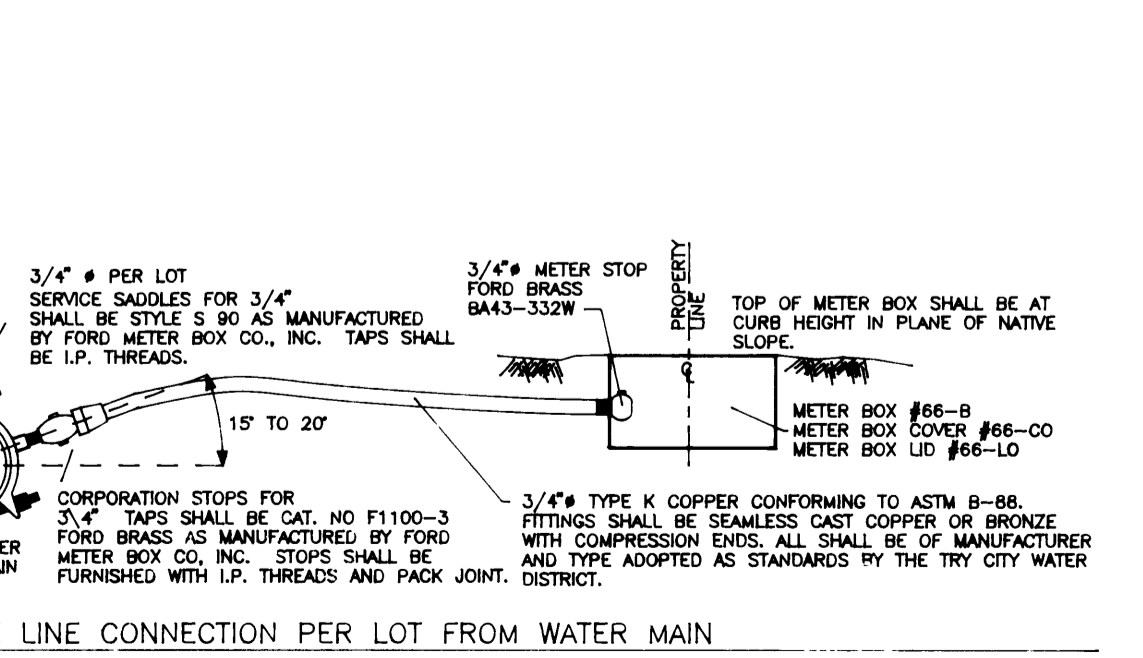
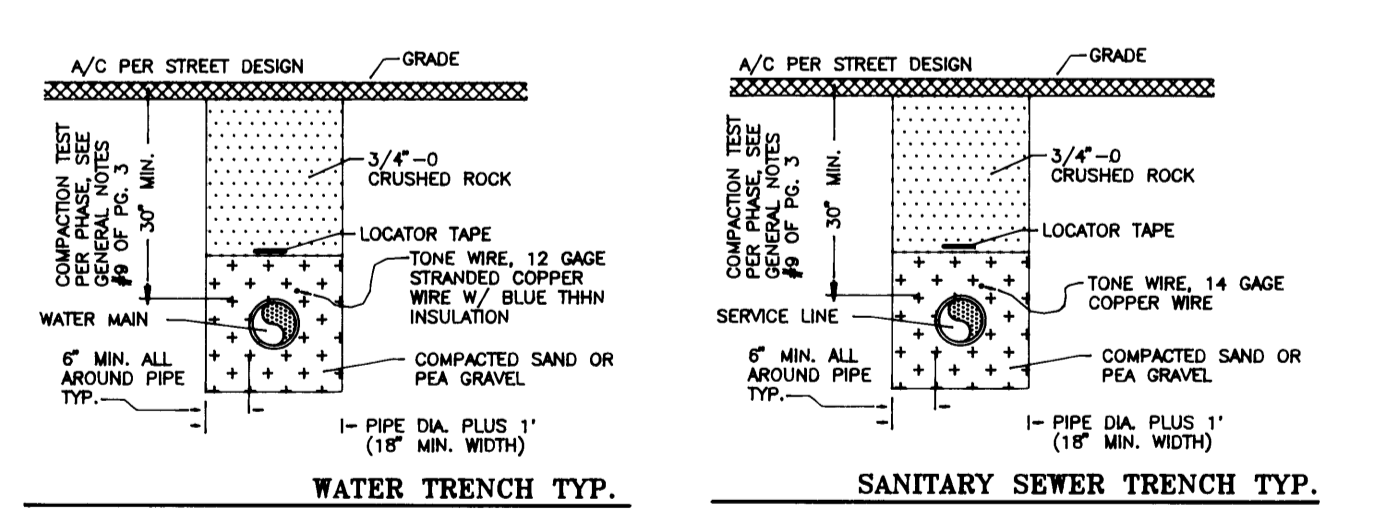

PHASE 1

JORDAN ENGINEERING
460 JORDAN LANE
ROSEBURG, OREGON 97470
(541) 673-1931

SCALE: 1"=40'
DATE: 2-4-02
PROFILE WITH DETAILS
ROLAND THEISS
P.O. BOX 824
MYRTLE CREEK, OR 97457

VILLAGE VIEW SUBDIVISION
47 LOTS

AS-BUILT
PROFILE WITH DETAILS
REVISED
DRAWN BY: K.C.J.

ZONE: R-1
DRAWING NUMBER: 2 OF 2

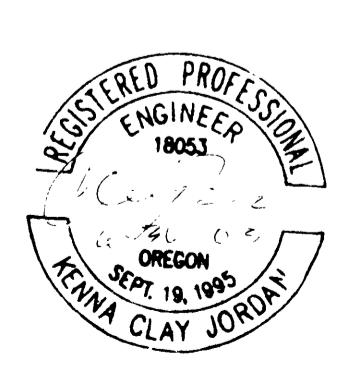

Co. Rd. # 907 & 907A
CO. RD. # 907 & 907A AS-BUILT
PROFILE WITH DETAILS

R907DET1