

NOTE: 1. SANITARY SEWER TO BE CONSTRUCTED IN CONFORMANCE WITH R.U.S.A. AND COUNTY ROAD DEPT. SPECIFICATIONS.
 2. CONTRACTOR TO SECURE ALL PERMITS

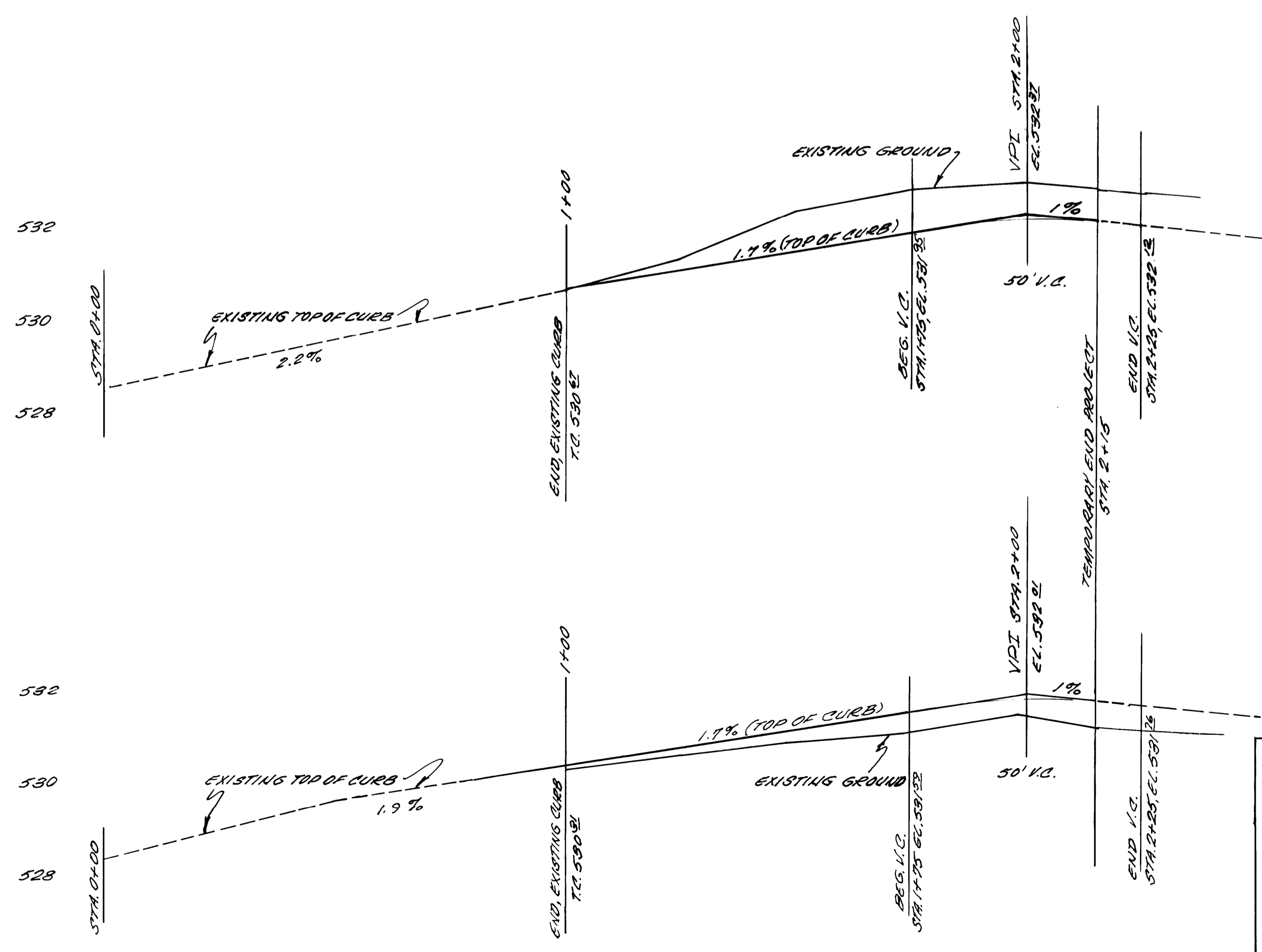

I, JAMES F. GOSSON HEREBY CERTIFY THAT THIS PROJECT HAS BEEN CONSTRUCTED IN SUBSTANTIAL CONFORMANCE WITH THE PLANS AND SPECIFICATIONS EXCEPT WHERE MODIFIED DURING CONSTRUCTION AND NOTED HEREON.

James F. Gosson
 JAMES F. GOSSON P.E.
 3-8-88
 DATE

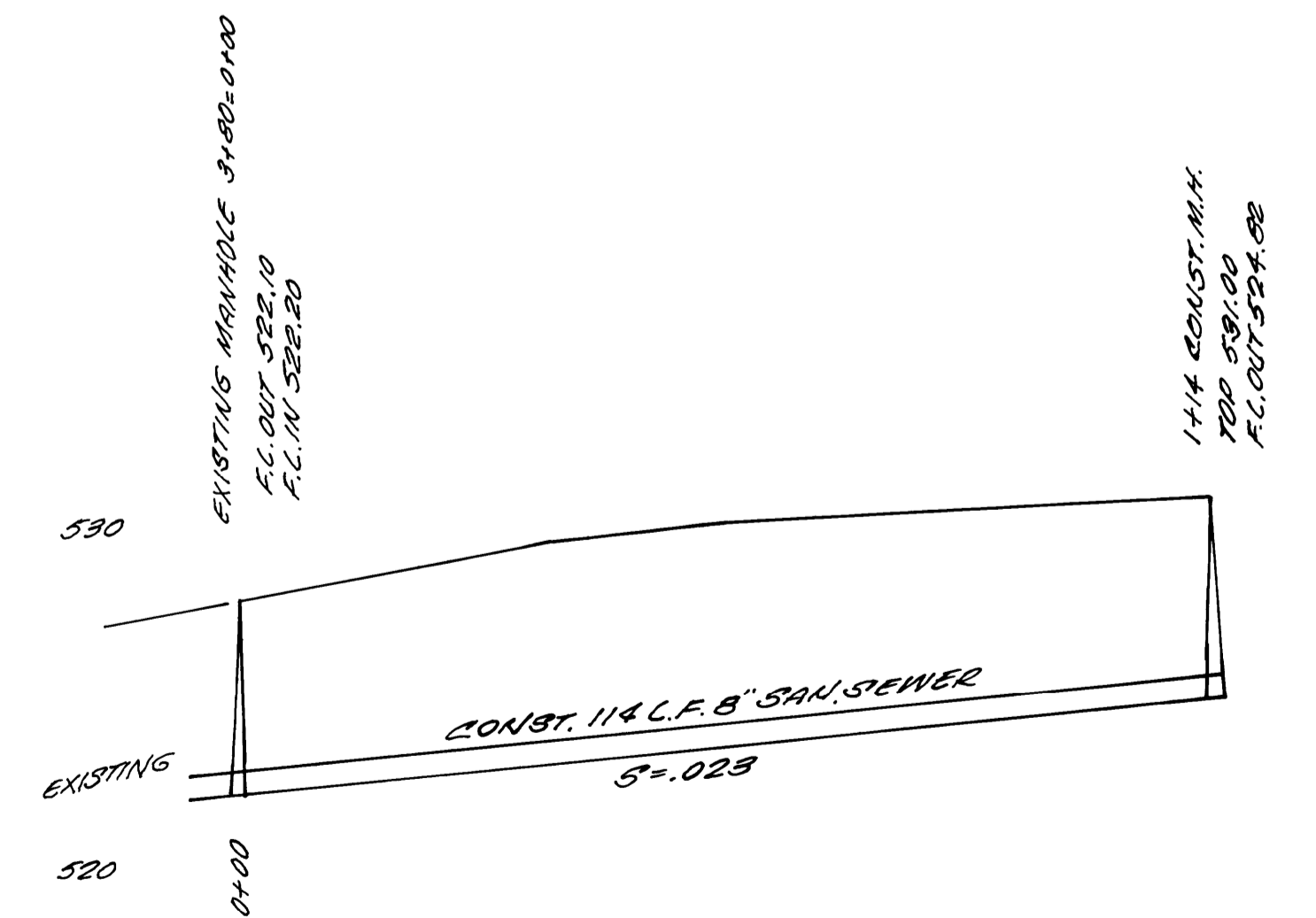
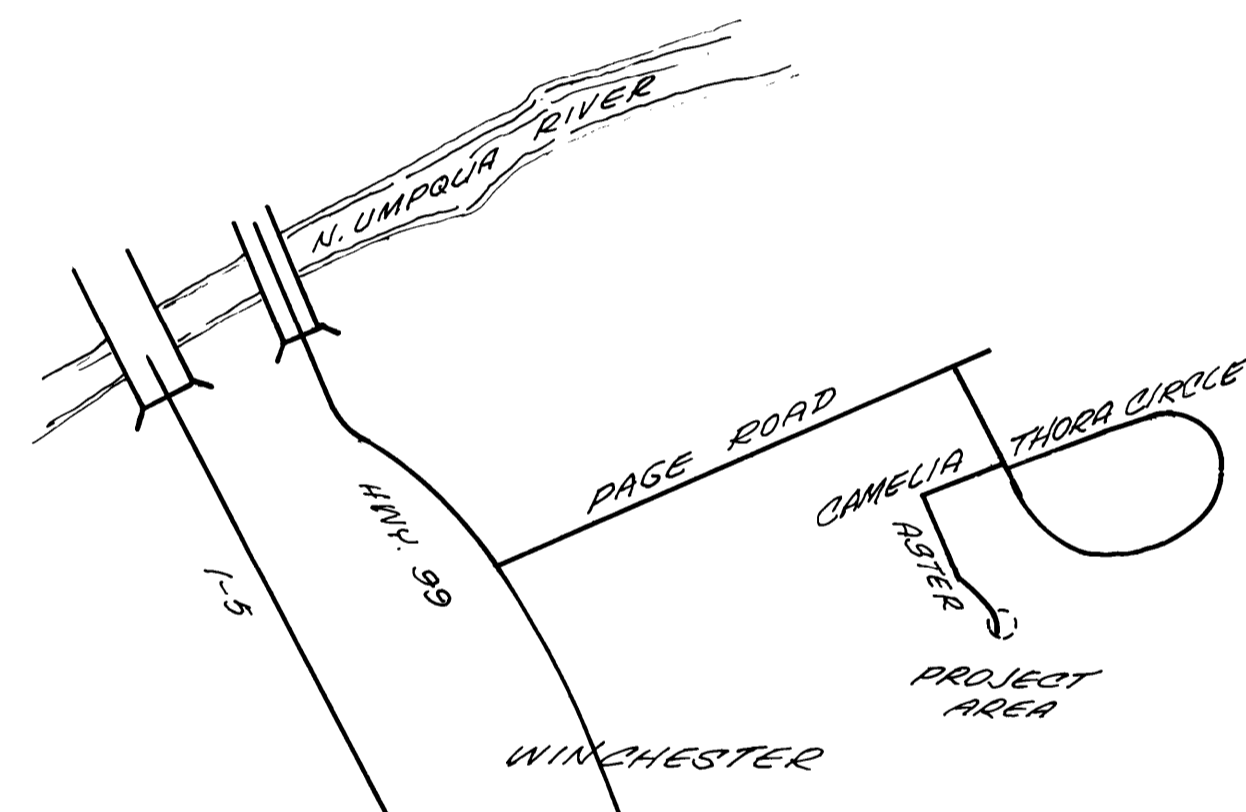
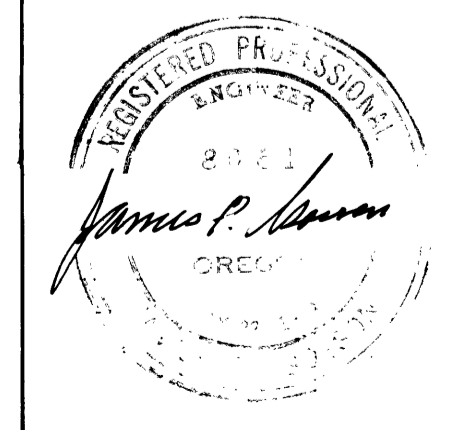

AS - BUILTS	
DATE	AUG 1987
DRAWN	DONALD A. BENTZ, INC. 1205 S.E. COURT ST. ROSEBURG, OR. 97470
DESIGN	SADDLE BUTTE ESTATES
REV	2ND ADDITION
	ASTER STREET EXTENSION

Co. Rd. # 901B

MP 0.13 - 0.15

T 26-5-30

CO RD 901B

00130015

SHEET 1 OF 1