

FILED
 Date: 12-4-97, By: J.P.
 This survey consists of:
 Map: _____
 Narrative: _____
 Corner Rpt: _____
 DOUGLAS COUNTY
 SURVEYOR

| | | |
|--------------|----|------|
| FINAL SURVEY | BY | DATE |
| SURVEYED | | |
| PLOTTED | | |
| NOTED | | |
| CHECKED | | |
| APPROVED | | |

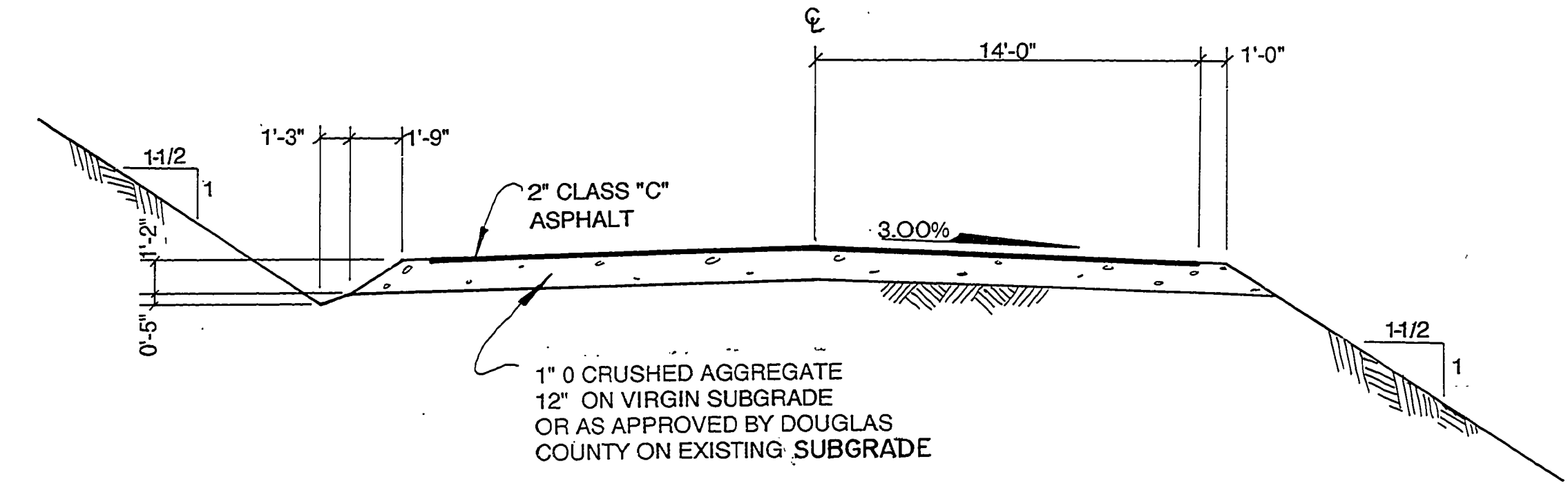

CROSS SECTION

| | | |
|-----------------|----|------|
| ORIGINAL SURVEY | BY | DATE |
| SURVEYED | | |
| PLOTTED | | |
| NOTED | | |
| CHECKED | | |
| APPROVED | | |

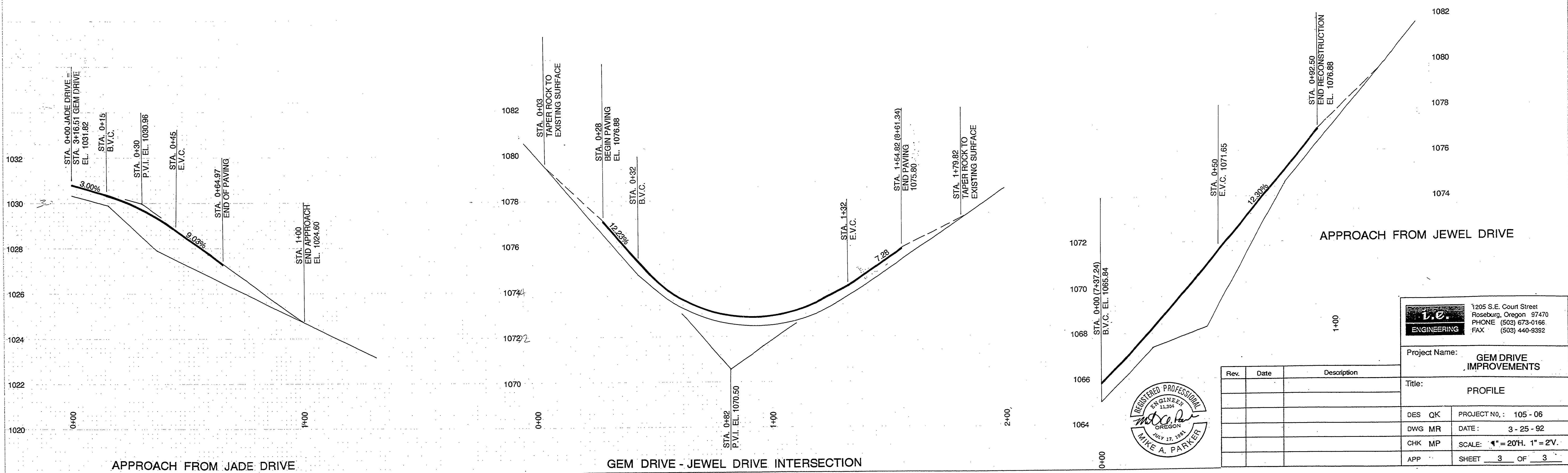

| Rev. | Date | Description |
|------|------|-------------|
| | | |
| | | |
| | | |
| | | |

I.E. ENGINEERING
 1205 S.E. Court Street
 Roseburg, Oregon 97470
 PHONE (503) 673-0166
 FAX (503) 440-9392

Project Name: **GEM DRIVE IMPROVEMENTS**
 Title: **PROFILE**

| | | | |
|-----|----|--------------|----------------------|
| DES | QK | PROJECT NO.: | 105 - 06 |
| DWG | MR | DATE: | 3 - 25 - 92 |
| CHK | MP | SCALE: | 1" = 20'H. 1" = 2'V. |
| APP | | SHEET | 3 OF 3 |

HIGHWAY FEDERAL AID SHEET
 PLATE 4-SINGLE PLAN AND CROSS SECTION-FULL DOT
 4715-10-10
 PRINTED IN U.S.A.