

FILED
 Date: 1-28-2009 By: J.P.
 This survey consists of:
 Map: Co. 20 # 388
 Number of Sheets: 8
 Corner Rpt:
 DOUGLAS COUNTY
 SURVEYOR

TABLE OF FOUND MONUMENTS

NO.	NORTHING	EASTING	RECORD	DESC.
52	34439.53	249233.30	NOT FND.	5/8" I.R. W/CAP
53	34380.80	249196.72	NOT FND.	5/8" I.R. W/CAP
54	34391.08	249164.56	M104-37	5/8" I.R. W/CAP
55	34393.44	249157.28	M104-37	5/8" I.R. W/CAP

TABLE OF SET MONUMENTS

STATION	OFFSET	NORTHING	EASTING
44+93.56 PC	50.00 RIGHT	34229.05	249137.94

- BRASS CAP (AS NOTED)
- ⊕ BENCH MARK (AS NOTED)
- FOUND MONUMENTS (AS NOTED)
- SET MONUMENTS 5/8" X 30" I. R. W/CAP STAMPED "DOUGLAS CO RD DPT R-W"

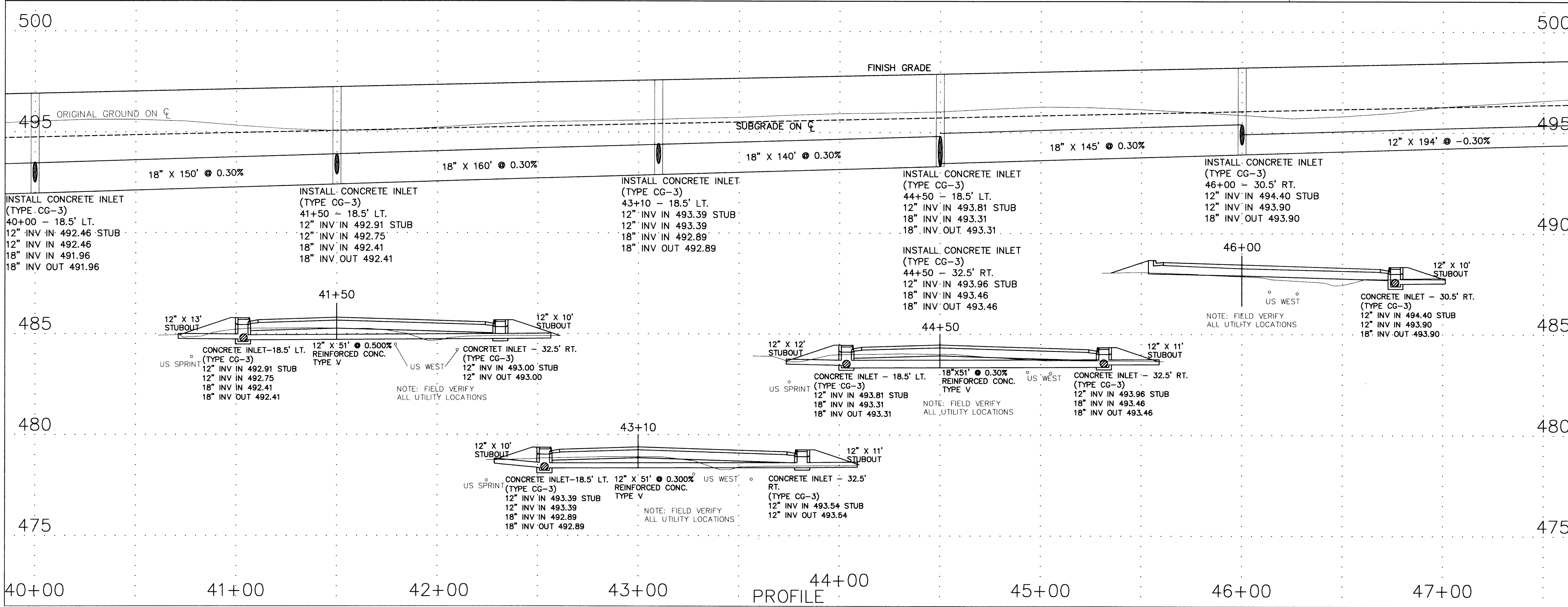

REGISTERED
 PROFESSIONAL
 LAND SURVEYOR
Donald G. Beecroft Jr.
 OREGON
 447-25-1991
 DONALD G. BEECROFT JR.
 2490
 EXPIRES 12-31-09

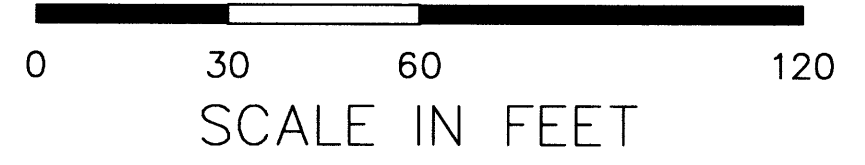

R388RW.DWG

REVISIONS	DATE	BY	DESCRIPTION
12/17/2008			

DOUGLAS COUNTY
 DEPARTMENT OF PUBLIC WORKS
 RIGHT-OF-WAY PLANS
 OLD HIGHWAY 99 NORTH #388
 M.P. 5.53 TO M.P. 6.42

DESIGN	CHECK	REVIEW	DATE	DIRECTOR
			DEC. 2008	ROBERT G. PAUL, PE, PLS

SHEET NO. 6 OF 8

CO. RD. 388

05840570