

**FILED**  
 Date: 6/10/2012 By: JK  
 This survey consists of:  
 Map: CO RD 388  
 Narrative: 2009  
 Corner Rpt: 6/29/09  
**DOUGLAS COUNTY SURVEYOR**

TABLE OF FOUND MONUMENTS

NO.	NORTHING	EASTING	RECORD	DESC.
31	37008.36	251468.32	CS51/291	1/2" I.R.
32	36735.50	251381.09	M126-68	3/4" I.R. W/CAP
34	36734.58	251383.33	M75-1	3/4" I. R.
35	36756.02	251324.96	M125-59	5/8" I. R. W/CAP
56	36682.46	251285.80	CO RD #388 04900500	3/4" I.R. W/CAP
57	36656.79	251365.78	CO RD #388 04900500	3/4" I.R. W/CAP
58	36730.99	251298.22	CO RD #388 04900500	3/4" I.R. W/CAP
59	36703.48	251383.91	CO RD #388 04900500	3/4" I.R. W/CAP

TABLE OF SET MONUMENTS

STATION	OFFSET	NORTHING	EASTING
89+10.71 PI	45.00 RIGHT	37142.16	251524.71
89+10.71 PI	45.00 LEFT	37169.64	251439.01

- ⊙ BRASS CAP (AS NOTED)
- ⊕ BENCH MARK (AS NOTED)
- FOUND MONUMENTS (AS NOTED)
- SET MONUMENTS 3/4" x 30" I. R. W/ALUM. CAP STAMPED "DOUGLAS CO RD DPT R-W"

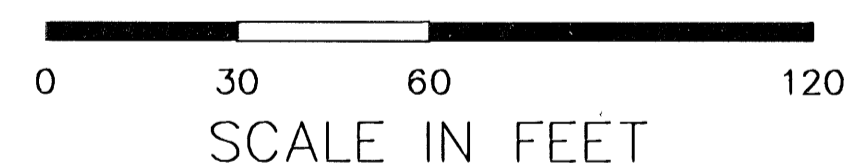
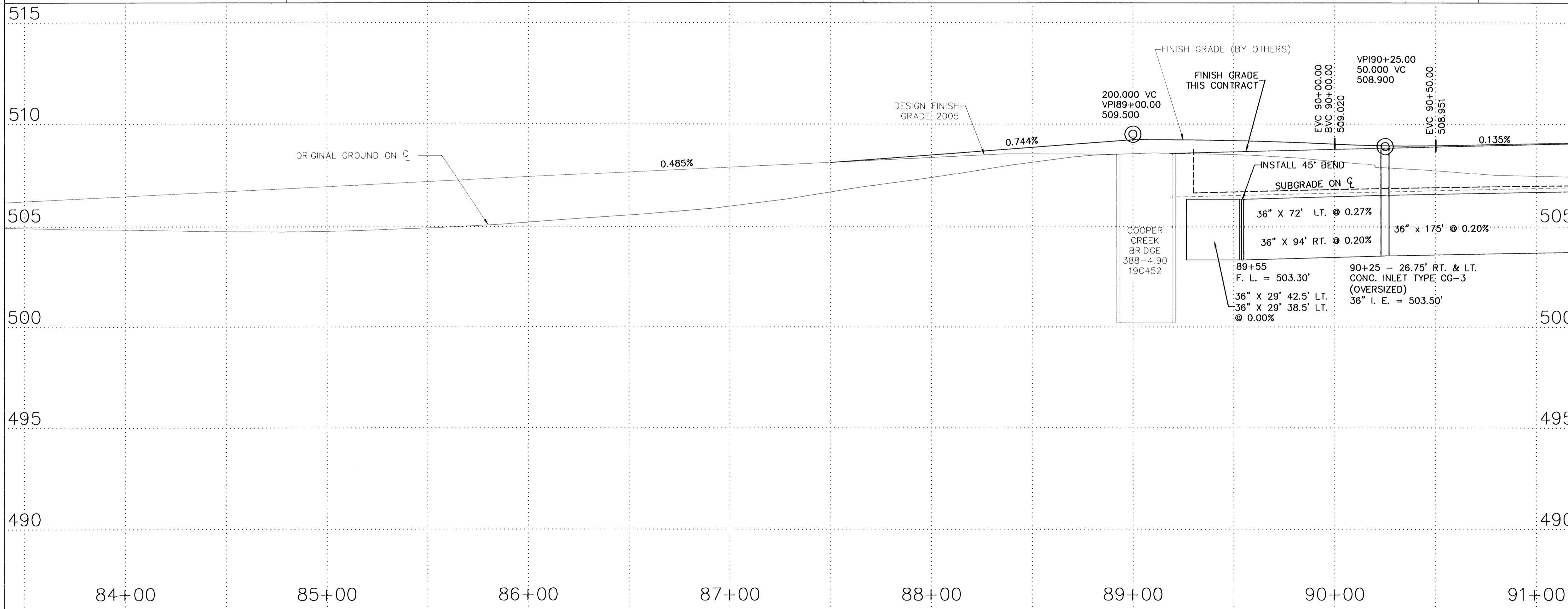

REGISTERED PROFESSIONAL LAND SURVEYOR  
*Donald G. Beecroft Jr.*  
 OREGON  
 JULY 25, 1991  
 DONALD G. BEECROFT JR.  
 2490

EXPIRES 12-31-11

REVISIONS 07/28/2009	DOUGLAS COUNTY DEPARTMENT OF PUBLIC WORKS RIGHT-OF-WAY PLANS FOR S. CALAPOOIA ST #388 M. P. 4.32 TO 4.90
DESIGN	ROBERT G. PAUL, PE, PLS
CHECK	DATE
REVIEW	DIRECTOR
DIVISION APPROVAL	AUG. 2009 SHEET 2 OF 6

Co. Rd. #388 MP 4.90 - 5.04

CO. RD. 388.

04900504