

# Santa Maria Estates

FILED  
 Date: 2-10-92 By: J.P.  
 This survey consists of:  
 Map:  
 Narrative:  
 Corner Rpt.:  
 DOUGLAS COUNTY  
 SURVEYOR

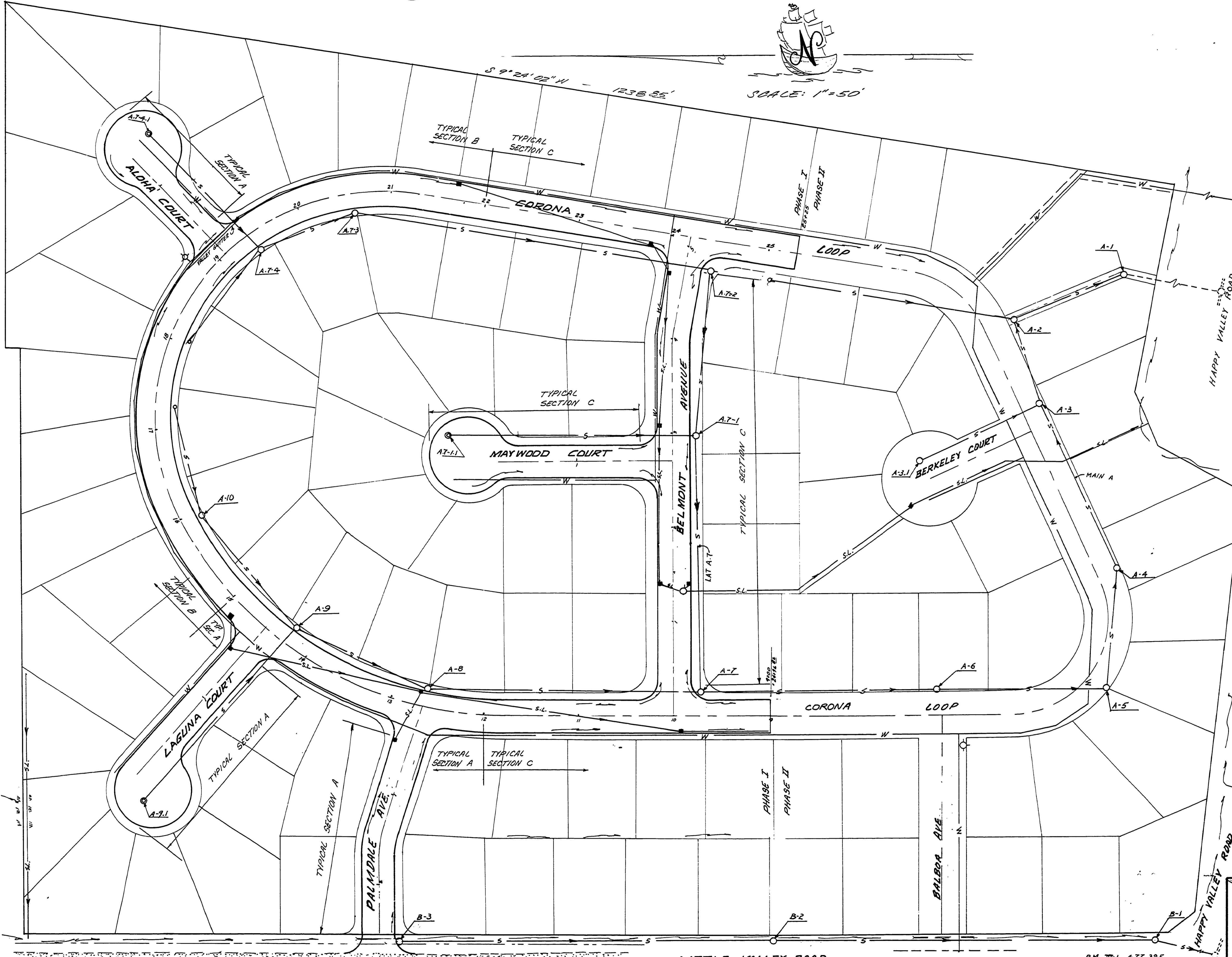

SCALE: 1"=50'

## INDEX TO DRAWINGS

SHEET NO.	TITLE
1.	SITE PLAN - VICINITY MAP
2,3,4*	STREETS AND STORM SEWER
5,6,7,8	SANITARY SEWER AND WATER
9,10.	MISCELLANEOUS DETAILS

NOTES:  
 \* NOT INCLUDED WITH THIS SET OF DWGS  
 1. All work shall conform to the Standard Specifications for Highway Construction.  
 2. Prior to performing any construction, plans shall be approved by the Douglas County Public Works Department, Green Sanitary District, Department of Environmental Quality, and Roberts Creek Water Work shall conform to the approved plans and specifications.  
 3. Record drawings shall be provided to all said parties mentioned in item number two (2). The Contractor shall at his expense be responsible for providing "Record Drawings" information to the engineer. The engineer shall complete the final "Record Drawings" at the owners expense.

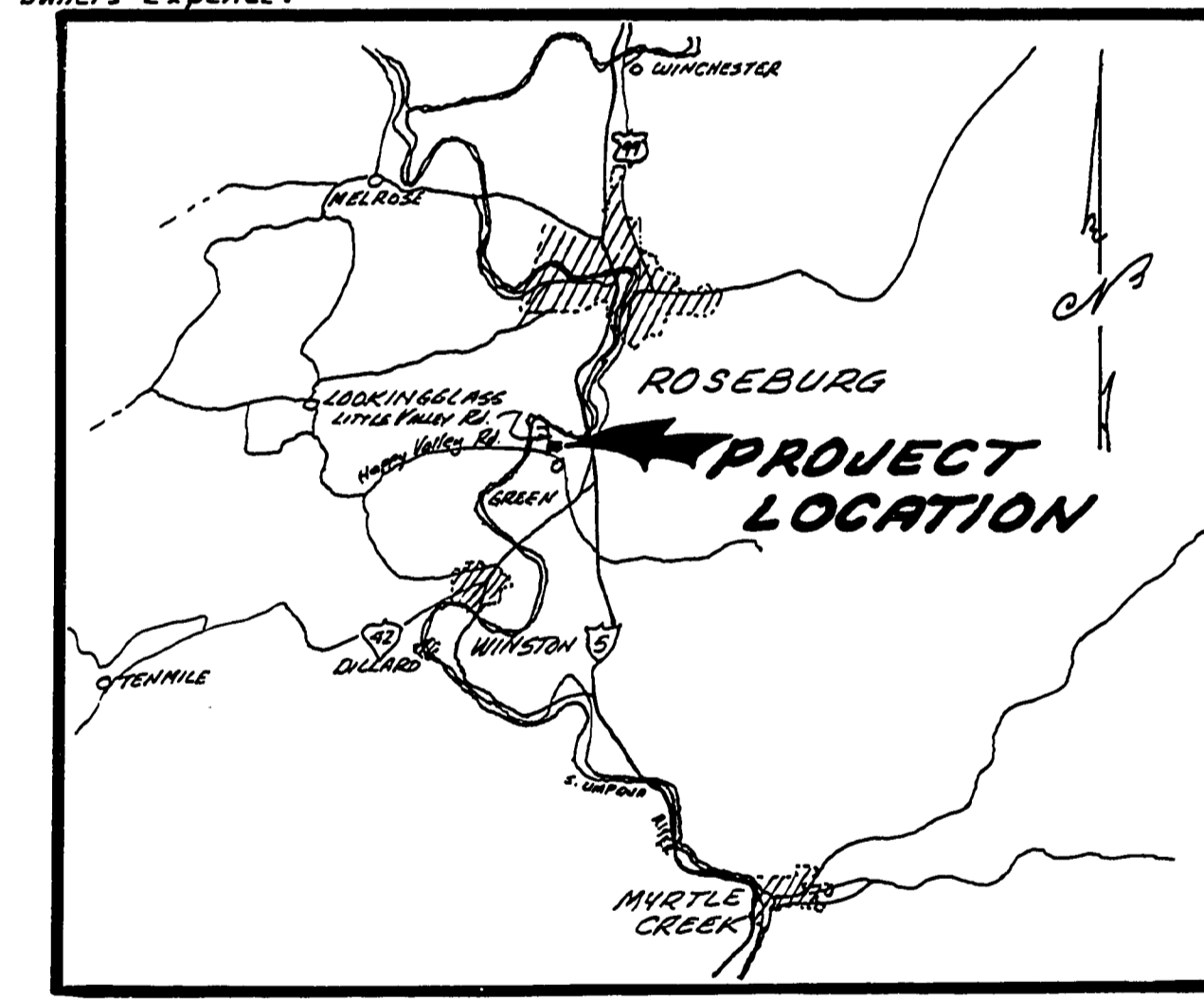

## VICINITY MAP

NO SCALE  
 LEGEND  
 SL STORM SEWER & CATCH INLET  
 S SANITARY SEWER MANHOLE  
 W WATER LINE & VALVE  
 DIRECTION OF FLOW (SURFACE)  
 DOUGLAS COUNTY  
 PUBLIC WORKS DEPT.  
**APPROVED**  
 By: WAP Date: 7-17-92 \* NOTE - WE DID NOT RECEIVE SHEET 4.



**ALPHA AND OMEGA ENGINEERS**

HOWARD BURDETTE  
 SANTA MARIA ESTATES  
 PHASES I & II  
 SITE PLAN - VICINITY MAP

SHEET OF 10 **1**  
 PROJ. # 6.0500  
 DATE July 1990  
 SCALE: 1"=50'  
 HORIZ. VERT. N.A.  
 DWG. NO. 16-5

NO.	DATE	REVISION	BY	APPD.
1	12-1-80	SANITARY RECORD DWGS	DMM	MLT
DES.	DR./K	CHK. MLT	APPD. MLT	

CO. RD. #378-B, C, E & INDEX SHEET

RD378004