

HIGH POINT ELEV = 580.50
 HIGH POINT STA = 17+22.85
 PVI STA = 17+17.04

DATE: 10/18/2008 By: J.C.
 This survey consists of:
 Map:
 Narrative:
 Corner Rpt:
DOUGLAS COUNTY SURVEYOR

500.00' VC
 LOW POINT ELEV = 524.54
 LOW POINT STA = 12+08.56
 PVI STA = 13+20.93
 PVI ELEV = 516.09
 A.D. = 16.95
 K = 29.49

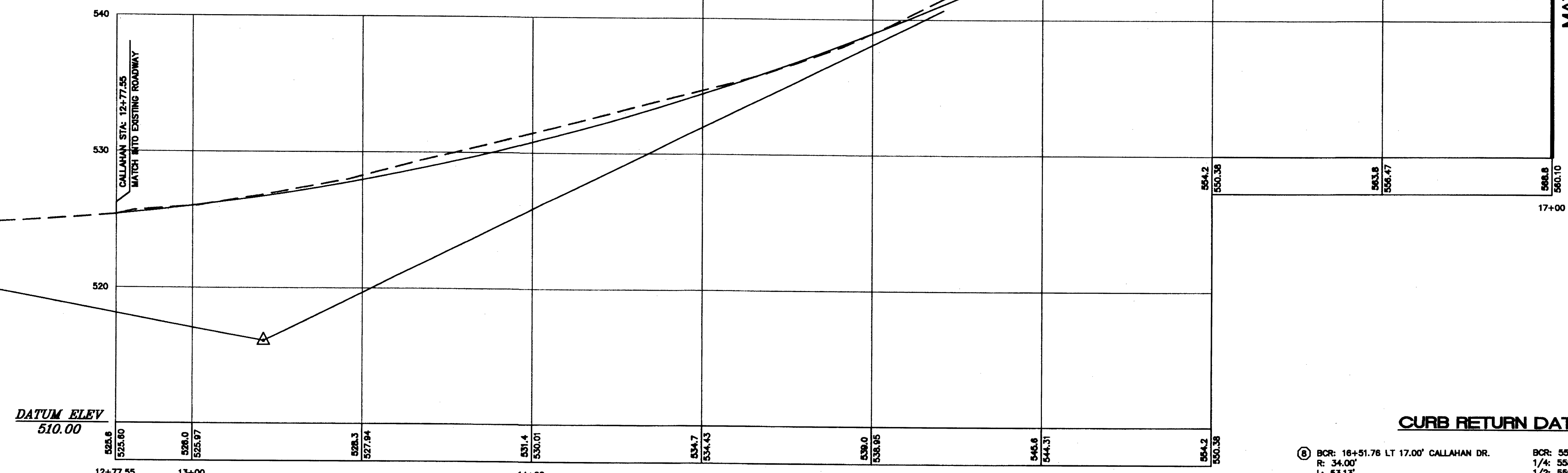

DATUM ELEV
510.00

CALLAHAN DR.
 SCALE: 1" = 20' HORIZ. STA: 12+77.55 - 17+00.00
 1" = 5' VERT.

MATCH LINE SEE SHEET C214

LEGEND:

- SITE BOUNDARY
- EXISTING RIGHT-OF-WAY
- EXISTING CENTER LINE
- EXISTING LOT LINE
- EXISTING EASEMENT LINE
- EXISTING CURB LINE
- EXISTING SIDEWALK LINE
- PHASE LINE
- EXISTING GAS LINE
- PROPOSED RIGHT-OF-WAY
- PROPOSED CENTER LINE
- PROPOSED LOT LINE
- PROPOSED EASEMENT LINE
- PROPOSED CURB LINE
- PROPOSED SIDEWALK LINE
- PROPOSED 2' CONTOUR LINE
- PROPOSED 10' CONTOUR LINE
- PROPOSED INLET PROTECTION
- PROPOSED SEDIMENT FENCE

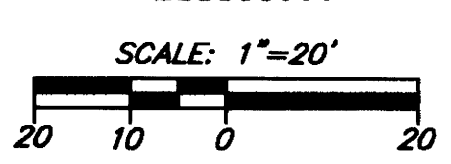

CURB RETURN DATA

(8) BCR: 16+51.78 LT 17.00' CALLAHAN DR. R: 34.00' L: 53.13' T: 33.72' Δ: 89°31'35" ECR: 17+31.87 LT 17.00' CALLAHAN DR.	BCR: 556.29 1/4: 558.18 1/2: 559.43 3/4: 560.07 ECR: 560.09	GUTTER MATCH PROPOSED CALLAHAN DR. GRADES
(9) BCR: 16+48.41 RT 24.22' CALLAHAN DR. R: 98.00' L: 147.19' T: 186.21' Δ: 145°23'55" ECR: 17+35.29 RT 24.23' CALLAHAN DR.	BCR: 555.82 1/4: 557.77 1/2: 558.96 3/4: 559.70 ECR: 559.89	GUTTER MATCH PROPOSED CALLAHAN DR. GRADES
(14) BCR: 16+19.38 RT 17.00' CALLAHAN DR. R: 62.00' L: 30.21' T: 15.41' Δ: 27°55'10" ECR: 16+48.41 RT 24.22' CALLAHAN DR.	BCR: 552.42 1/4: 553.34 1/2: 554.22 3/4: 555.06 ECR: 555.82	GUTTER MATCH PROPOSED CALLAHAN DR. GRADES

CALLAHAN DR. GRADING PLAN STA 12+77.55 - 17+00.00
RIVER CREST ESTATES 2 - PHASE 2
HAYDEN HOMES
 Green District, Oregon

AS-BUILT
 BASED ON CHANGES IDENTIFIED DURING CONSTRUCTION AS OF 3/7/08



DATE: 1/3/08
 DRAWN: I MDB
 DESIGNED: I MDB
 CHECKED: I KBR
 PROJECT #: HAY89900
 SHEET TITLE: CALLAHAN GRADING PLAN
 SHEET NUMBER: **C213**
 OF 4 SHEETS