

CURVE DATA			
#	DELTA	RADIUS	LENGTH
1	63°49'43"	83.00	92.46
2	63°49'43"	117.00	130.34
3	63°49'43"	100.00	111.40

FILED
 Date: 2-10-94 By: J.P.
 This survey consists of:
 Map:
 Plat:
 Corner Pk:
 DOUGLAS COUNTY
 SURVEYOR

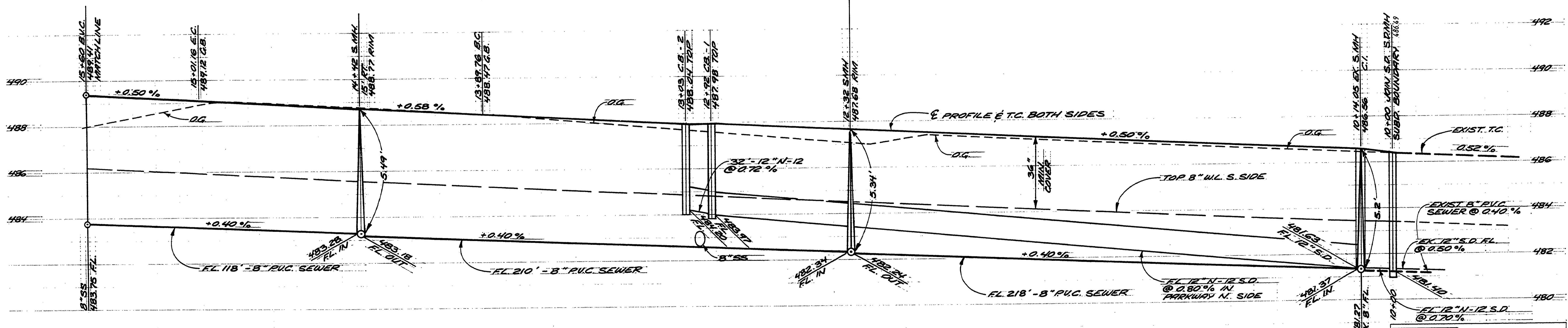

i.e.
 ENGINEERING
 Project Name: **ROLLING HILLS EST. 9TH ADDITION**
 1205 S.E. Court Street
 Roseburg, Oregon 97470
 PHONE (503) 673-0166
 FAX (503) 440-9392

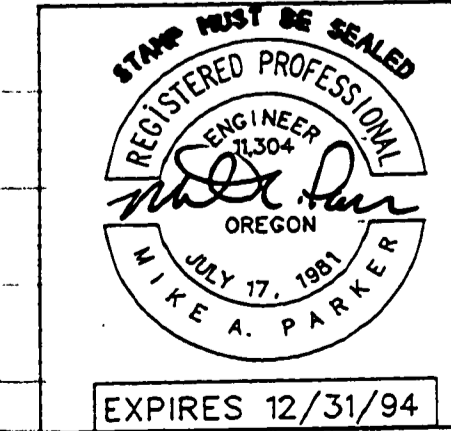

Rev.	Date	Description
1	10/20/93	REALIGN S.D. 10+00 ADD S.M.H. & C.I.
2	10/20/93	ADD 8" G.V. AT F.H. STA. 13+89.76
3	10/20/93	ADD 12" W.L. & G.V.'S PER 6TH ADD.

DES. R.C.I.	PROJECT NO.
CHAR STREET PLAN & PROFILE	108-10
DWG. D.F.	DATE 9-24-93
CHK. MAP.	SCALE 1" = 20'
APP. MAP.	SHEET 2 OF 3