

ROLLING HILLS DRIVE

FILED  
 Date: 2-10-97 By: JP  
 This survey consists of:  
 Map:  
 Narrative:  
 Corner Rpt:  
 DOUGLAS COUNTY  
 SUPERVISOR

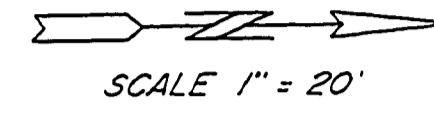

AUSTIN

60' R/W

15' ± 48' 40' LT.

TEMP. EDGE OF PAVEMENT

15' ± 68' EXISTING EDGE PAVEMENT

TEMP. EDGE OF PAVEMENT

15' ± 48' 40' RT.

PROPOSED LINE # 402  
15' ± 56.54'

15' ± 48' END CURB  
T.C. 485.90

15' ± 48' END CURB  
T.C. 485.90

15' ± 48' END CURB  
T.C. 485.90

15' ± 48' END CURB  
T.C. 485.90

15' ± 48' END CURB  
T.C. 485.90

15' ± 48' END CURB  
T.C. 485.90

15' ± 48' END CURB  
T.C. 485.90

15' ± 48' END CURB  
T.C. 485.90

15' ± 48' END CURB  
T.C. 485.90

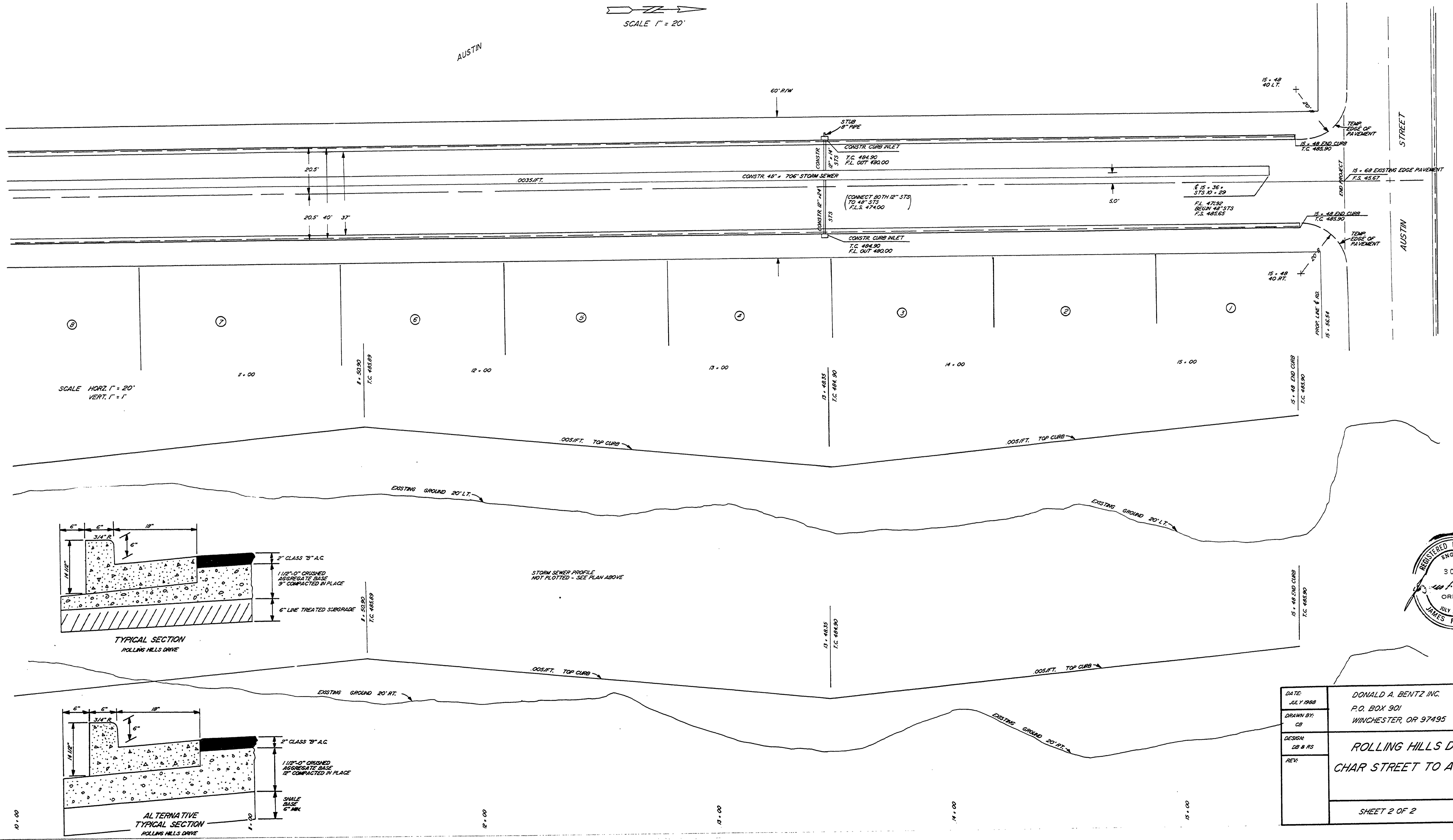

SCALE HORIZ. 1" = 20'  
VERT. 1" = 1'

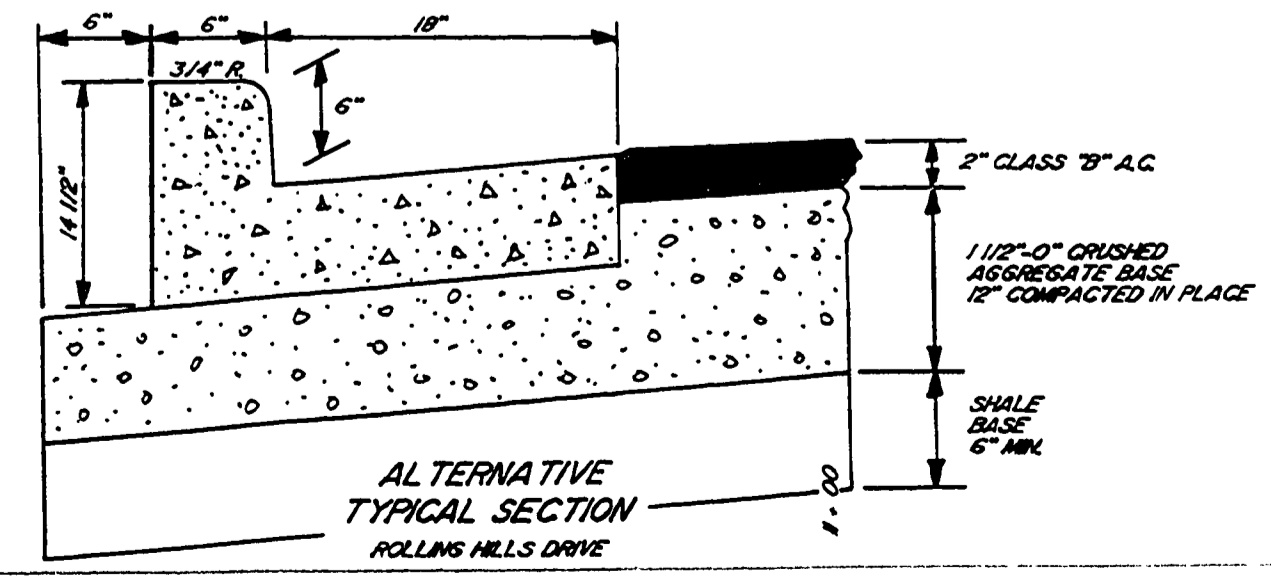
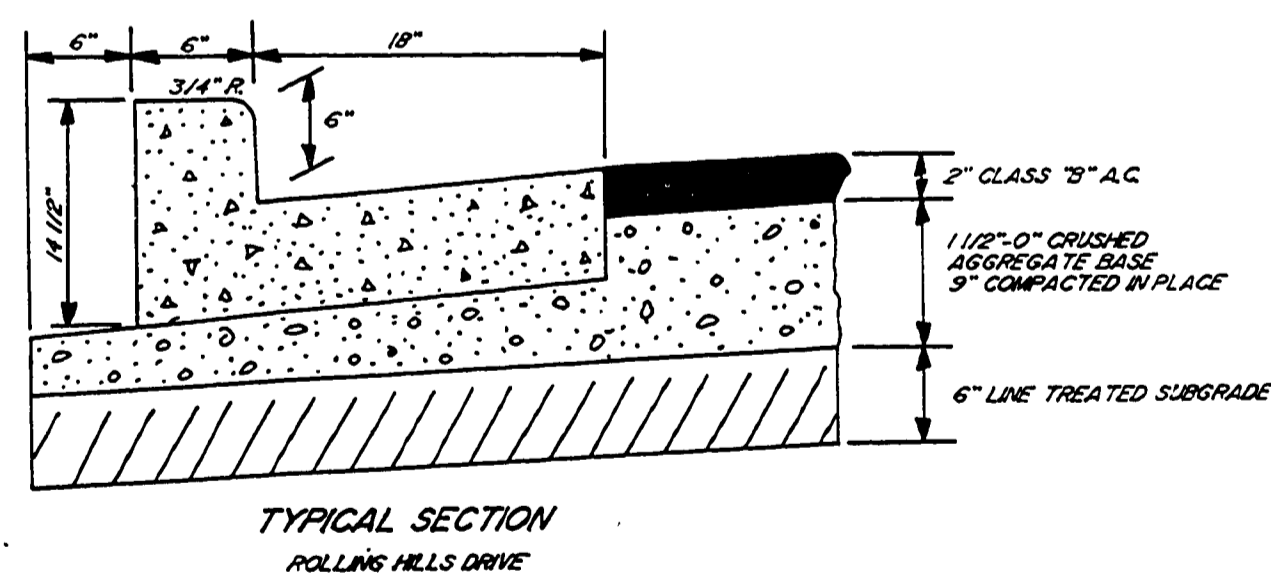

STORM SEWER PROFILE  
NOT PLOTTED - SEE PLAN ABOVE



DATE:	JULY 1988	DONALD A. BENTZ INC. P.O. BOX 901 WINCHESTER, OR 97495
DRAWN BY:	CB	
DESIGN:	DB & RS	ROLLING HILLS DRIVE CHAR STREET TO AUSTIN RD.
REV:		
		SHEET 2 OF 2

CO. RD. #366

RD366002

⑦