

RIVER CREST ESTATES PHASE 2 (61 lots)

ASBUILT PACKAGE GREEN DISTRICT, OREGON

FILED
Date: 10-18-2008 By: JC
This survey consists of:
Map:
Narrative:
Corner Rpt:
DOUGLAS COUNTY
SURVEYOR

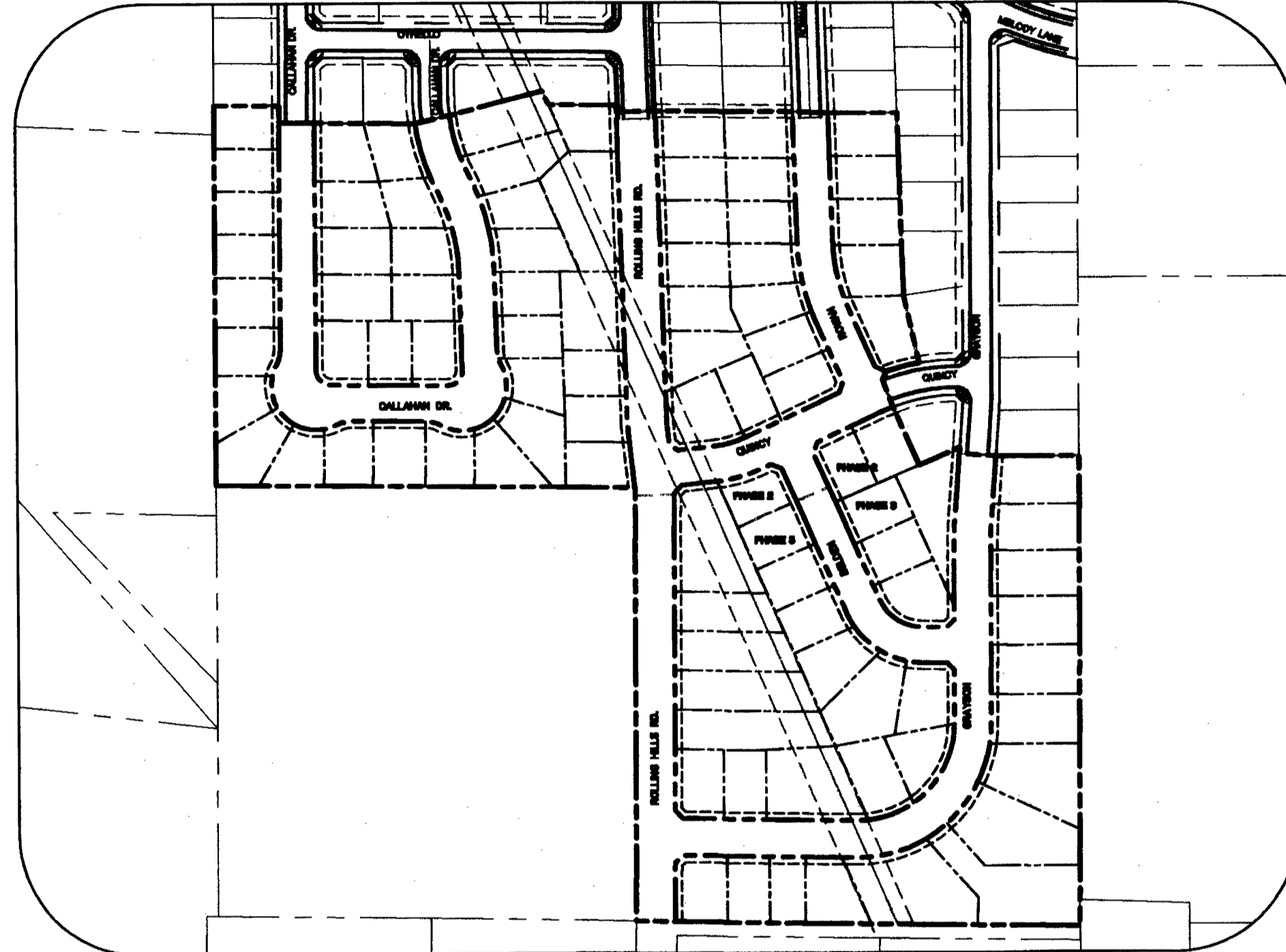

SITE MAP
NTS

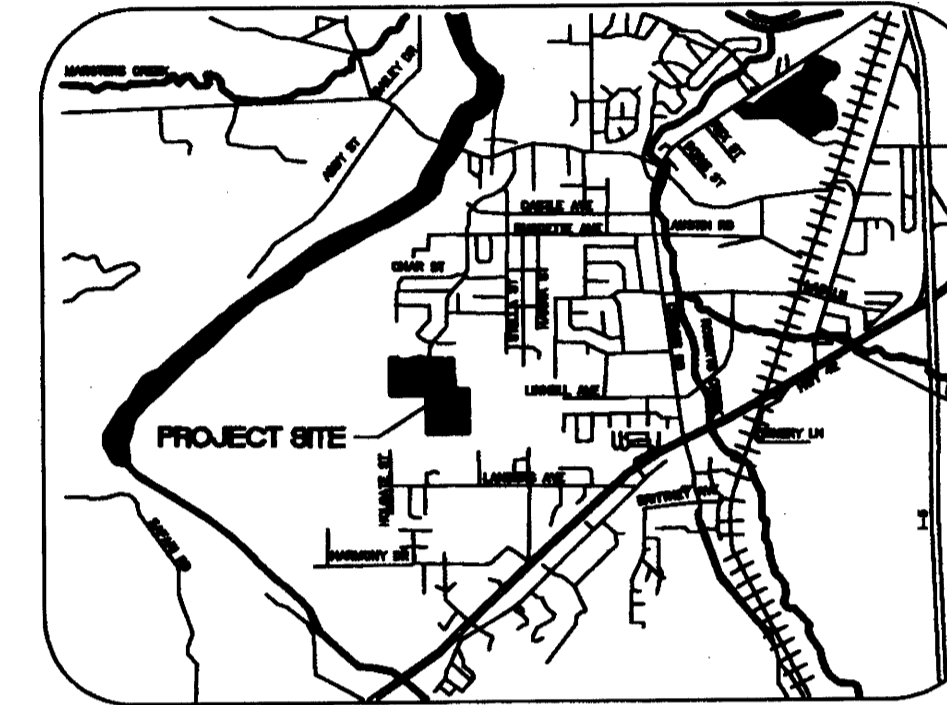

VICINITY MAP
NTS

CONTACTS

DEVELOPER

HAYDEN HOMES
ATTN: ROY HANKINS, PE
2484 SW GLACIER PLACE, SUITE 100
REDMOND, OR 97756
(541) 550-0718 (PHONE)

CIVIL ENGINEER

WRG DESIGN, INC.
ATTN: KEVIN RUSSELL, PE
5415 SW WESTGATE DR., SUITE 100
PORTLAND, OR 97221
(503) 419-2500 (PHONE)
(503) 419-2800 (FAX)

GEOTECH ENGINEER

NORTHWEST GEOTECH, INC.
9120 SW PIONEER COURT, SUITE B
WILSONVILLE, OR 97070
(503) 682-1880 (PHONE)
(503) 682-2753 (FAX)

JURISDICTION

DOUGLAS COUNTY
ATTN: DWAYNE ANDRY
ROOM 304, COURTHOUSE
1036 SE DOUGLAS AVE
ROSEBURG, OR 97470
(541) 440-4481 (PHONE)
(541) 484-8338 (FAX)

SANITARY

GREEN SANITARY DISTRICT
ATTN: BOB POAGUE
3878 OLD HWY 99 SOUTH
ROSEBURG, OR 97470
(541) 643-1153 (PHONE)
(541) 679-2080 (FAX)

GEOTECH ENGINEER

NORTHWEST GEOTECH, INC.
9120 SW PIONEER COURT, SUITE B
WILSONVILLE, OR 97070
(503) 682-1880 (PHONE)
(503) 682-2753 (FAX)

GAS

WILLIAMS GAS
ATTN: JIM LARRABEE, LARRY DAVIS
89881 GAME FARM RD
EUGENE, OR 97408
(541) 342-4434 (PHONE)
(541) 344-3675 (FAX)

WATER

ROBERTS CREEK WATER DISTRICT
ATTN: DOYLE TANKERSLEY
4336 OLD HIGHWAY 99 S
ROSEBURG, OR 97470 (541)
679-8451 (PHONE)

POWER

PACIFIC POWER
ATTN: BILL UNDLIN
4025 OLD HWY 99 SOUTH
ROSEBURG, OR 97470
(541) 679-3808 (PHONE)
(541) 679-3828 (FAX)

INDEX OF SHEETS

C8	COVER SHEET
C200	EXISTING CONDITIONS
C201	GRADING AND EROSION CONTROL PLAN
C202	NOTES AND DETAILS

STREET CONSTRUCTION PLANS

C203	375J	CALLAHAN ST. - STA 12+77.55 - 17+00.00
C204		CALLAHAN ST. - STA 17+00.00 - 19+50.00
C205		CALLAHAN ST. - STA 19+50.00 - 23+80.99
C206	366	ROLLING HILLS DR. - STA 17+41.53 - 23+15.79
C207	288D	ROWAN DR. - STA 22+53.85 - 27+94.89
C208	375P	QUINCY DR. - STA 3H+43.73 - 35+39.43
C209	375Q	BELDEN DR. - STA 2+00.00 - 2+96.17
C210		TYPICAL SECTIONS
C211		NOTES AND DETAILS
C212		NOTES AND DETAILS

STREET GRADING PLANS

C213	CALLAHAN ST. - STA 12+77.55 - 17+00.00
C214	CALLAHAN ST. - STA 17+00.00 - 19+50.00
C215	CALLAHAN ST. - STA 19+50.00 - 23+80.99
C216	ROLLING HILLS DR. - STA 17+41.53 - 23+15.79
C217	ROWAN DR. - STA 22+53.85 - 27+94.89
C218	QUINCY DR. - STA 3H+43.73 - 35+39.43
C219	BELDEN DR. - STA 2+00.00 - 2+96.17

STREET STORM SEWER PLANS

C220	CALLAHAN ST. - STA 12+77.55 - 17+00.00	0.18 - 0.26
C221	CALLAHAN ST. - STA 17+00.00 - 19+50.00	0.26 - 0.31
C222	CALLAHAN ST. - STA 19+50.00 - 23+80.99	0.31 - 0.39
C223	ROLLING HILLS DR. - STA 17+41.53 - 23+15.79	0.90 - 0.79
C224	ROWAN DR. - STA 22+53.85 - 27+94.89	0.07 - 0.17
C225	QUINCY DR. - STA 3H+43.73 - 35+39.43	0.05 - 0.08
C226	BELDEN DR. - STA 2+00.00 - 2+96.17	0.00 - 0.02
C227	NOTES AND DETAILS	

STREET SANITARY AND WATER PLANS

C228	CALLAHAN ST. - STA 12+77.55 - 17+00.00
C229	CALLAHAN ST. - STA 17+00.00 - 19+50.00
C230	CALLAHAN ST. - STA 19+50.00 - 23+80.99
C231	ROLLING HILLS DR. - STA 17+41.53 - 23+15.79
C232	ROWAN DR. - STA 22+53.85 - 27+94.89
C233	QUINCY DR. - STA 3H+43.73 - 35+39.43
C234	BELDEN DR. - STA 2+00.00 - 2+96.17
C235	SANITARY NOTES AND DETAILS
C236	WATER NOTES AND DETAILS
C237	WATER DETAILS

UTILITIES RELOCATION REQ. - OREGON LAW REQUIRES FOLLOWING THE RULES ADOPTED BY THE OREGON UTILITY NOTIFICATION CENTER. SAID RULES ARE SET FORTH IN OAR 852-001-0010 THRU OAR 852-001-0090. COPIES OF THE RULES MAY BE OBTAINED FROM THE CENTER BY CALLING (503)-232-1987. IF YOU HAVE QUESTIONS ABOUT THE RULES, CONTACT THE CENTER. NOTE: DAMAGE TO UTILITIES SHALL BE CORRECTED AT THE PERMIT HOLDERS EXPENSE.

OREGON UTILITY
NOTIFICATION CENTER
1-800-332-2344



COVER SHEET
RIVER CREST ESTATES - PHASE 2
HAYDEN HOMES
Green District, Oregon

AS-BUILT

BASED ON CHANGES
IDENTIFIED DURING
CONSTRUCTION
AS OF 3/7/08

REGISTERED PROFESSIONAL
ENGINEER
KEVIN S. RUSSELL
EXPIRES: 12-31-08

DATE: 11/03/08
DRAWN: MDG
DESIGNED: MDG
CHECKED: KBR
PROJECT #: HAY0800

SHEET TITLE
COVER SHEET

SHEET NUMBER
CS
OF 8 SHEETS