

SEC. 15, T28S, R6W, W.M.

FILED
RECEIVED *ES*
APR 20 1983
COUNTY SURVEYOR
DOUGLAS COUNTY, ORE.

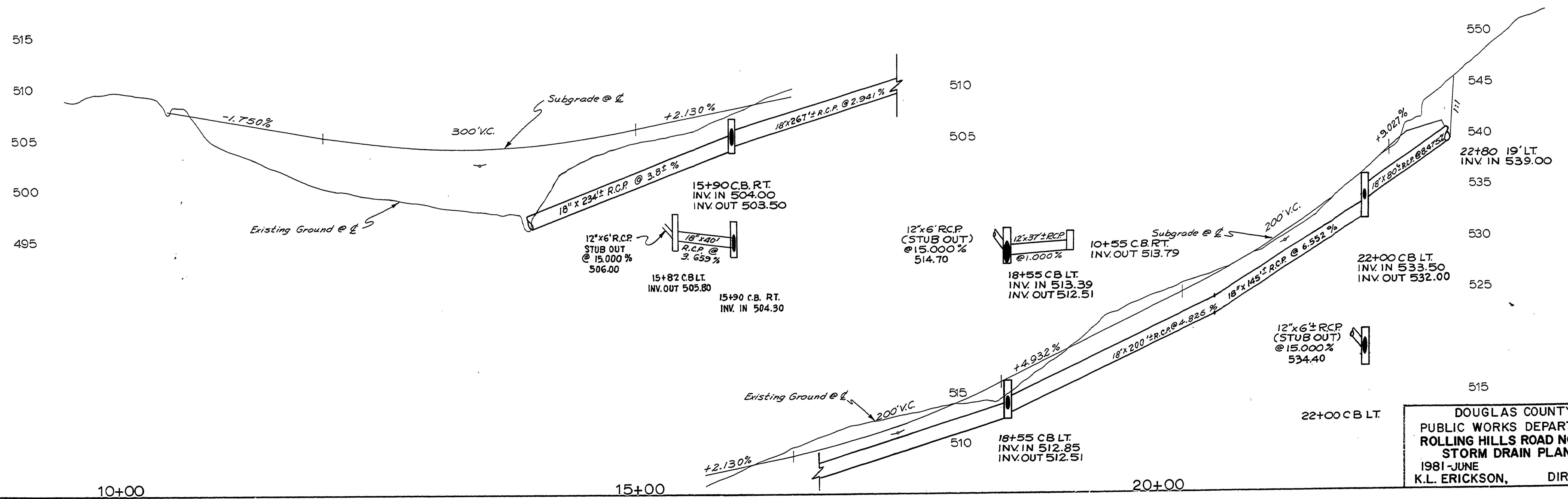
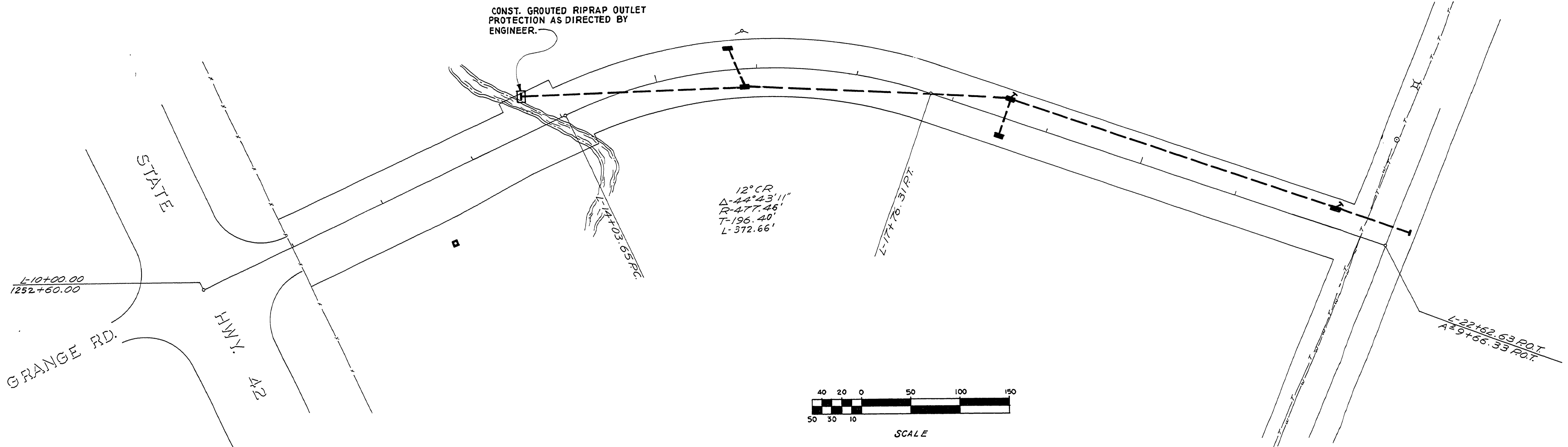

DOUGLAS COUNTY
PUBLIC WORKS DEPARTMENT
ROLLING HILLS ROAD NO. 366
STORM DRAIN PLAN
1981-JUNE SHT. 6
K.L. ERICKSON, DIRECTOR