

AS BUILT

FILED
AUG 10 1967
COUNTY SUPERVISOR
DOUGLAS COUNTY, ORE.

STREET	STA	TOP OF CURB LT	± F.G.	TOP OF CURB RT
CHANDLER DR.		0.00	0.00	0.00
ASPEN CT.		-0.16	0.00	+1.08
ASH ST.	0+00 TO 3+14.70	0.00	0.00	0.00
ASH ST.	3+14.70 TO 5+14.70	-0.16	0.00	+1.08
PEPPER TREE CT.		-0.16	0.00	+1.08
QUINCE CT.	0+00 TO 0+35.00	-0.16	0.00	+1.08
QUINCE CT.	7+00.50 TO 7+30.00	VAR	0.00	VAR

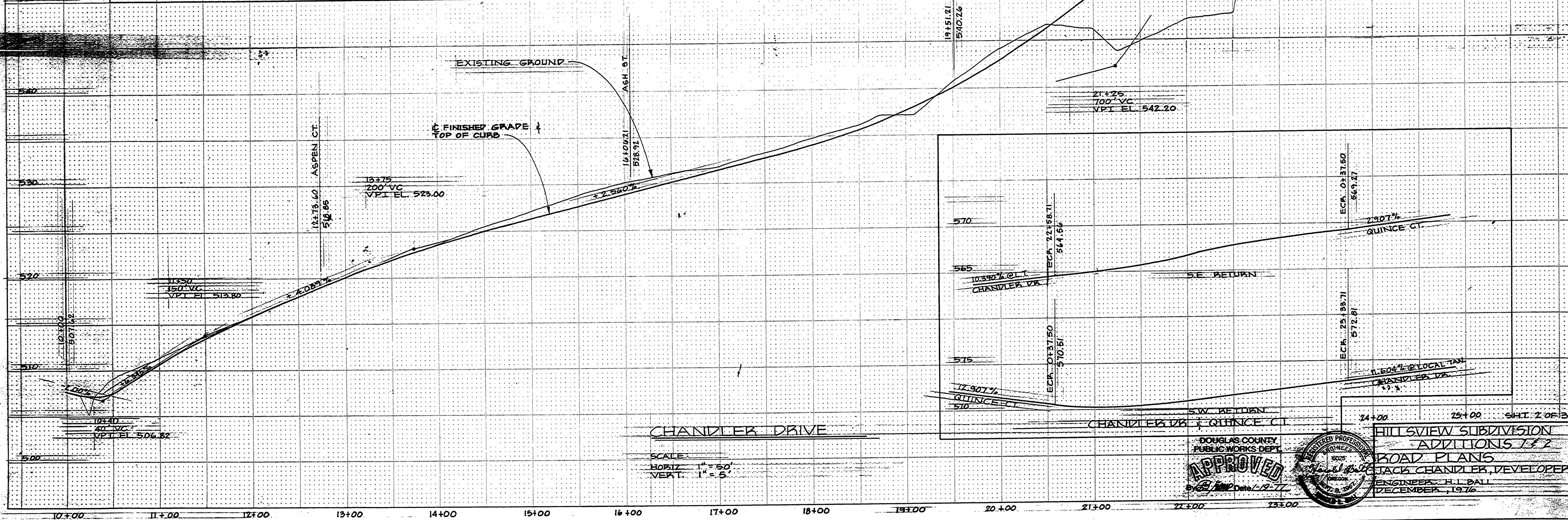
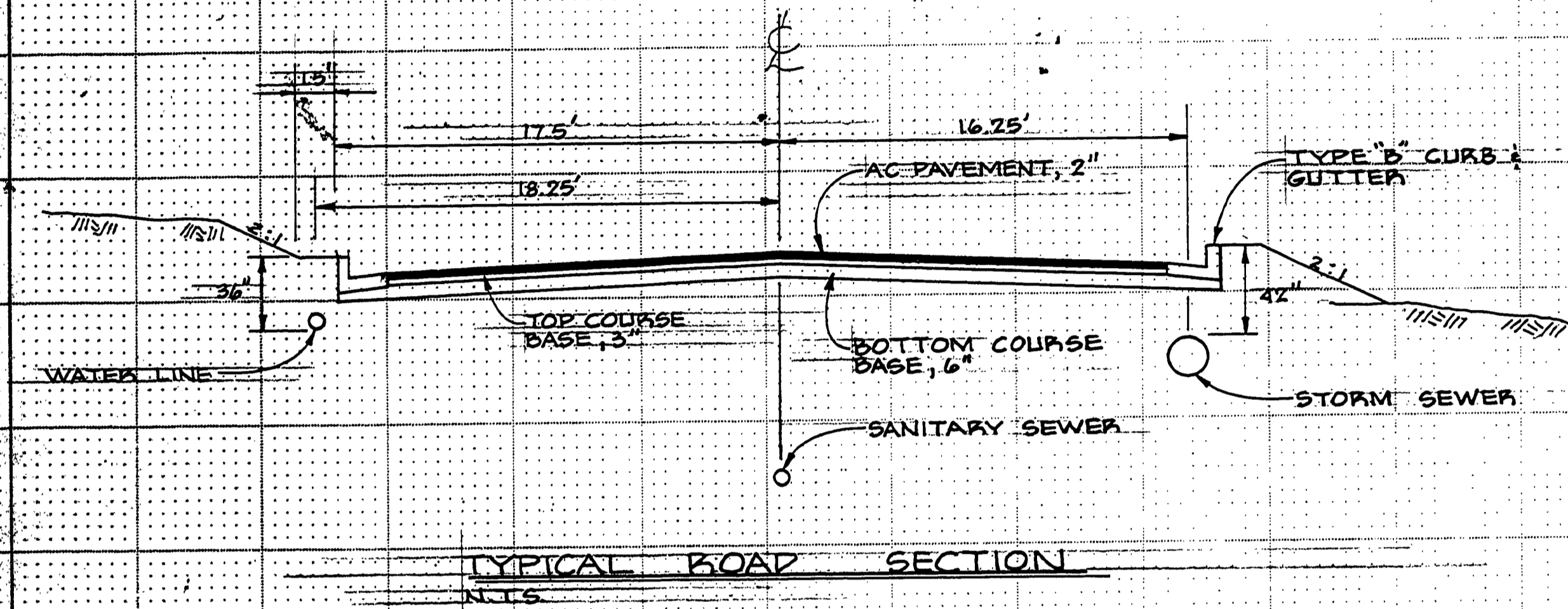
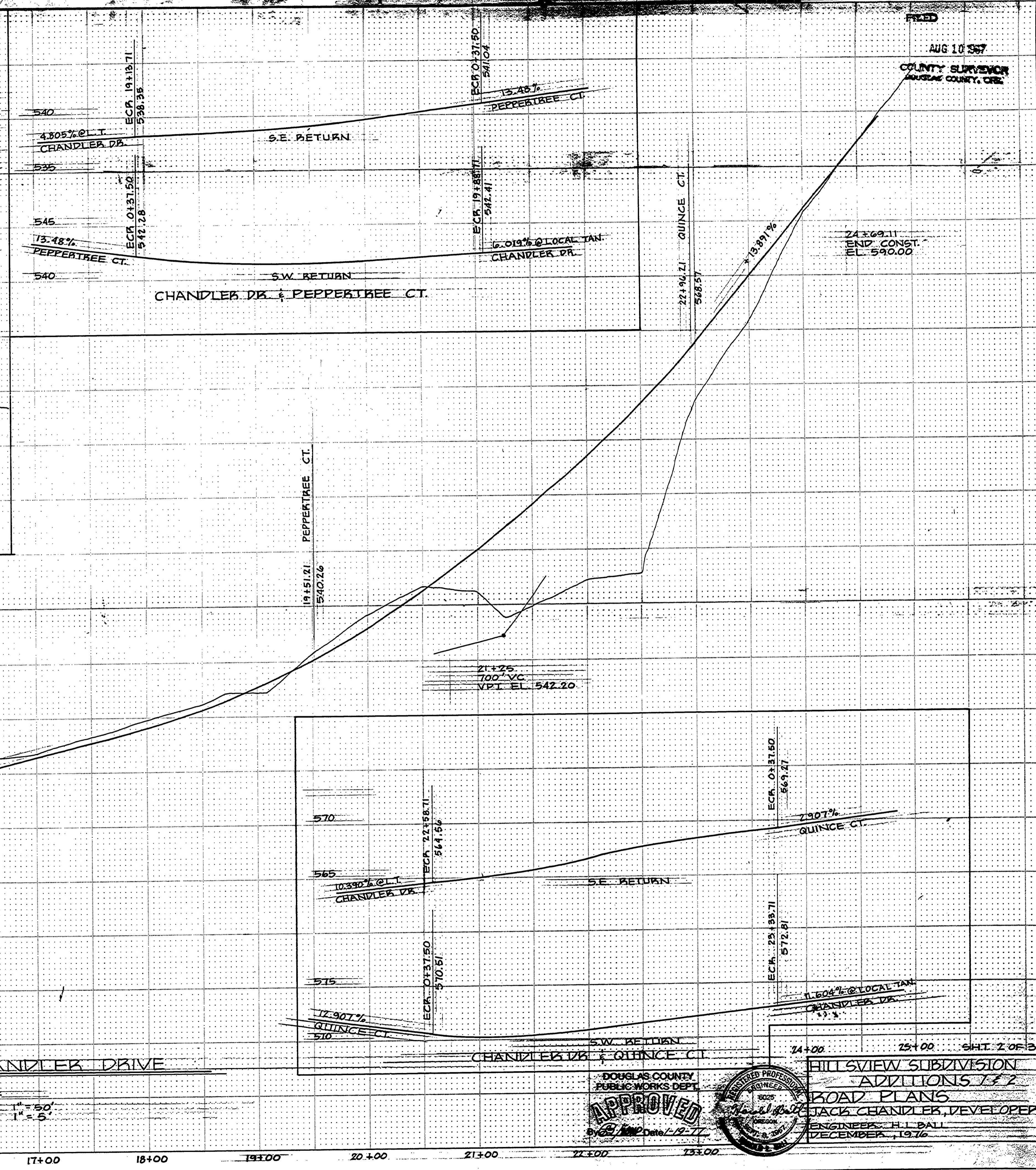

CHANDLER DRIVE

SCALE
HORIZ. 1" = 50'
VERT. 1" = 5'

APPROVED

DOUGLAS COUNTY
PUBLIC WORKS DEPT.

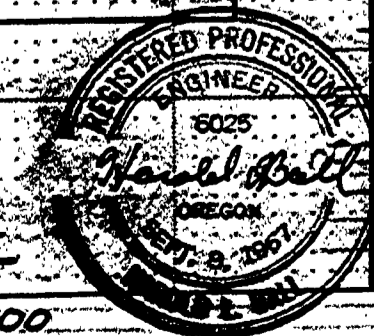

HILL VIEW SUBDIVISION
ADDITIONS 1 & 2
ROAD PLANS
JACK CHANDLER, DEVELOPER
ENGINEER H.L. BALL
DECEMBER, 1916