

Sec. 25, T27S, R6W, W.M.

FILED
RECEIVED
COUNTY SURVEYOR
DOUGLAS COUNTY, ORE.

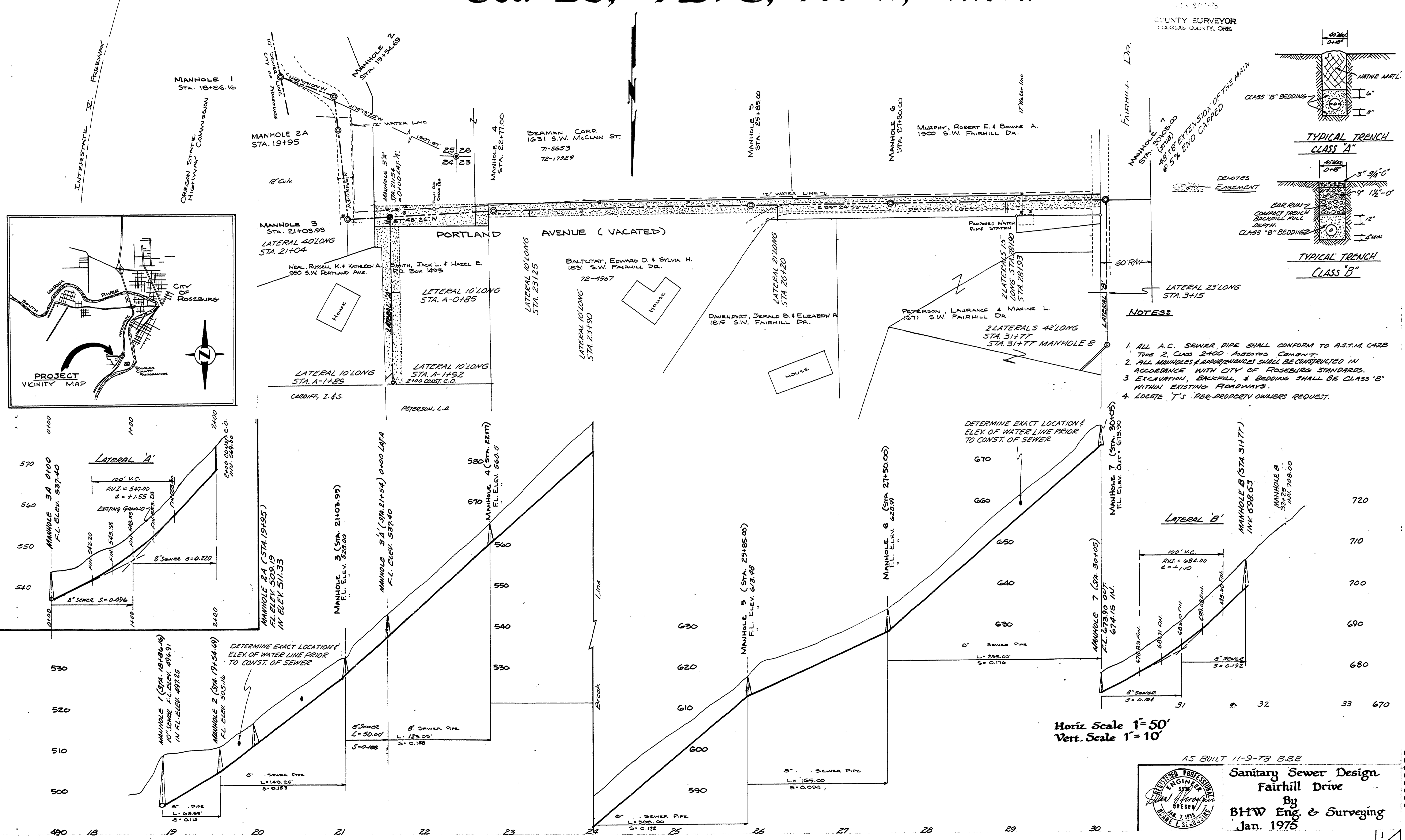

AS BUILT 11-9-78 B.B.B.

Sanitary Sewer Design
Fairhill Drive
 By
BHW Eng. & Surveying
 Jan. 1975

00000032