

DOUGLAS COUNTY, OREGON  
 PLANS FOR PROPOSED CONSTRUCTION PROJECT  
 GRADING, SURFACING & STORM DRAINS

SADDLE BUTTE HOMESITES NO. 1  
 ROAD NO. 335  
 1973

FILED  
 Date: 1-31-77 By: J.P.  
 This survey consists of:  
 Map:  
 Narrative:  
 Corner Pts.:  
 DOUGLAS COUNTY  
 SURVEYOR

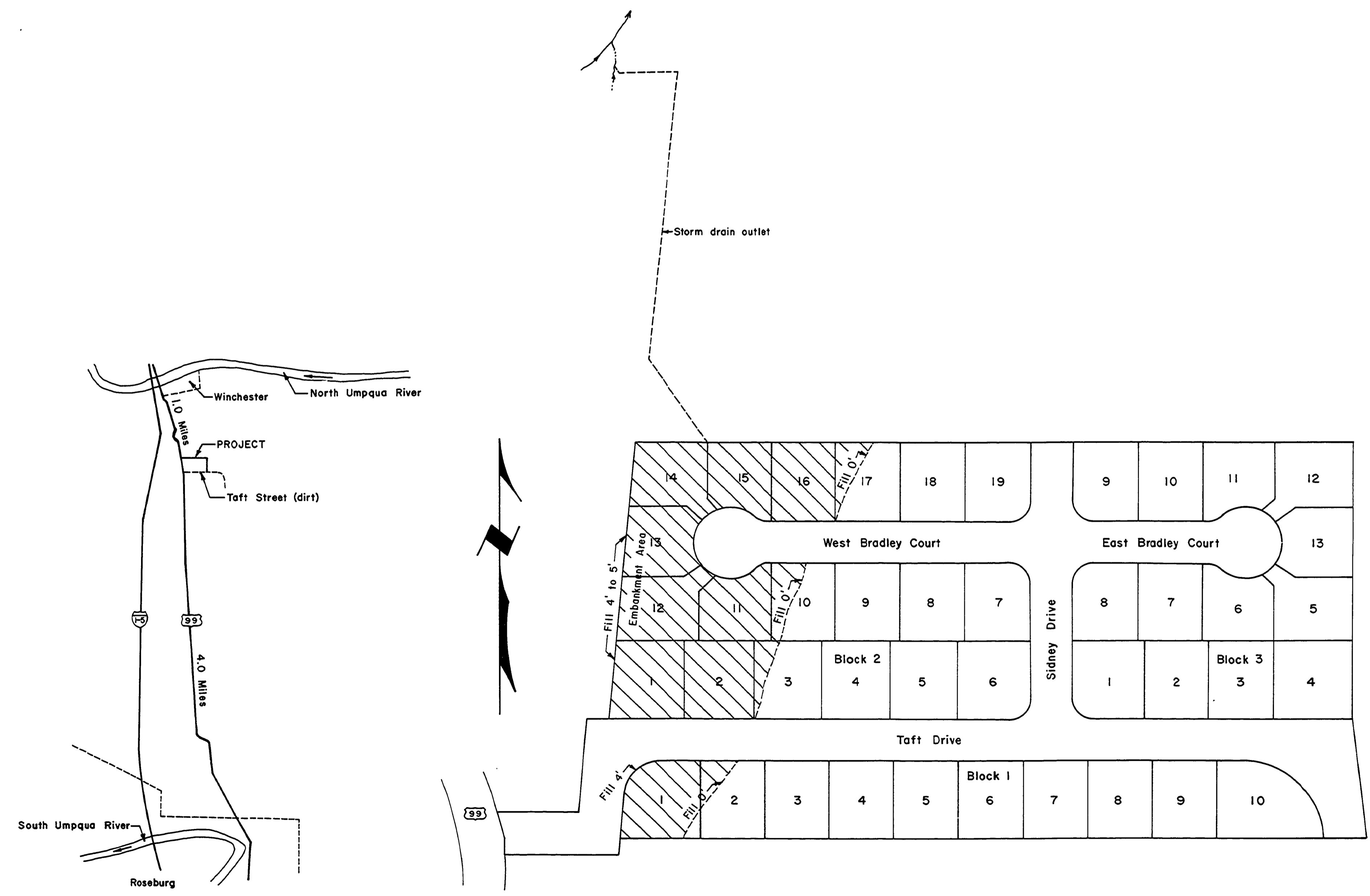
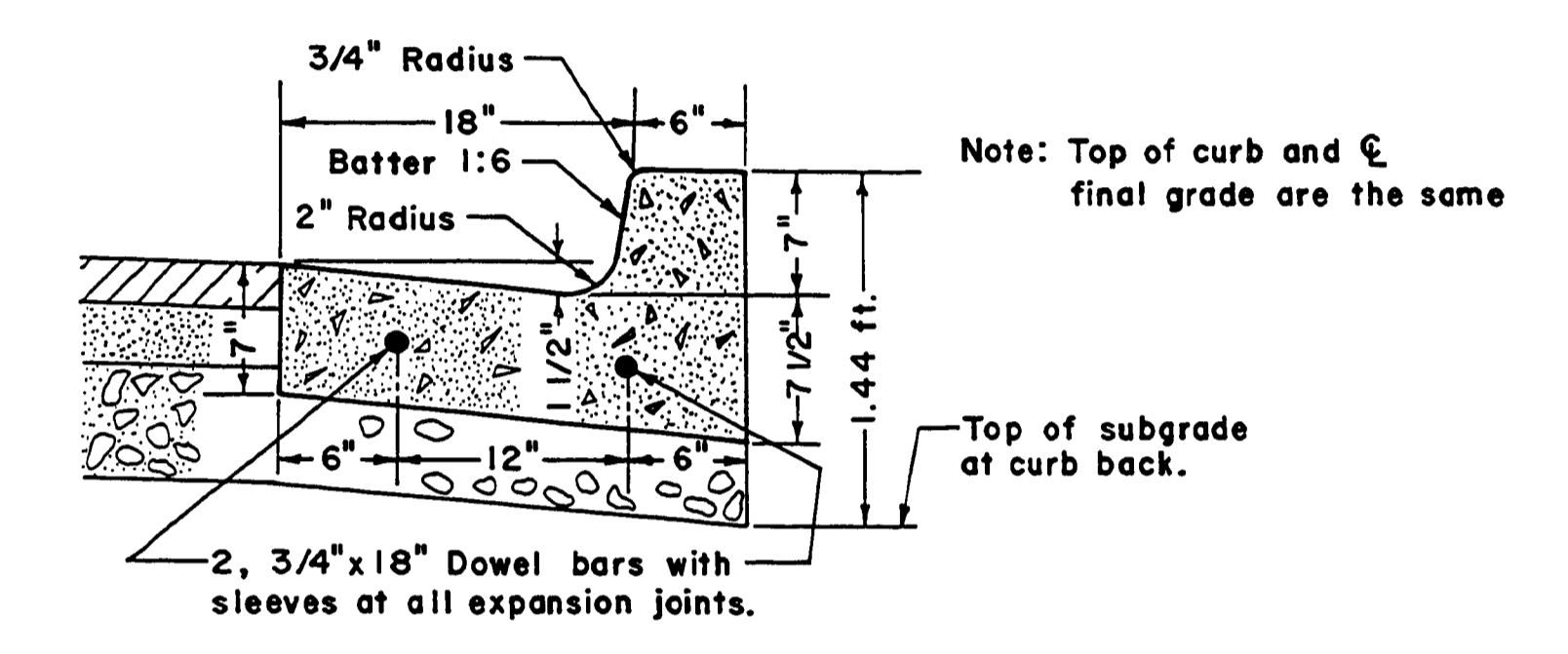
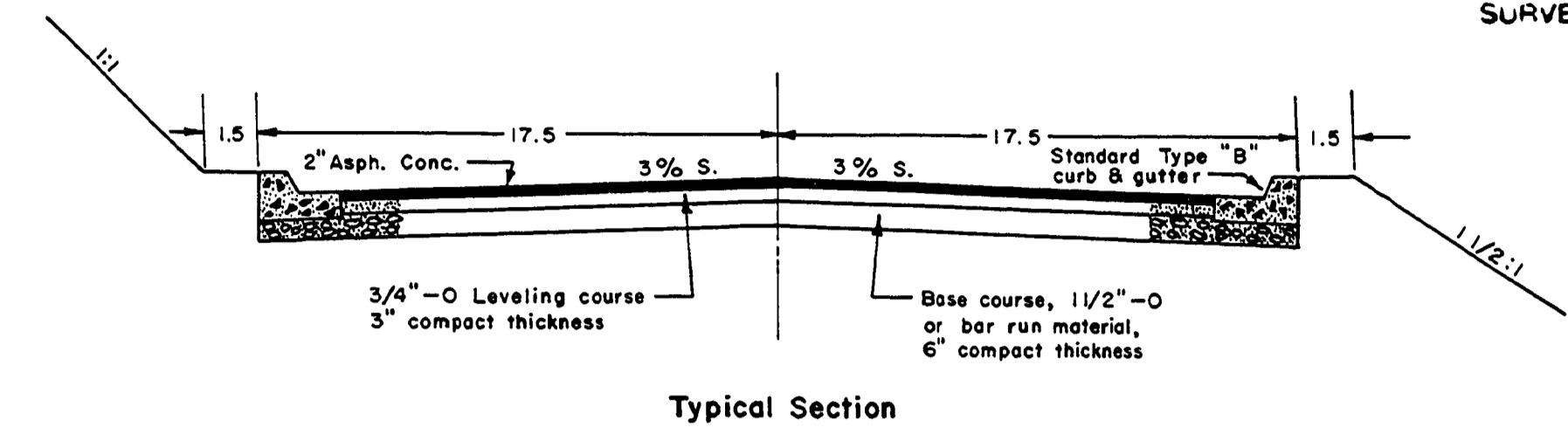

Sheet Index	
Sheet No.	Description
1	Title Sheet
2	Quantity Summary
3-6	Plan & Profile
2, 3, 4 & 9	Standard Drawings
10 Shts.	TOTAL

433 SF M4WC

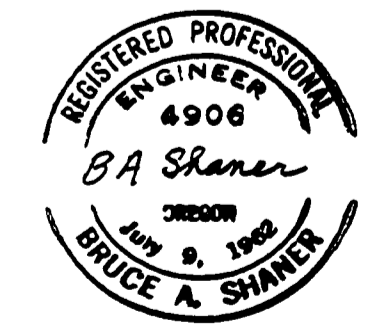

NOTE: RECD SHEETS 1, 3, 4, 5, 6

DOUGLAS COUNTY ROAD DEPT.  
 SADDLE BUTTE HOMESITES NO. 1 RD. NO. 335  
 May, 1973 Sheet No. 1  
 George E. Grubb, County Engr.

ROAD0335