

SCALE: 1" = 50'

- NOTES:
1. ALL WORK SHALL BE IN CONFORMANCE WITH DOUGLAS COUNTY DEPT OF PUBLIC WORKS STANDARDS, DETAILS AND SPECIFICATIONS.
 2. DOUGLAS COUNTY RESERVES THE RIGHT TO REQUIRE ROCK RIP RAP OR OTHER BANK PROTECTION ON UPSTREAM AND/OR DOWNSTREAM FACES OF 108" AND 60" CULVERTS UPON REVIEW AFTER COMPLETION OF CONSTRUCTION.
 3. ALL CMP CULVERTS SHALL BE GALVANIZED AND ASPHALT COATED.
 4. CULVERT BACKFILL SHALL BE PERFORMED STRICTLY IN COMPLIANCE WITH STANDARD SPECIFICATIONS AND MANUFACTURER'S RECOMMENDATIONS ESPECIALLY AS TO EQUAL PLACEMENT AND COMPACTION OF FILL AND TEMPORARY CULVERT WALL SUPPORTS.

TYPICAL SECTION

FILED
AUG 10 1987
COUNTY SURVEYOR
DOUGLAS COUNTY, ORE.

CURVE DATA

- | | |
|--|---|
| ① D=30° L
Δ=28°30'53"
R=190.99
T=48.53
L=95.05
PC=21+64.82
PT=22+59.27 | ③ D=6° R
Δ=15°33'28"
R=955.37
T=130.51
L=259.30
PC=28+86.44
PT=31+45.21 |
| ② D=16° R
Δ=40°48'02"
R=358.10
T=133.96
L=255.00
PC=23+84.88
PT=26+39.88 | ④ D=32° L
Δ=26°33'35"
R=179.05
T=42.26
L=83.00
PC=0+29.30
PT=1+12.30 |

PLAN
DATE CHECKED
DATE REVISION
NO.

PROFILE
DATE CHECKED
DATE REVISION
NO.

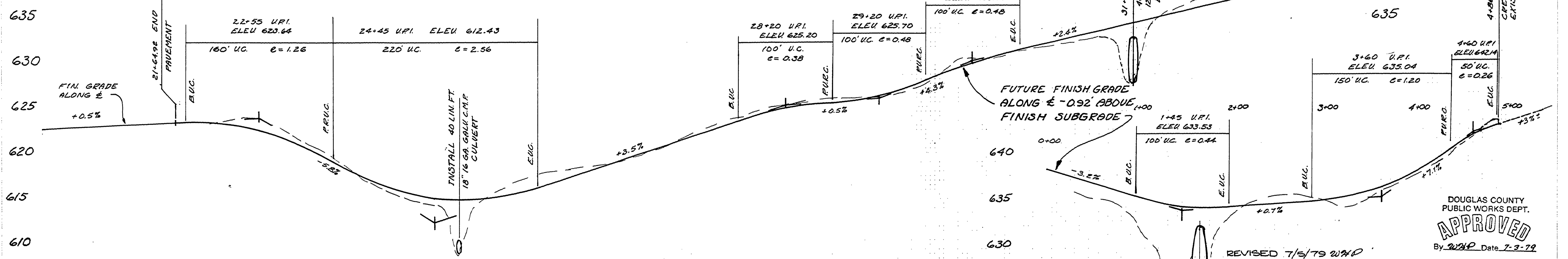
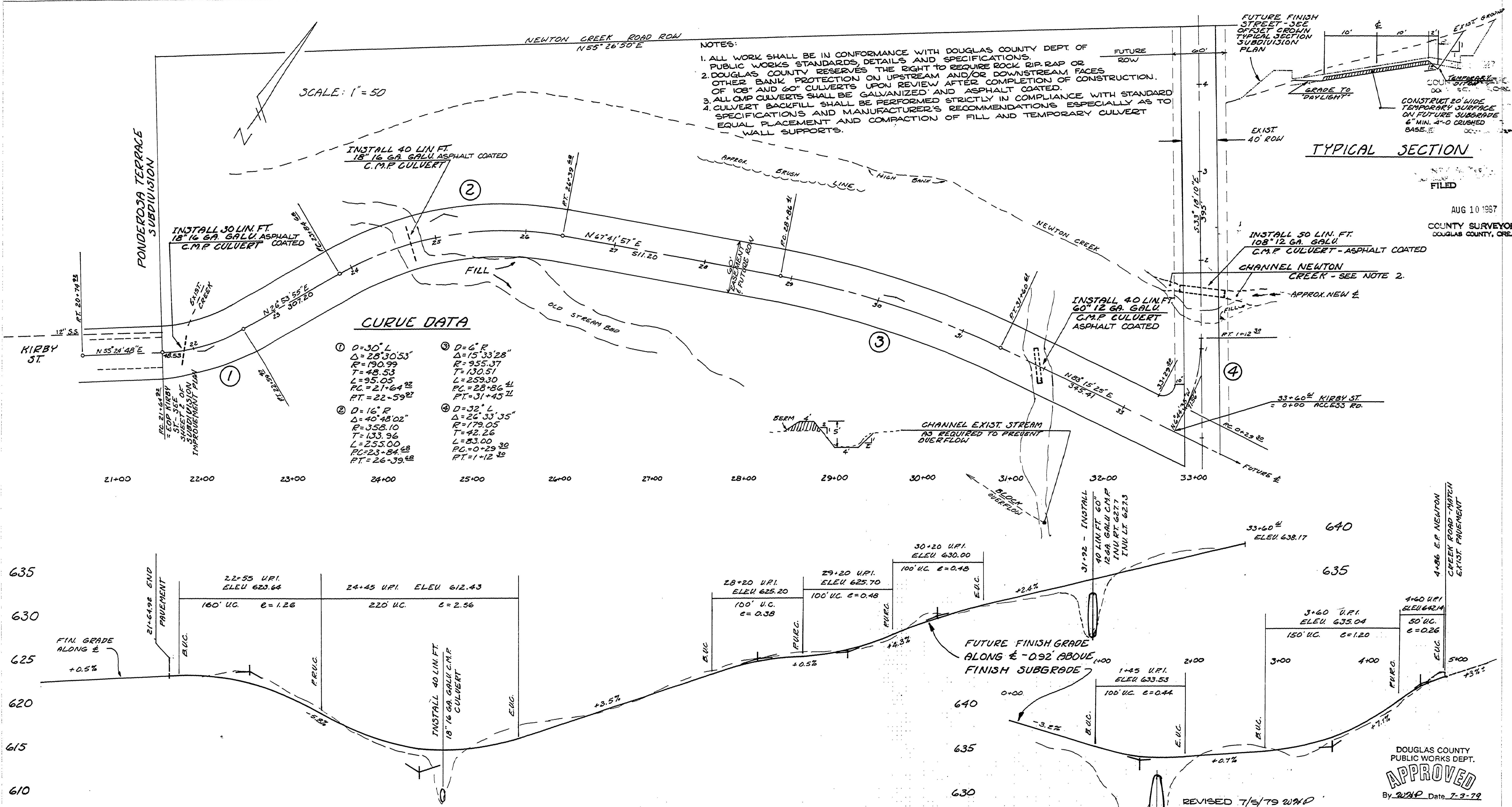

1+65 - INSTALL 50 LIN. FT. 108" 12 GA. GALV. C.M.P. CULVERT
INU. RT. 623.0
INU. LT. 622.5

REVISED 7/5/79 WHP

KIRBY ST. EXTENSION

PONDEROSA TERRACE & SPURLING ESTATES ROSEBURG, OREGON

BHW ENGINEERING & SURVEYING
1205 S.E. OR 97470
TEL 673-0165 ROSEBURG, OR

DATE: 6/79
DRAWN BY: H. GRUBS
CHECKED: D.L.S.
JOB NO: TB-205
SHEET NO: 1
OF 1 SHEETS

00240000