

SEC. 6 & 7, T27S, R5W, W.M.

FILED  
RECEIVED  
AUG 1 1978  
SURVEYOR  
OREGON

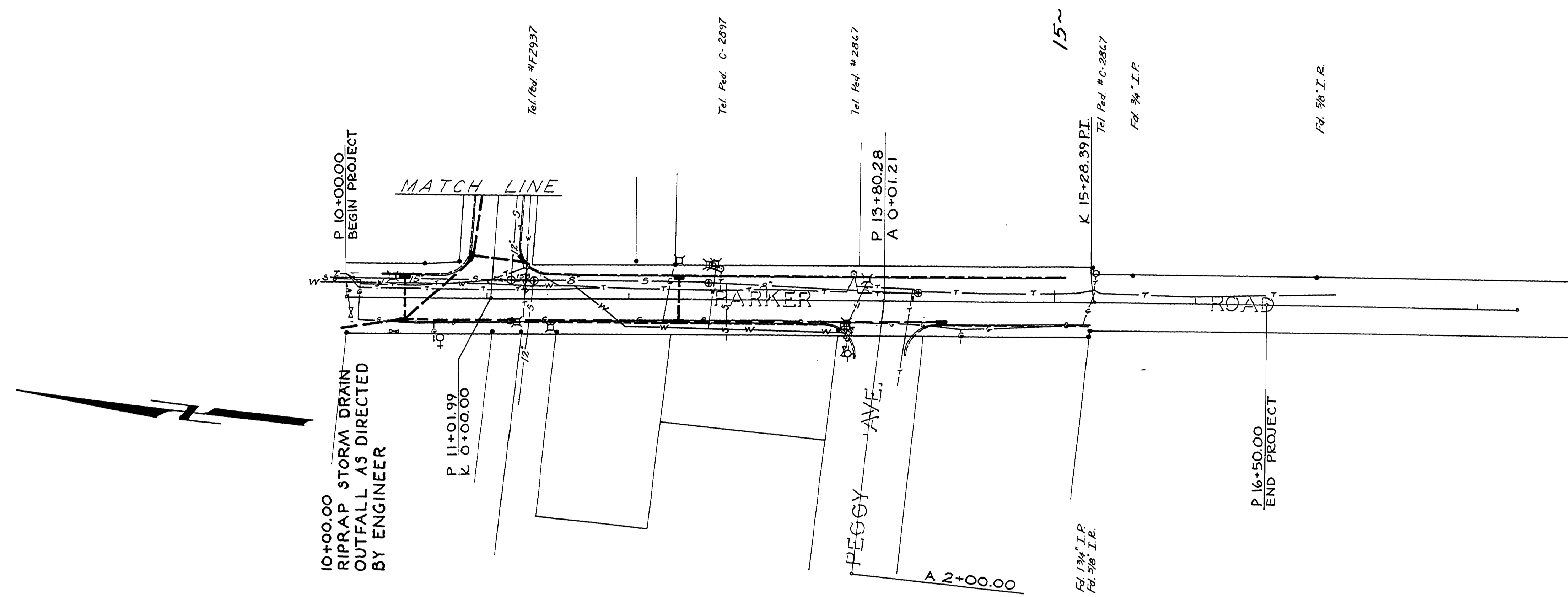

NOTE: VERIFY LOCATION OF EXISTING UNDERGROUND UTILITIES AT POTENTIALLY CONFLICTING LOCATIONS

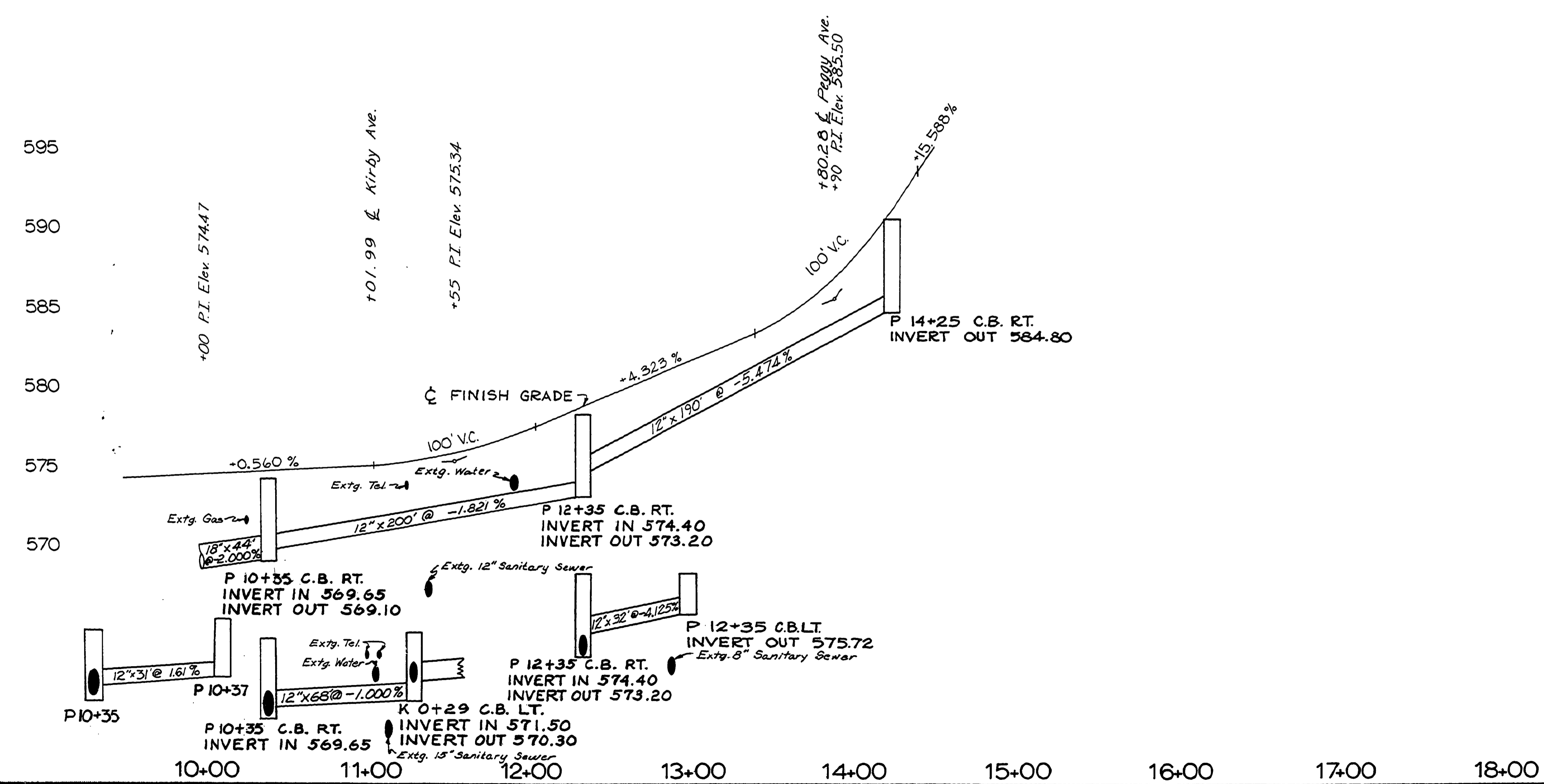

AS BUILT 7/31/79 L.L.  
DOUGLAS COUNTY  
PUBLIC WORKS DEPARTMENT  
PARKER RD., KIRBY AVE. &  
SHARON CT. RD. 322  
1978 SHT. 5  
GEORGE E. GRUBB, DIRECTOR

00040017