

W.B. & DORIS GARRETT  
 1/04 P.105 - 1/204 P.583  
 Und. 1/2 Interest  
 AMANDA GARRETT (Trustee W.B. GARRETT)  
 1/283 P.512  
 Und. 1/2 Interest

PROFILES  
 NOTE BOOK  
 NO. 1153  
 SHEET NO. 1153

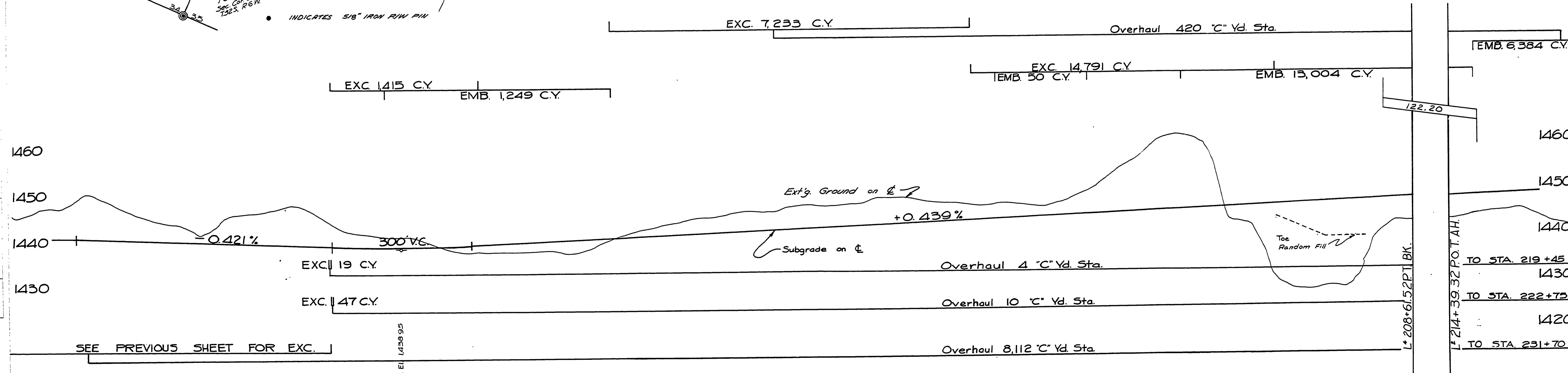

Douglas County Road Dept.  
 GLENDALE VALLEY RD. #313  
 Date: Aug. 1969 Sheet 10  
 GEORGE E. GRUBB County Eng.

REVISED AS CONSTRUCTED Aug '69  
 G.R.D. # 313

01610211