

# DOUGLAS COUNTY OREGON

## PLANS FOR PROPOSED PROJECT

### GRADING & SURFACING & STORM SEWER

# STEWART PARKWAY

## COUNTY ROAD NO. 308

### 1975

FILED  
RECEIVED  
JAN 12 1977  
COUNTY SURVEYOR  
DOUGLAS COUNTY, ORE.

#### INDEX OF DRAWING

SHEET NO.

- 1 - COVER SHEET
- 2 - UNIT "A" QUANTITY SUMMARY
- 3 - UNIT "B" QUANTITY SUMMARY
- 4 - STATE HIGHWAY #234 INTERSECTION DETAILS
- 5 - ROAD TYPICALS
- 6-7 - ROAD PLANS
- 8 - "M"-LINE DETAILS
- 9 - AIRPORT ST. ROAD PLANS
- 10 - UNIT "C" QUANTITY SUMMARY
- 11 - ROAD TYPICALS
- 12-14 - ROAD PLANS
- 15 - GARDEN VALLEY INTERSECTION DETAIL
- 16 - TYPICAL GUARD RAIL BRIDGE CONNECTION
- 17 - AIRPORT RD. OVERLAY PLANS, TYPICALS & QUANTITY SUMMARY

STANDARD DRAWINGS 2,3,5,8,9  
TOTAL OF 21 SHEETS

#### LEGEND

- UNIT A STA. L-9+98.30 TO STA. L-19+33 LENGTH- 0.18 MI.
- UNIT B STA. L-19+33 TO STA. L-47+36.29 P.O.T. LENGTH- 0.78 MI.
- UNIT C STA. L-9+50.00 TO STA. L-63+30 LENGTH- 1.30 MI.
- AIRPORT ROAD NO. 171 STA. L-2+65 TO STA. L-14+10 LENGTH- 0.22 MI.

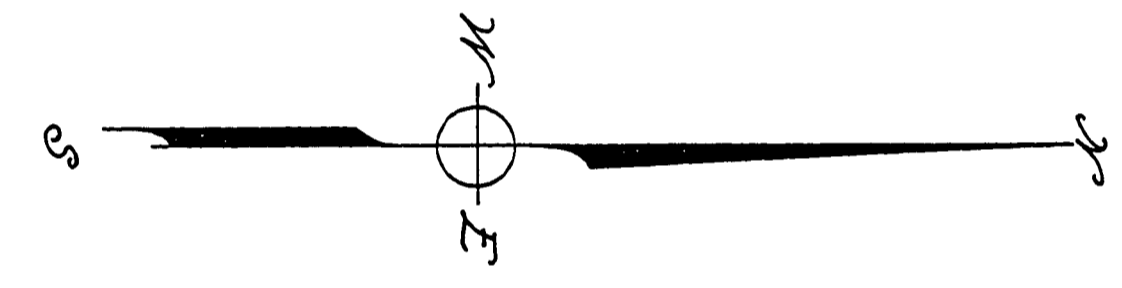
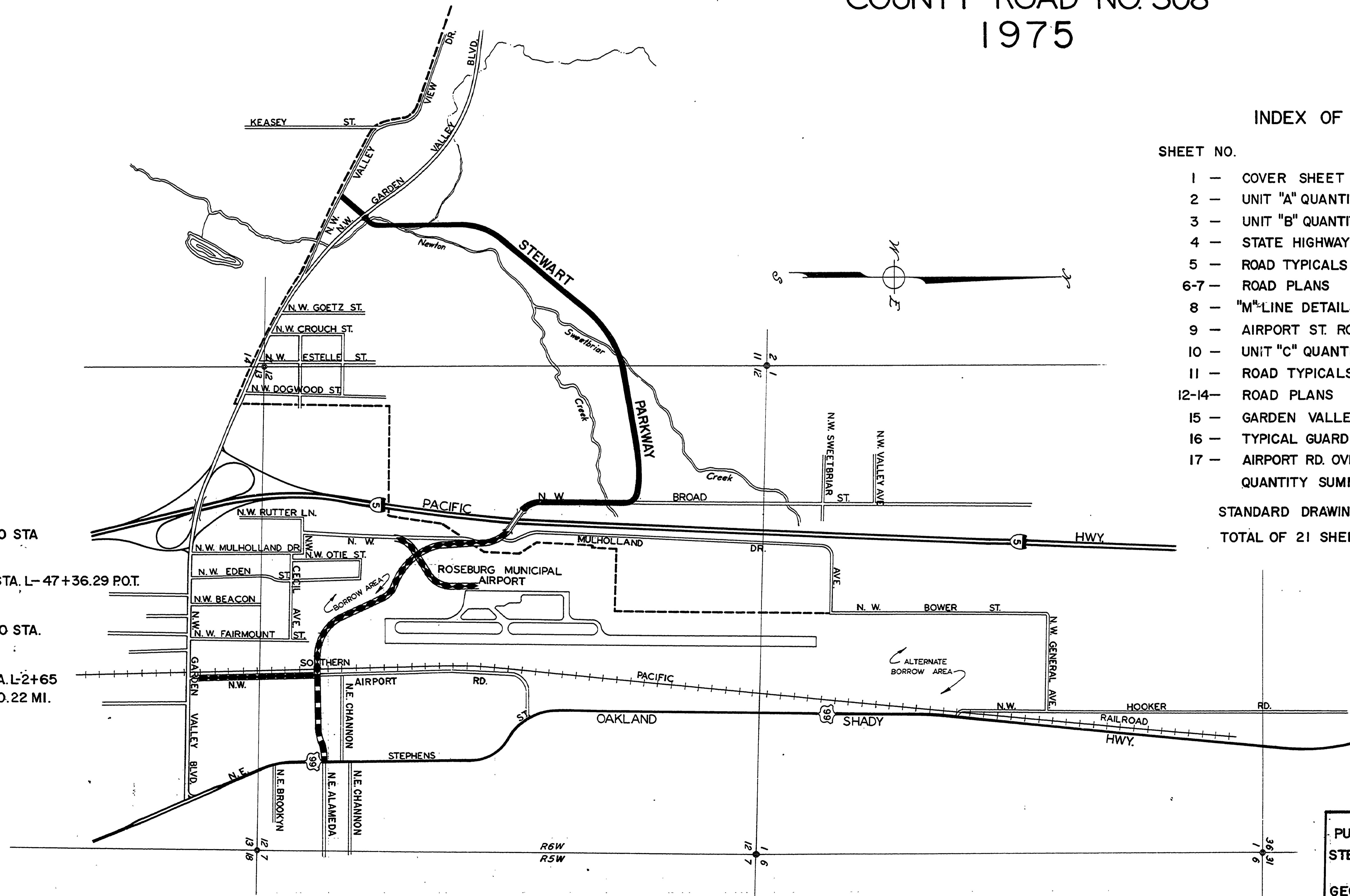

AS CONSTRUCTED  
JW 11-1-77

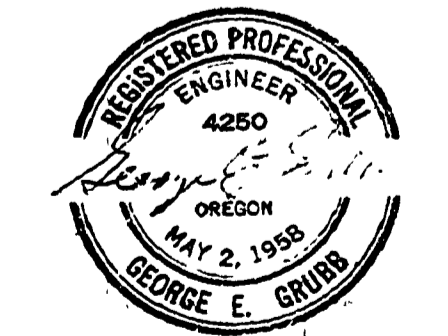

DOUGLAS COUNTY  
PUBLIC WORKS DEPARTMENT  
STEWART PARKWAY ROAD 308  
1975 SHT. 1  
GEORGE E. GRUBB, DIRECTOR

Co. Rd # 308 1975  
sht. 1

RD30800C