

FILED
RECEIVED
JAN 9 1977
COUNTY SURVEYOR
DOUGLAS COUNTY, ORE

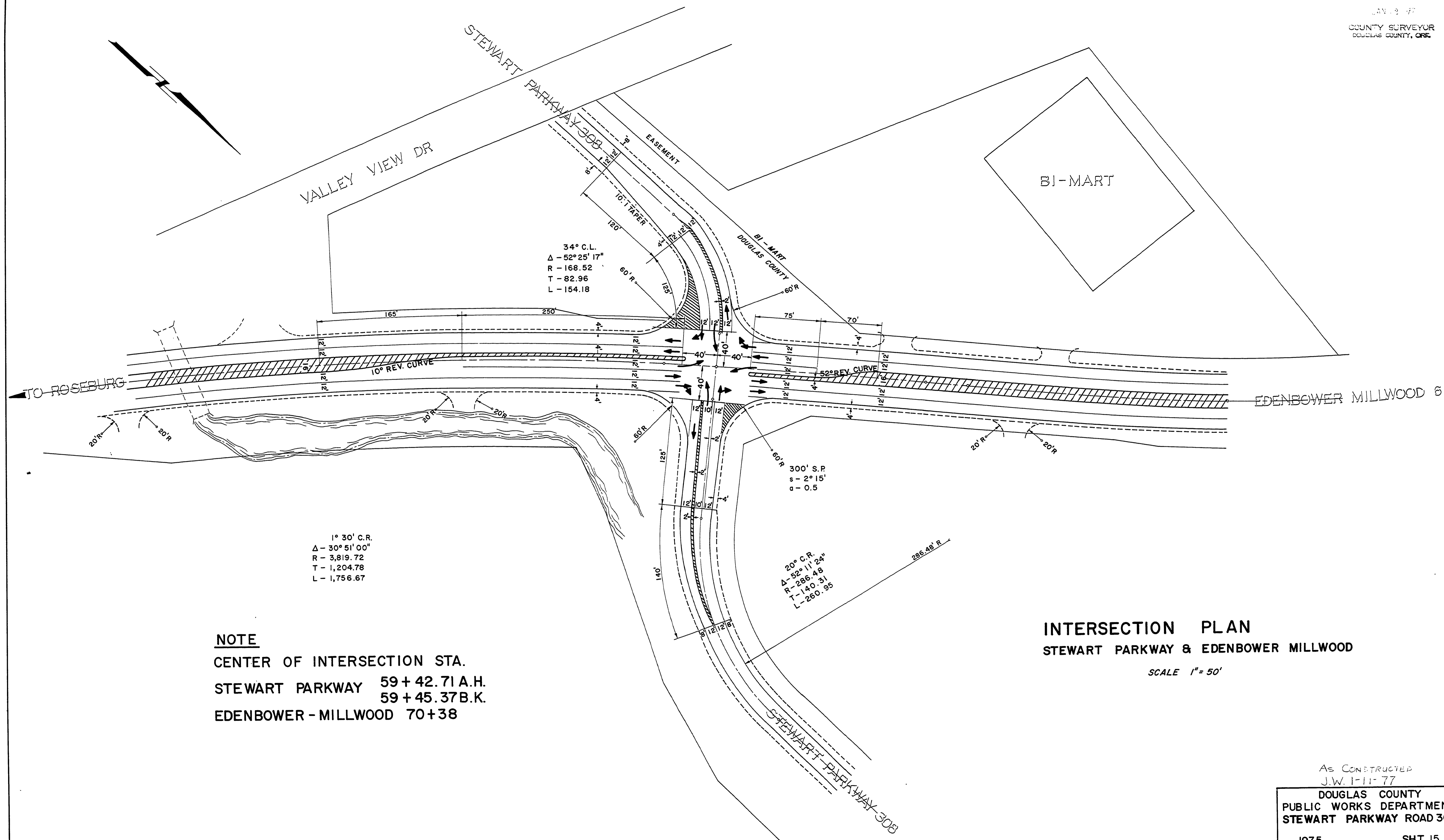

34° C.L.
Δ - 52° 25' 17"
R - 168.52
T - 82.96
L - 154.18

1° 30' C.R.
Δ - 30° 51' 00"
R - 3,819.72
T - 1,204.78
L - 1,756.67

20° C.R.
Δ - 52° 11' 24"
R - 286.48
T - 140.31
L - 260.95

300' S.P.
s - 2° 15'
a - 0.5

NOTE
CENTER OF INTERSECTION STA.
STEWART PARKWAY 59+42.71 A.H.
59+45.37 B.K.
EDENBOWER - MILLWOOD 70+38

INTERSECTION PLAN
STEWART PARKWAY & EDENBOWER MILLWOOD

SCALE 1" = 50'

AS CONSTRUCTED
J.W. 1-11-77
DOUGLAS COUNTY
PUBLIC WORKS DEPARTMENT
STEWART PARKWAY ROAD 308
1975 SHT. 15
GEORGE E. GRUBB, DIRECTOR

M.P. 2-05-1-98

G. RD. # 308

1975
SHT. 15

02050198