

SEC. 12 T 27 S R 6 W WM

RD. 308

FILED
RECEIVED

COUNTY CLERK
DOUGLAS COUNTY, ORE.

CITY OF ROSEBURG

SEE SHEET No. 8
FOR "M" LINE CONSTRUCTION
DETAILS

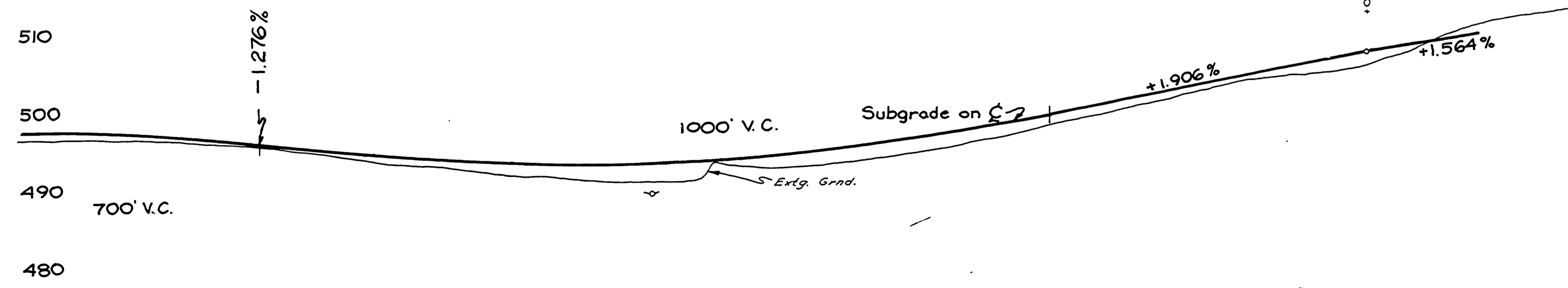
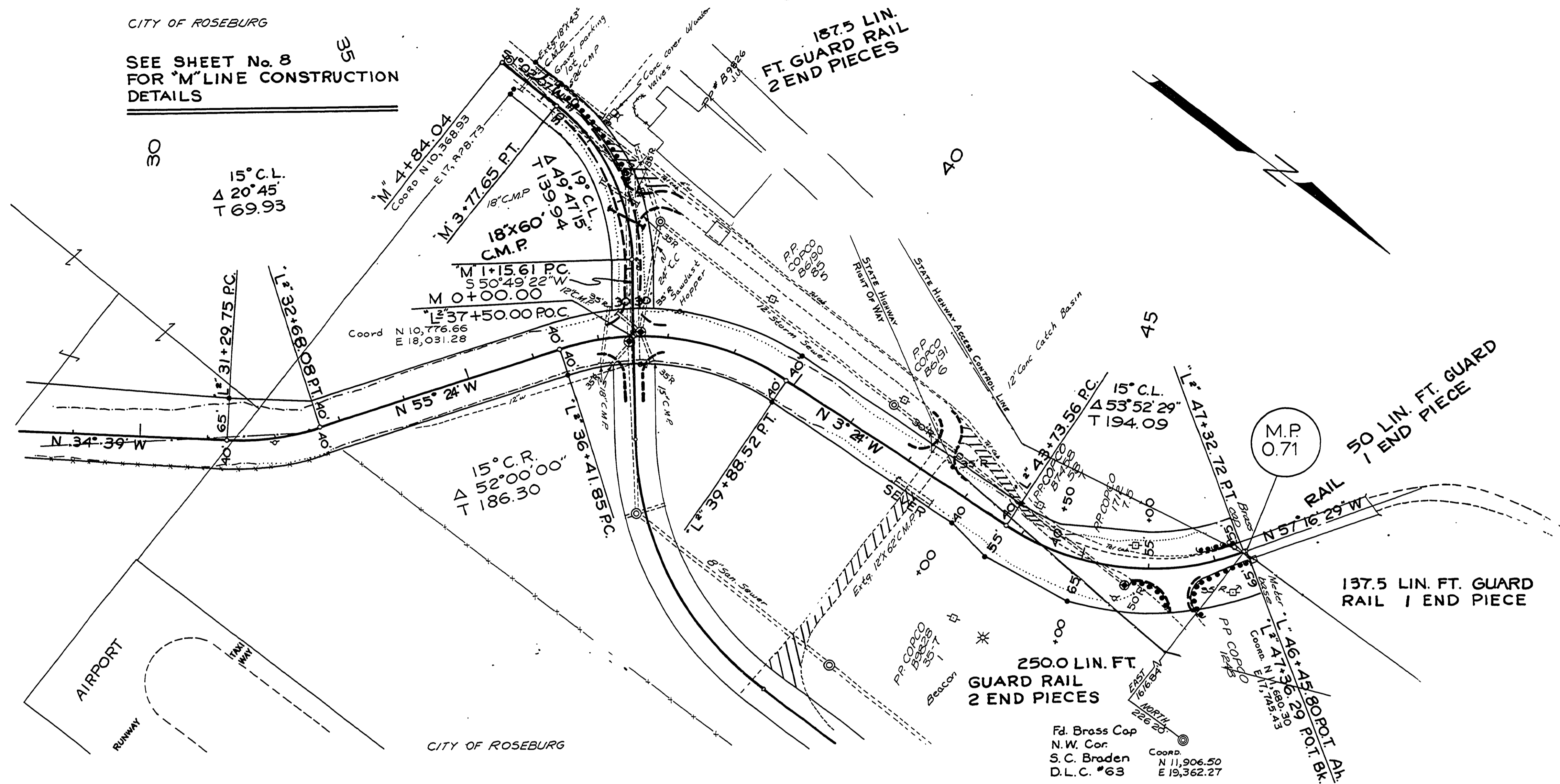

AS CONSTRUCTED
JW 1-11-77
DOUGLAS COUNTY
PUBLIC WORKS DEPARTMENT
STEWART PARKWAY ROAD 308
1975 SHT. 7
GEORGE E. GRUBB, DIRECTOR

00590071

M.P. 0.59-0.71

G. Rd # 308

1975

sht. 7

14