

# SEC 12 T 275 R 6 W

## AMENDED PLAT OF DIXONS ADDITION TO FRUITVALE PT. OF BLK 2

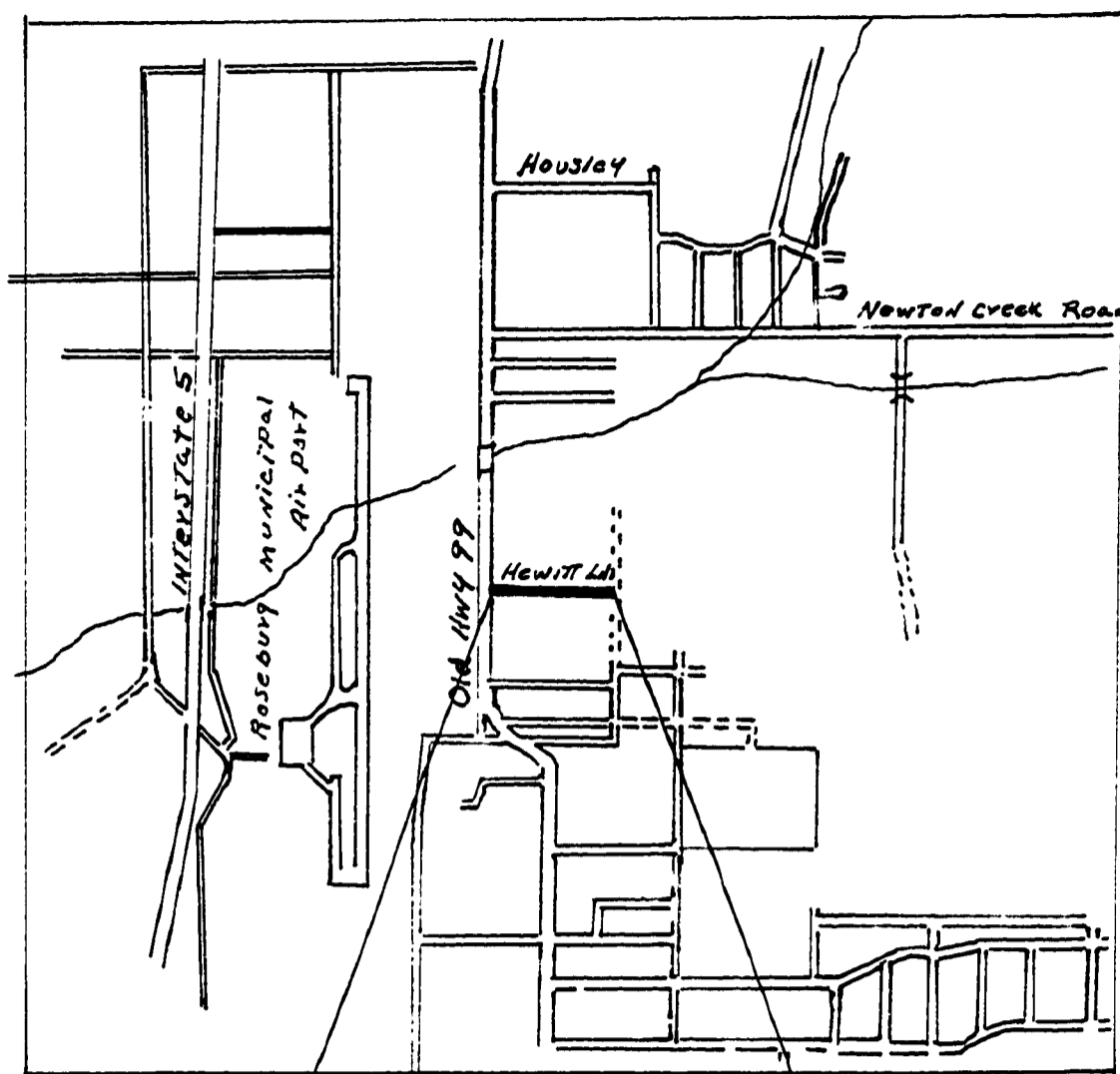

VICINITY MAP  
NORTH ROSEBURG

BEGIN PROJECT  
STAT. 0+00

BEGIN PROJECT  
STAT. 0+16

END PROJECT  
STAT. 8+67

LENGTH OF PROJECT 851 FT.

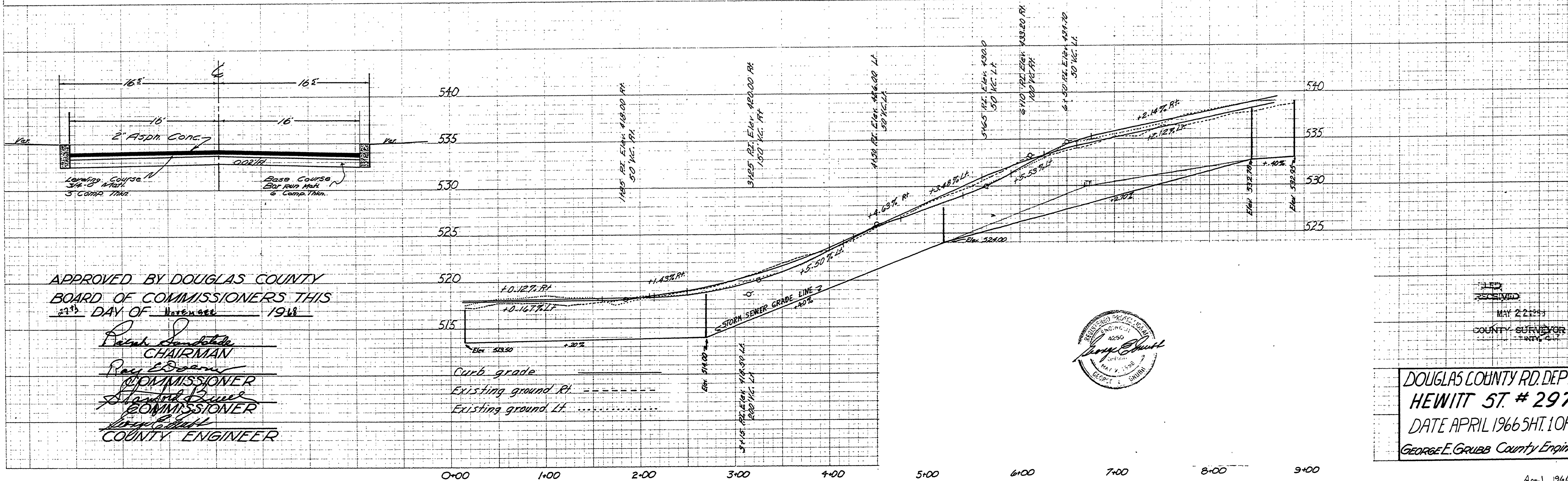
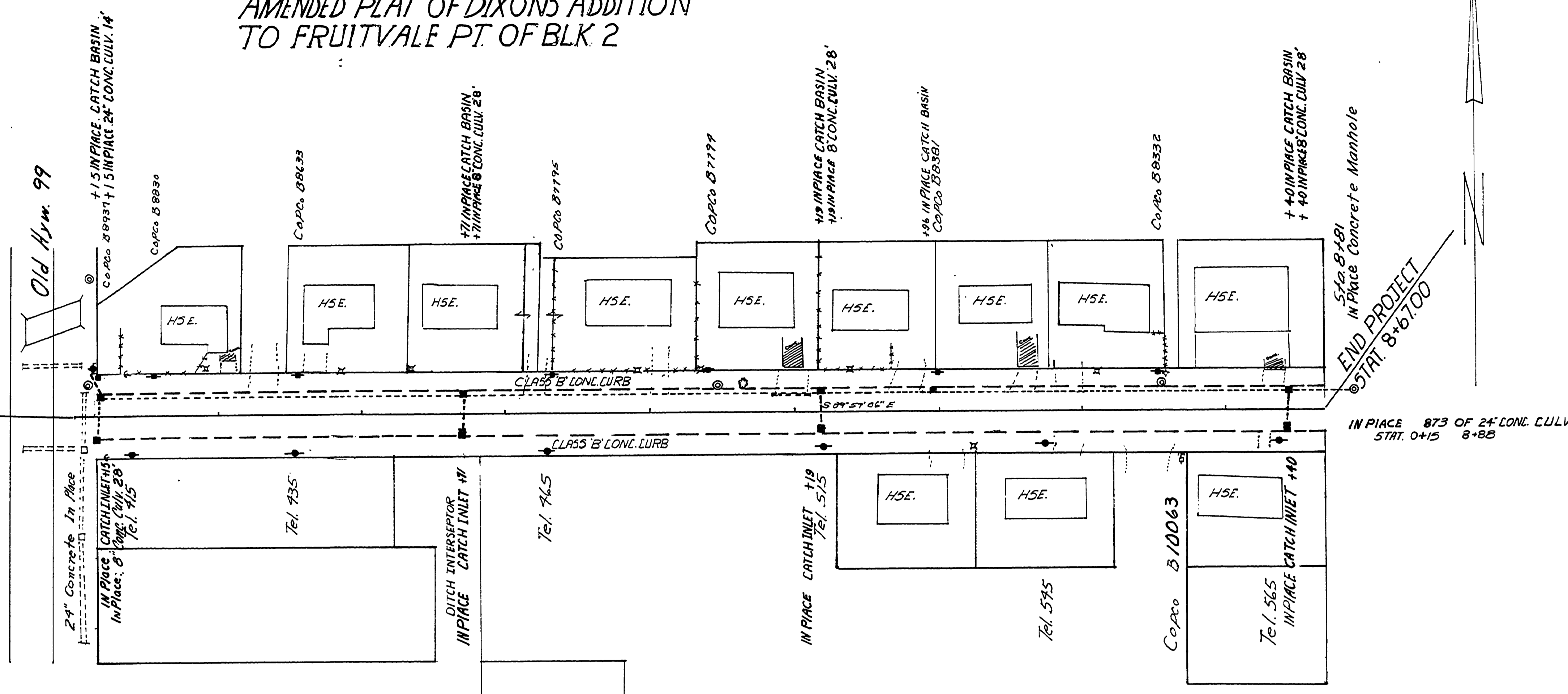

APPROVED BY DOUGLAS COUNTY  
BOARD OF COMMISSIONERS THIS  
23<sup>RD</sup> DAY OF November 1966

*Peter Santolucito*  
CHAIRMAN

*Ray Edgeman*  
COMMISSIONER

*Stanley B. Bue*  
COMMISSIONER

*George E. Grubb*  
COUNTY ENGINEER



FILED  
MAY 22 1966  
COUNTY SURVEYOR

DOUGLAS COUNTY RD. DEPT.  
HEWITT ST. # 297A  
DATE APRIL 1966 5HT. 1 OF 1  
GEORGE E. GRUBB County Engineer

0000016