

DATE	
BY	
FINAL SURVEY	
REPLATE	
NOTE BOOK	
NO.	

DATE	
BY	
SURVEYED	
REPLATE	
NOTE BOOK	
NO.	

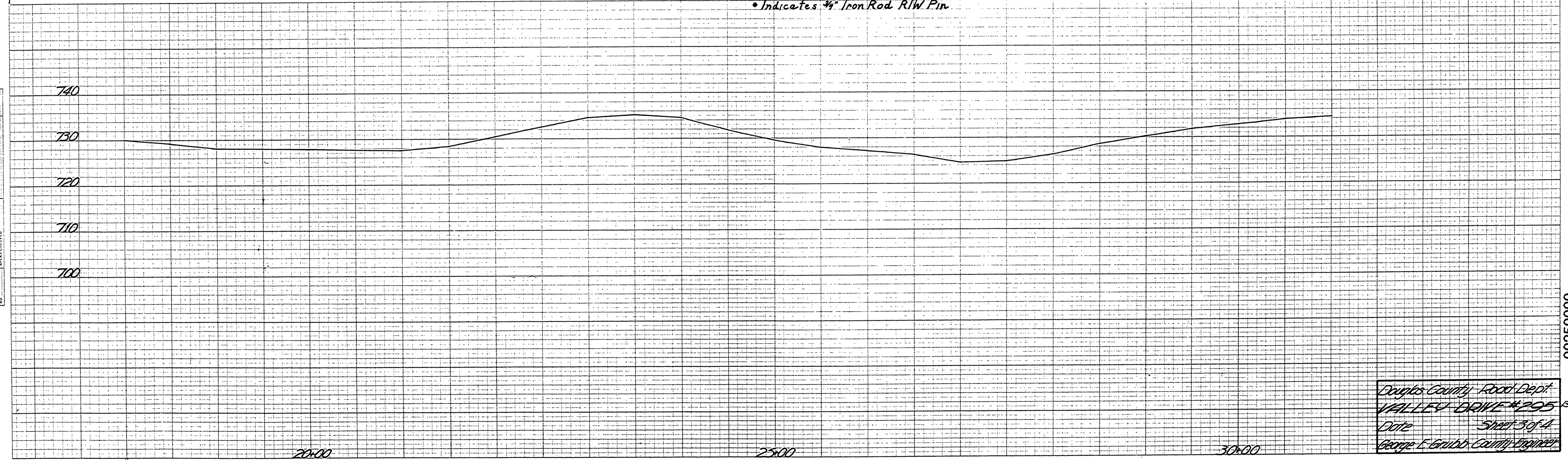

Douglas County Road Dept.  
 VALLEY DRIVE #295-B  
 Date Sheet 3 of 4  
 George E. Grubb, County Engineer

M.P. 0.25-0.00

C. Rd. #295 B

no date  
 at 3 of 4 (28)

00250000