

JUL 15 1975

W	R ₁	Δ ₁	L ₁	R ₂	Δ ₂	L ₂	S ₂	L _{2'}	X	AREA
33	35	46°37'59"	28.49	40	273°15'58"	20.94	16°37'59"	11.61	54.52	5,137
33	40	45°04'10"	31.46	40	270°08'20"	20.94	15°04'10"	10.52	56.64	5,217
41	35	42°16'07"	25.82	40	264°32'14"	20.94	12°16'07"	8.57	50.45	5,123
41	40	40°51'55"	28.53	40	261°43'50"	20.94	10°51'55"	7.59	52.34	5,207

AREA FIGURES ARE FOR SHADED PORTION OF CUL-DE-SAC. (Ft²)

A	B	C	D	E	F	G	H	I	J	K	L	M	G ₁	G ₂
99.60	99.37	99.29	99.14	98.98	98.84	98.91	99.02	99.14	99.25	99.37	99.43	99.62	499.95	

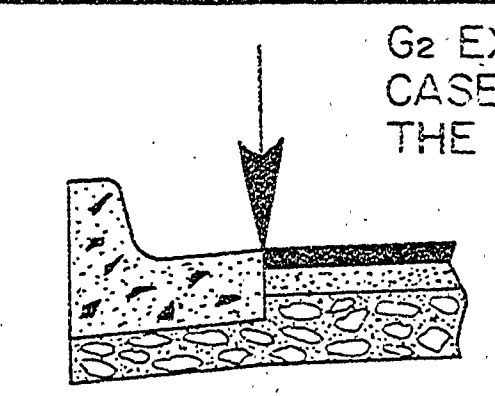
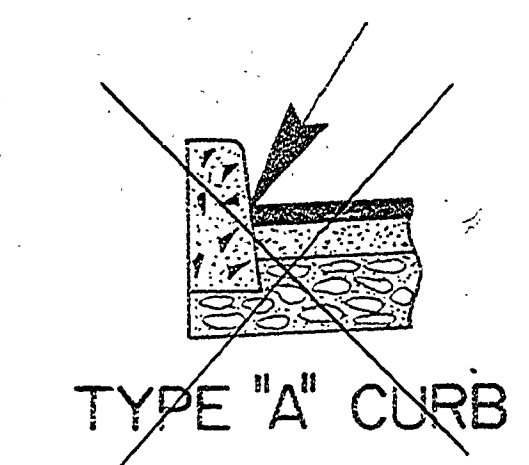
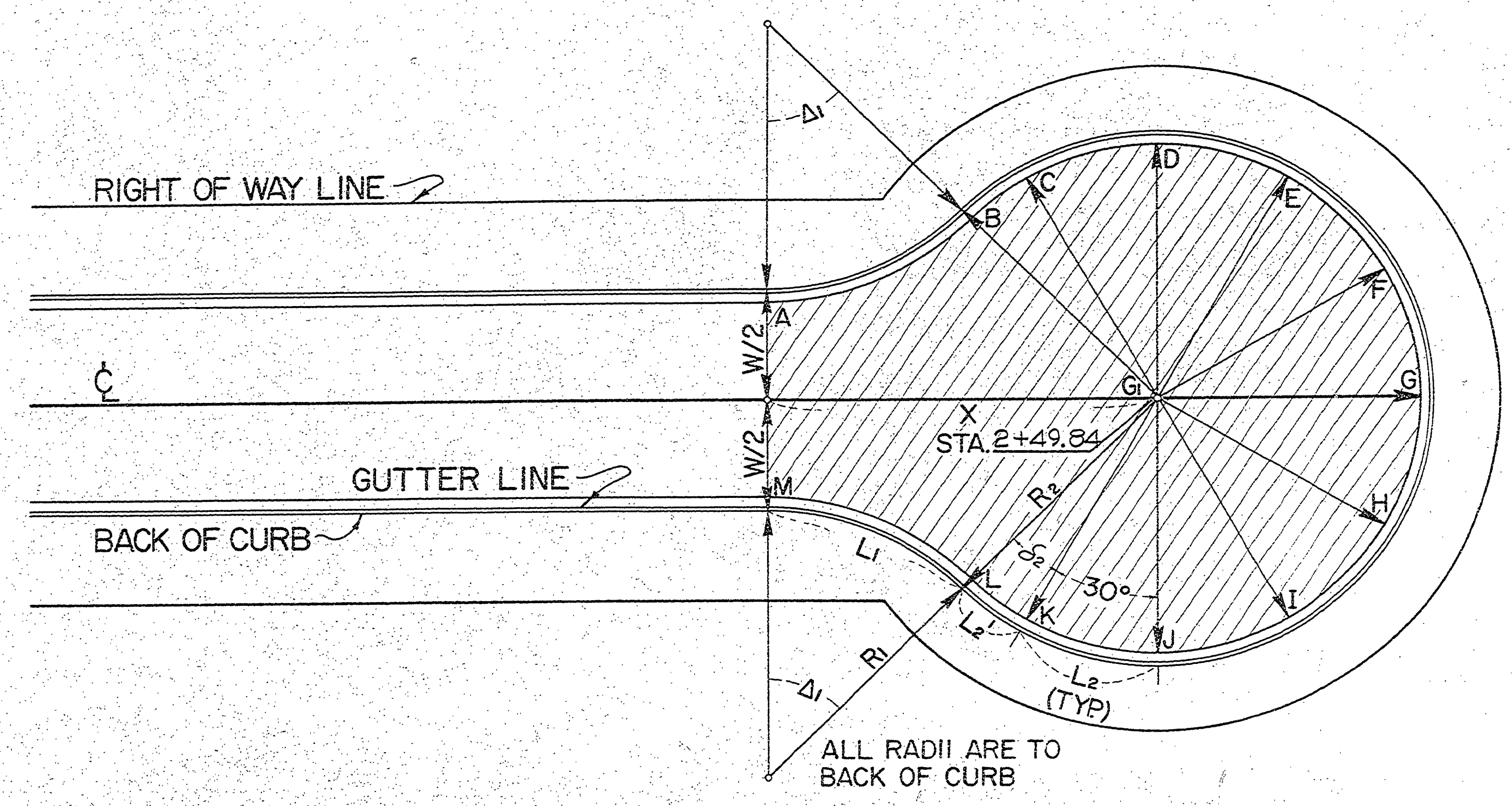

ELEVATIONS LISTED CORRESPOND TO LOCATIONS SHOWN

CUL-DE-SAC

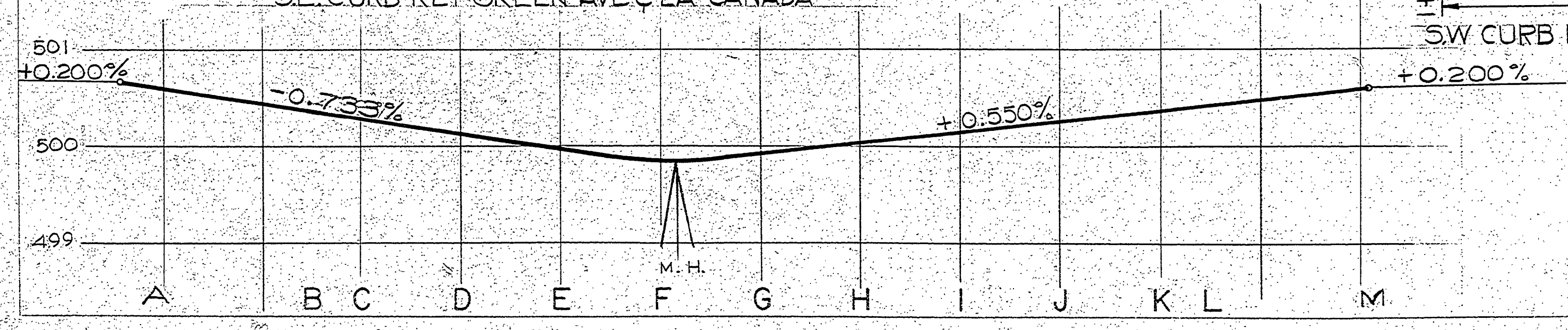
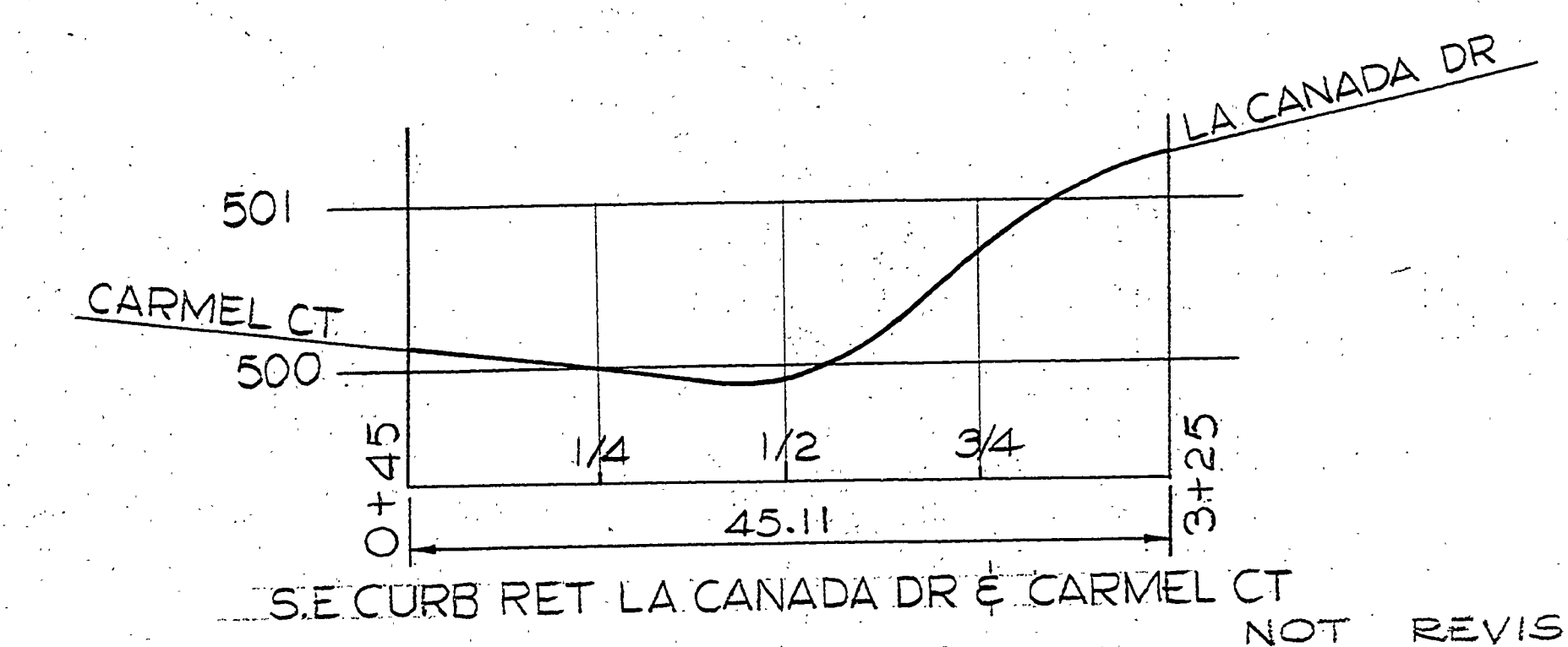
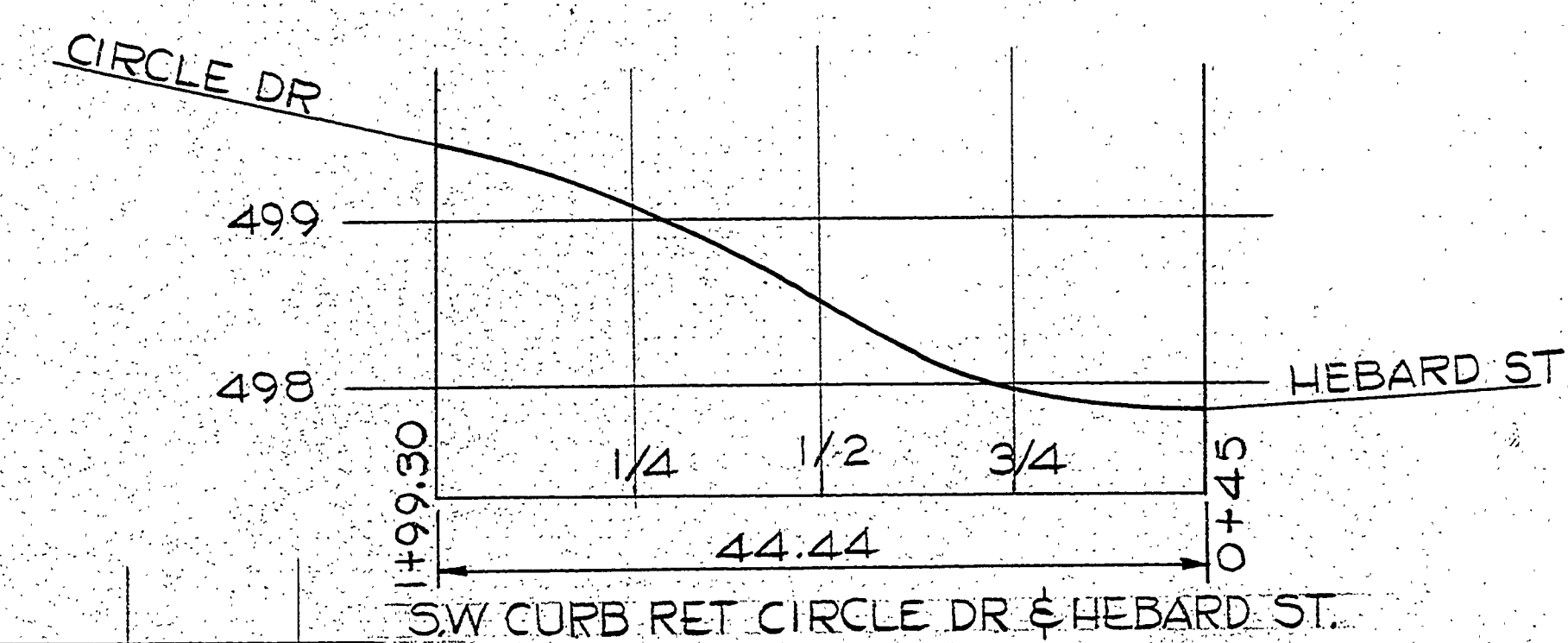
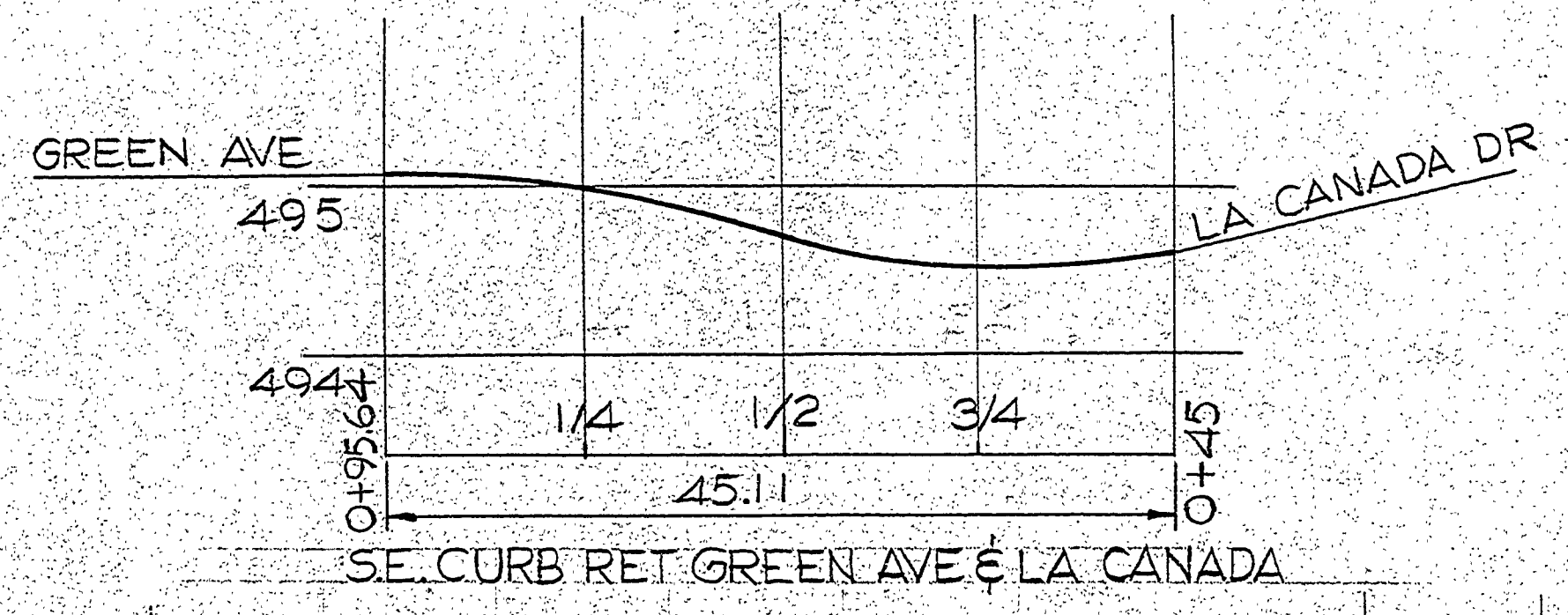
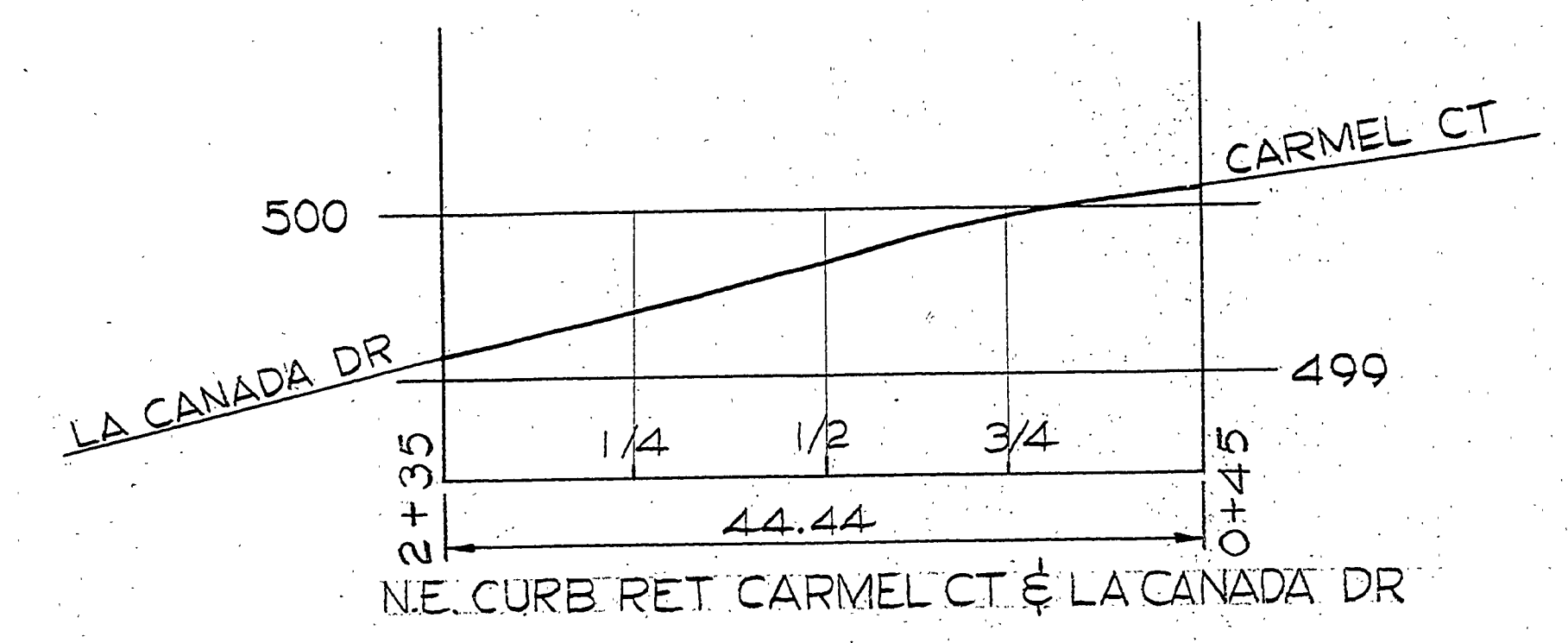
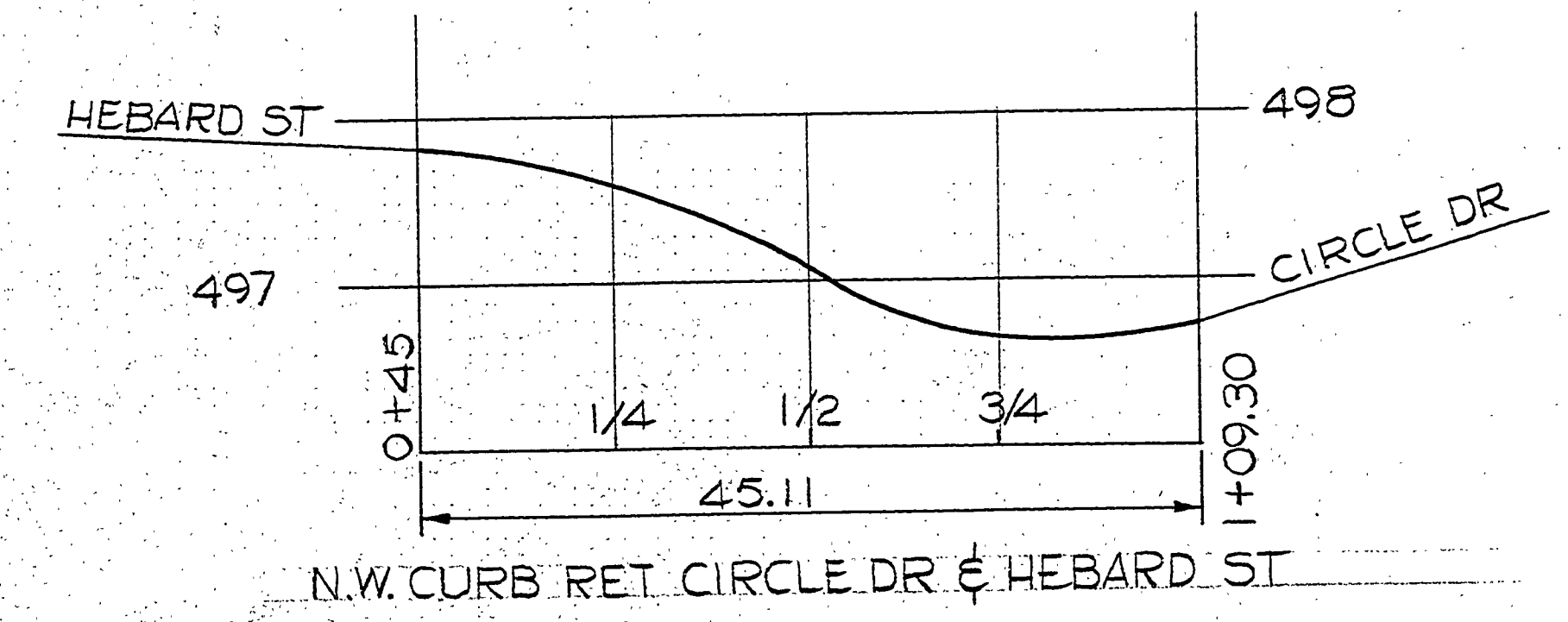
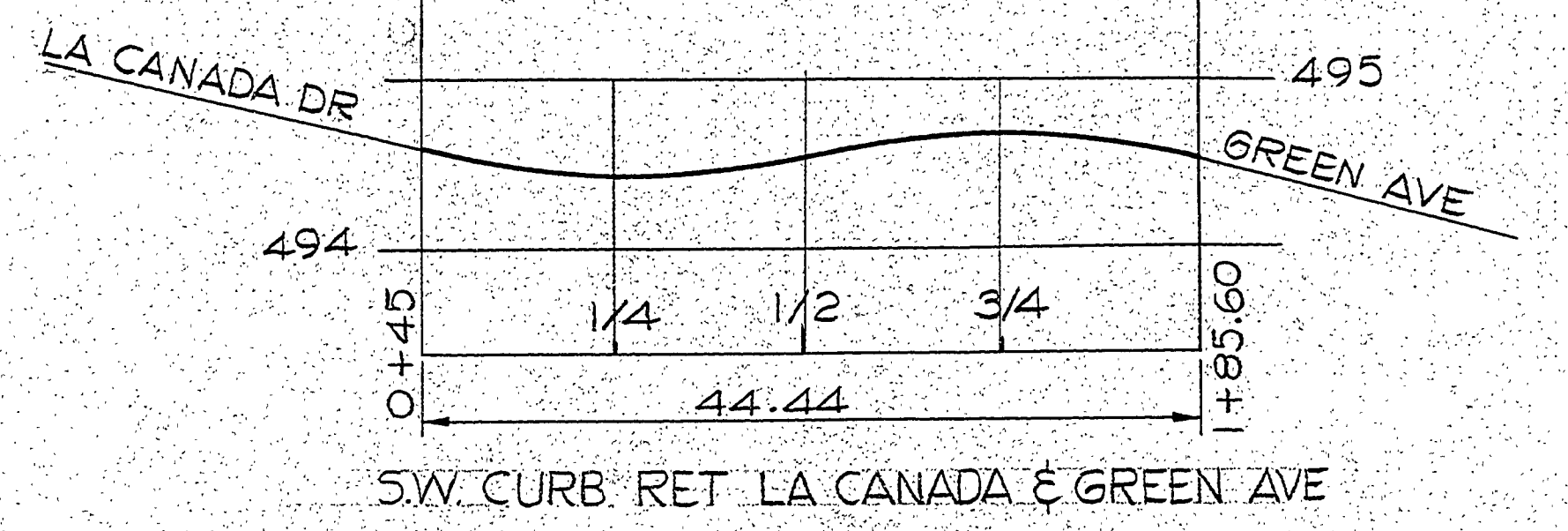
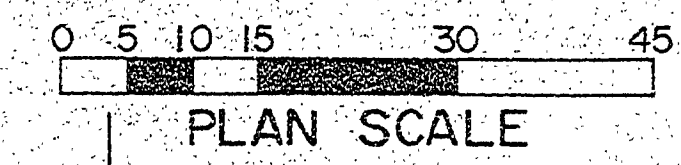

NOT REVISED AS CONSTRUCTED

W=	R=	R ₂ =
DESCRIPTION SUNNYSLOPE STS		
PROJECT RD #278 DATE		
DOUGLAS COUNTY RD. DEPT.		
STANDARD CUL-DE-SAC LAYOUT		
DATE JULY 1970 STD. DW.G.15		

DESIGNED _____
CHECKED _____

George E. Smith

RD278006