

VICINITY MAP
SEC. 10 T28S, R6W, W.M.

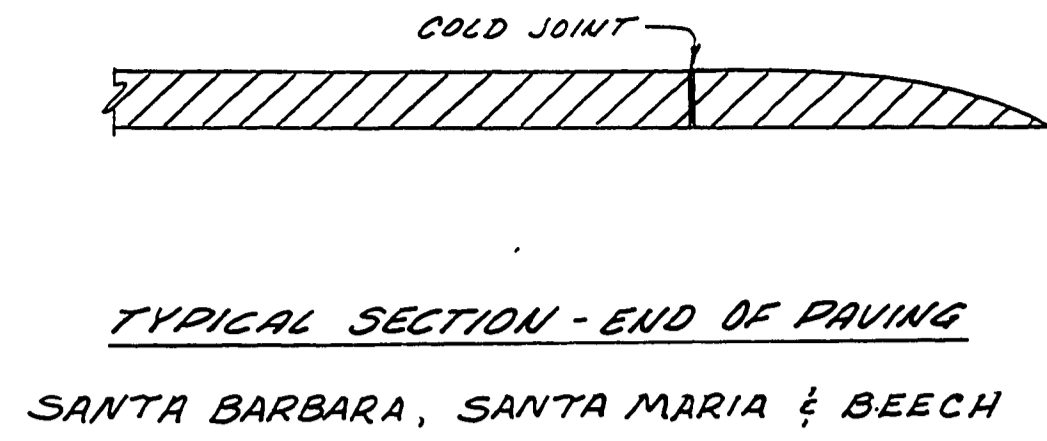

AUG 10 1987
COUNTY ENGINEER
DOUGLAS COUNTY

PLAN
NOTE BOOK
No.

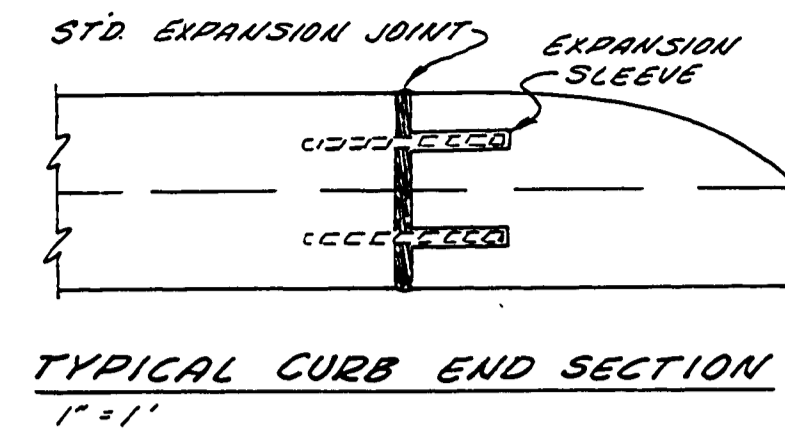
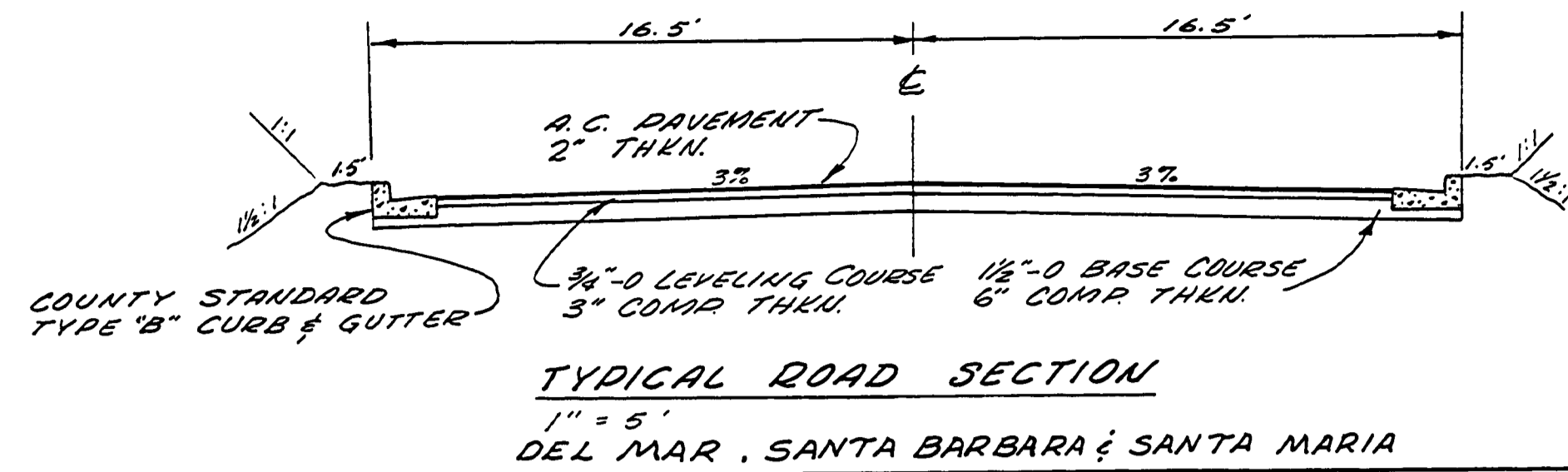
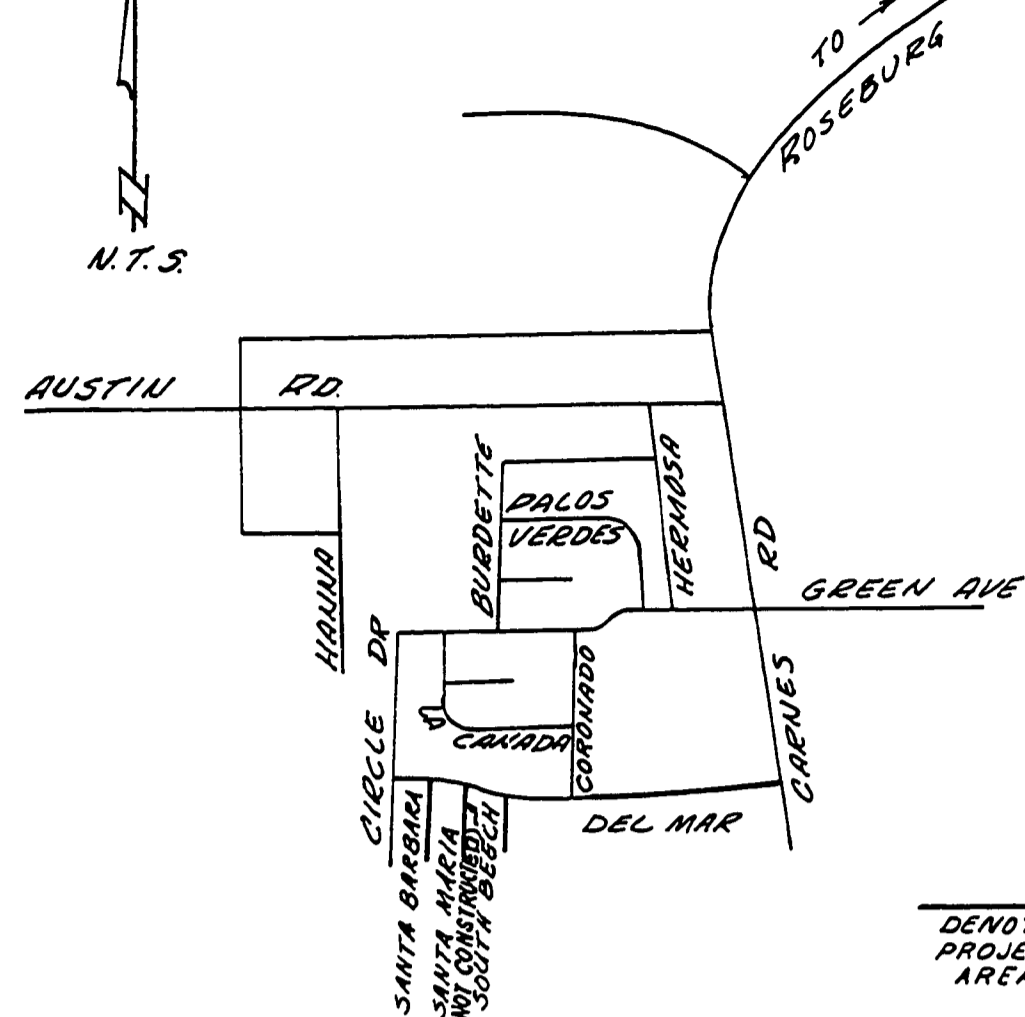
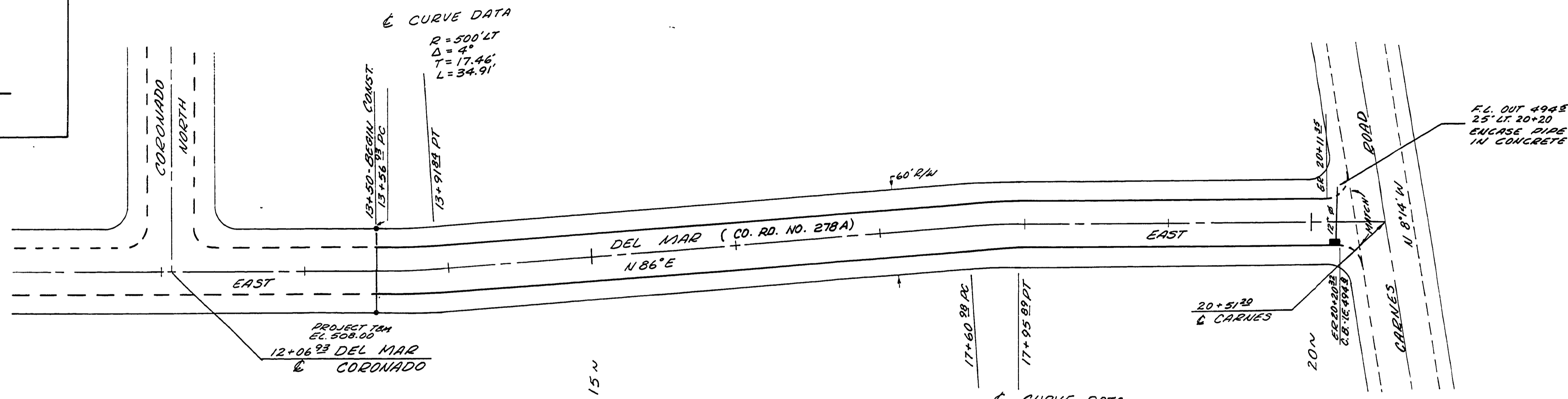

NOTE: END CURBS AT RETURNS ON DEL MAR. PAVEMENT EDGE TO BE CONSTRUCTED ON A 15 FT. RADIUS.

PROFILE
NOTE BOOK
No.

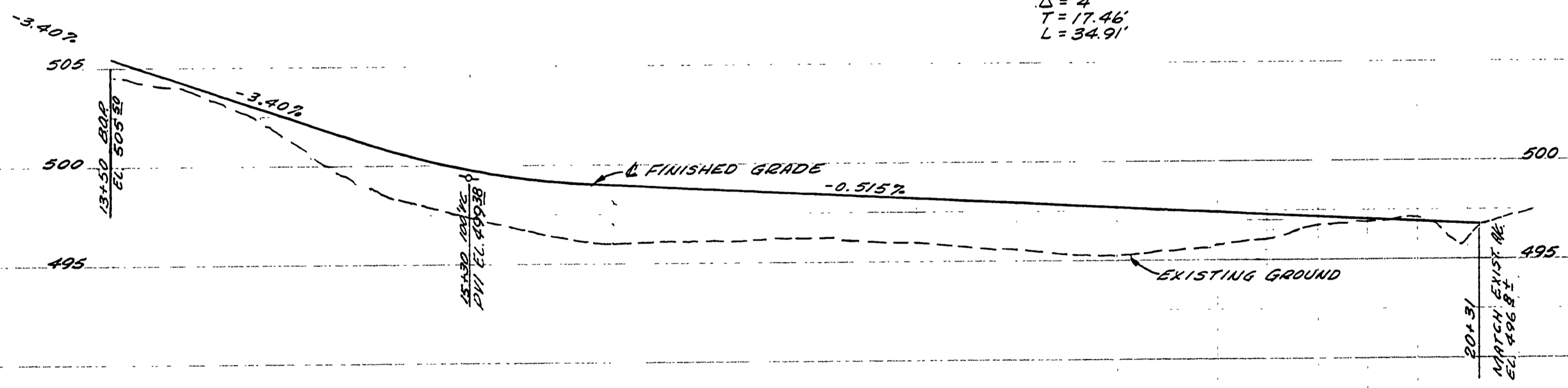

DOUGLAS COUNTY
PUBLIC WORKS DEPT.
APPROVED
By *[Signature]* Date 9-20-76
9-20-76



SUNNYSLOPE SUBDIVISION
8TH ADDITION
SUNNYSLOPE STREETS COR. # 278
(CO. RD. NO. 278A)
DEL MAR STA. 13+50 TO 20+55.23
STREET AND STORM SEWER

S&J ENGINEERING
1338 N.E. LINCOLN STREET
ROSEBURG, OREGON

SHEET # 1 OF 3

00150000