

SEC. 14 & 15 T. 27 S. R. 6 W. W.M.

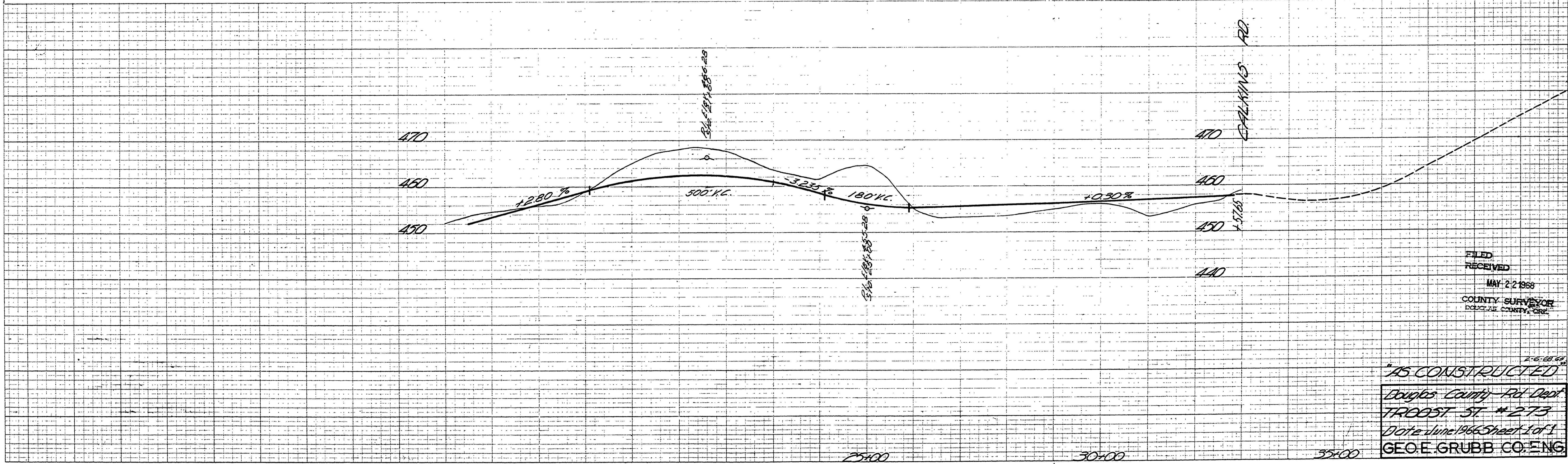
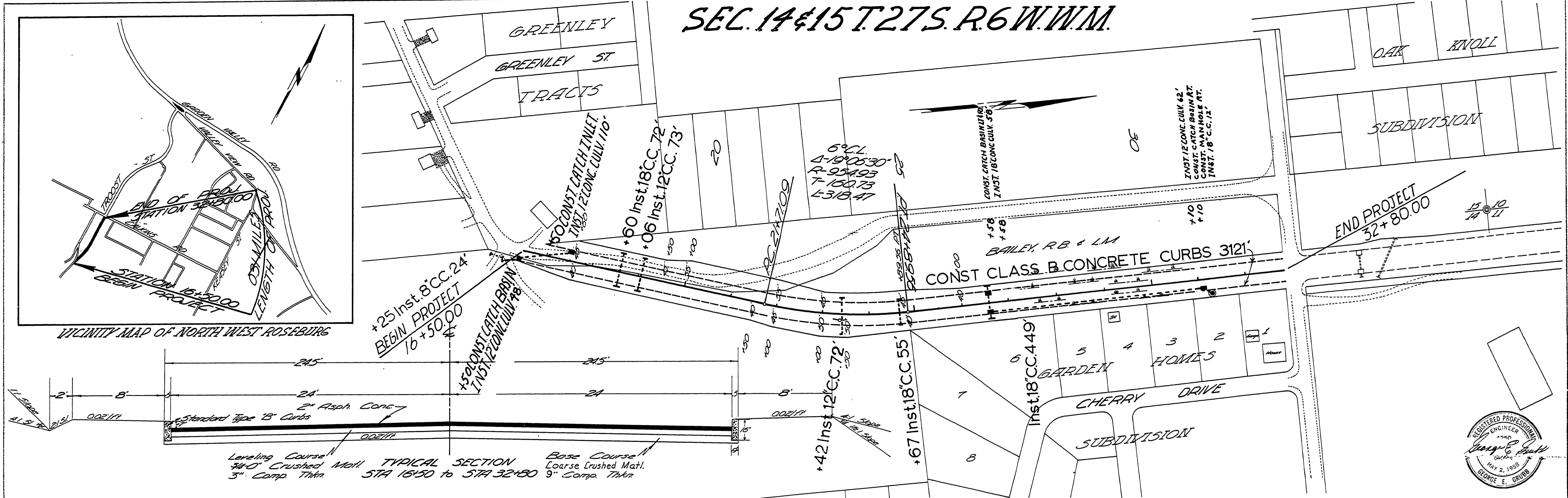

FILED
 RECEIVED
 MAY 22 1968
 COUNTY SURVEYOR
 DOUGLAS COUNTY, ORE.

"AS CONSTRUCTED"
 Douglas County - Rd Dept
TRADOST ST #273
 Date June 1966 Sheet 1 of 1
GEO. E. GRUBB CO. ENG.

00880057