

T. 30 S., R. 6 W.W.M.

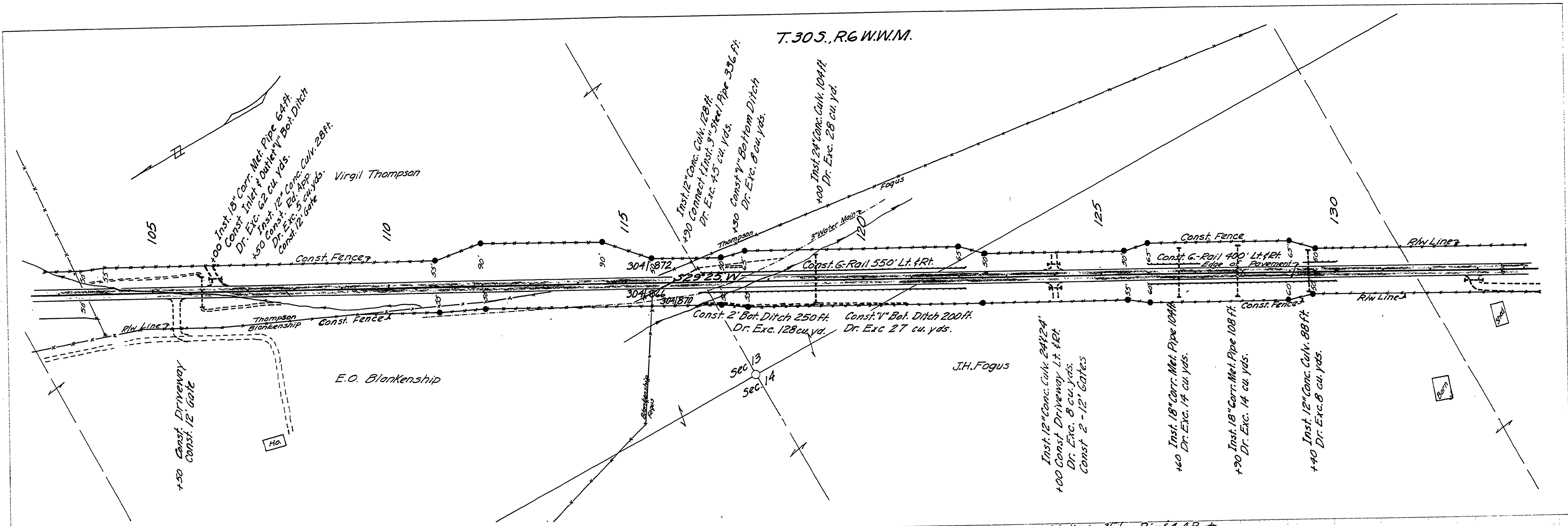

• Indicates 3/4 Iron Pins & 4x4 Posts.

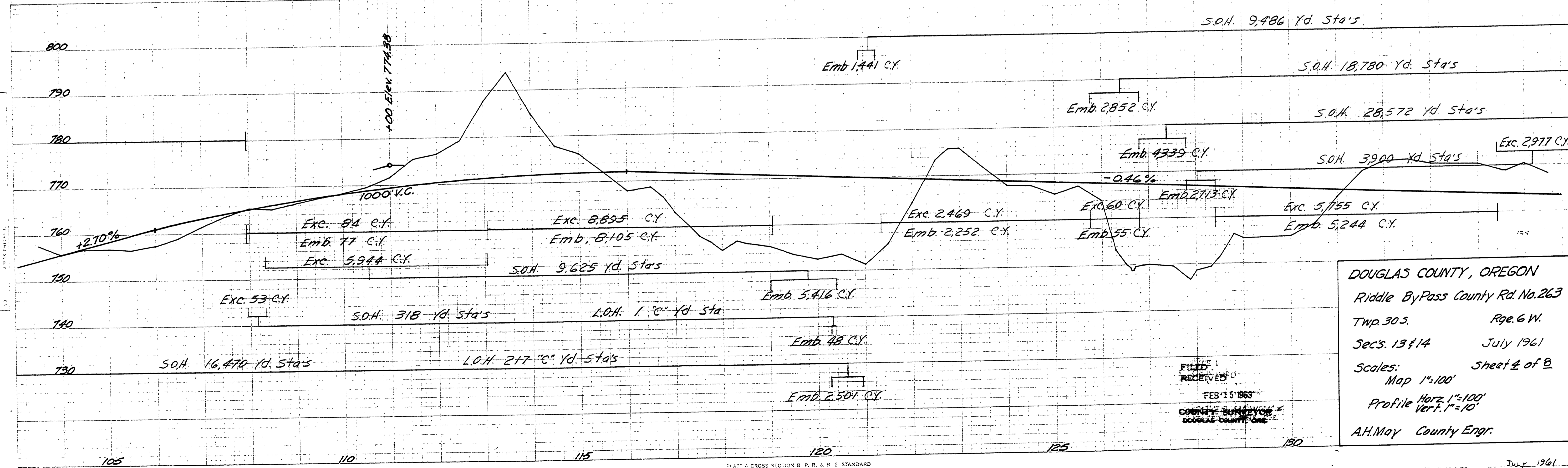

DOUGLAS COUNTY, OREGON
 Riddle Bypass County Rd. No. 263
 Twp. 30 S. Rge. 6 W.
 Secs. 13 & 14 July 1961
 Scales: Map 1"=100'
 Profile Horiz. 1"=100'
 Vert. 1"=10'
 A.H. May County Engr.

FILED
 RECEIVED
 FEB 15 1963
 COUNTY SURVEYOR
 DOUGLAS COUNTY, OREGON

PLAT 4 CROSS SECTION B P. R. & R. STANDARD
 JULY 1961 10' 10' CONTACT WITH 10' 10'

M.P. 0.99 - 1.56

July 1961
 G.R.D. # 263
 sheet 4 of 8 (24)

00990156