

T.25 S., R.5 W.W.M.

DOUGLAS COUNTY OREGON  
 PLANS FOR PROPOSED PROJECT  
 GRADING  
**UNION GAP ROAD NO. 256**  
 August 1960

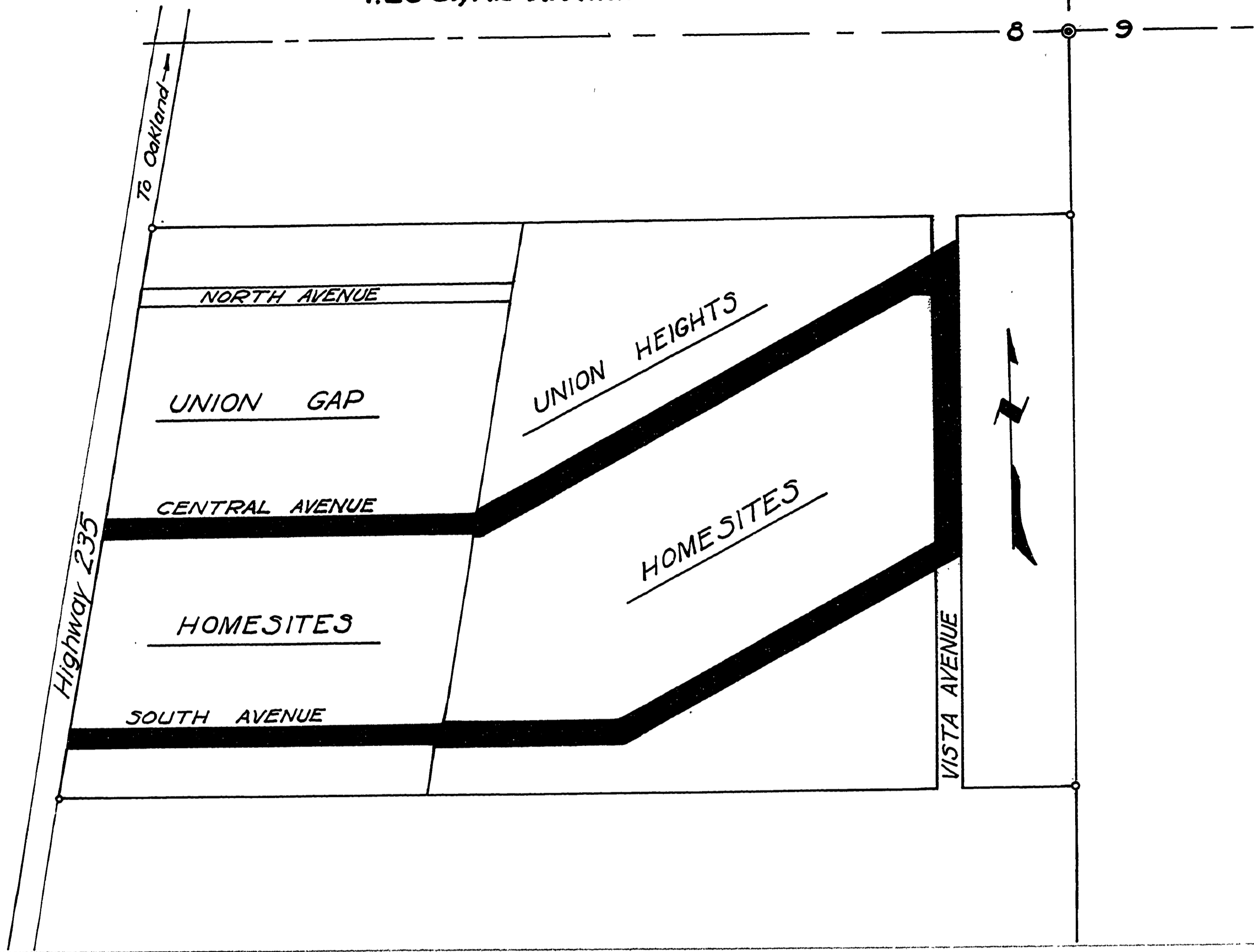

DATE	
BY	
FINAL SURVEY	
NO. 1	

South Avenue, Central Avenue and a portion of Vista Avenue dedicated in Union Gap Homesites and Union Heights Homesites as recorded in Vol. 7 Page 31 and Vol. 8 Page 9 of the Douglas County Plat Records. Adapted by Resolution of the County Court

V. T. Jackson County Judge  
James W. Clough County Comm.  
W. H. Clough County Comm.

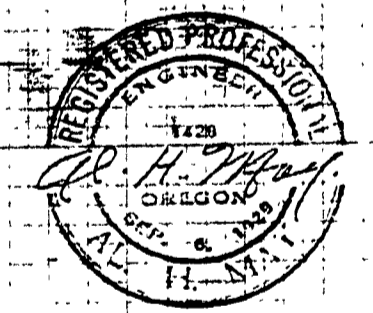

DATE	
BY	
ORIGINAL SURVEY	
NO. 1	

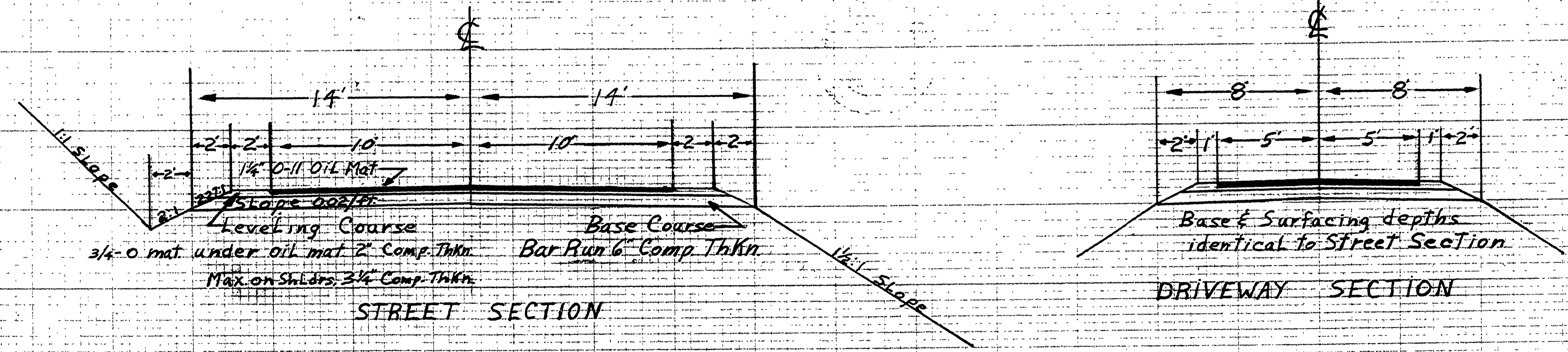

FILED  
 RECEIVED  
 SEP 13 1960  
 COUNTY SURVEYOR  
 DOUGLAS COUNTY, OREGON

Sheet 1 of 4

PLATE 4 CROSS SECTION B.P.R. & R.E. STANDARD  
 LOGAN SHEPHERD CO. CHICAGO, ILL. 60604