

- NOTES:**
- POTENTIAL CONFLICT BETWEEN SANITARY SERVICE LATERALS SERVICING LOTS 4-9 AND WATERMAIN. INSTALL WATERMAIN BELOW SERVICE LATERALS IN THESE LOCATIONS.
 - SEE SHEET 4 FOR DRIVEWAY LOCATIONS
 - SEE SHEET 4 FOR LEGEND
 - SEE SHEET 6 FOR ROAD TEMPLATE (WINNGATE COURT)

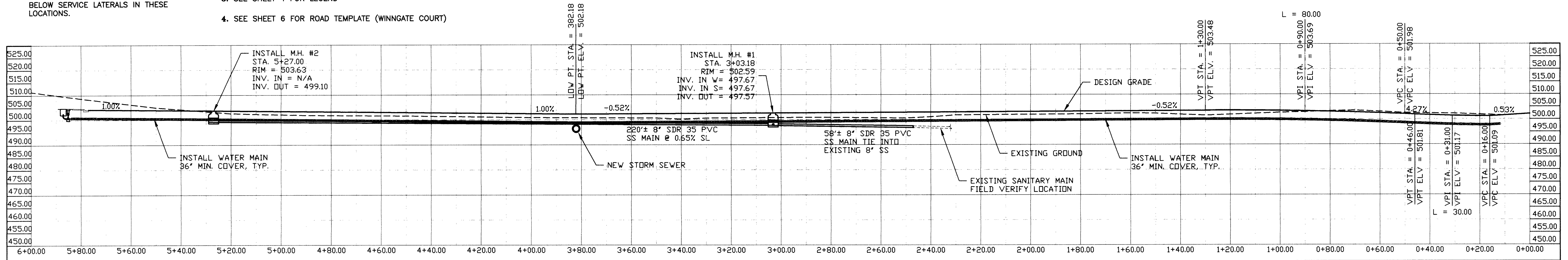

M.H. #2
POLYETHYLENE
MANHOLE
RHIND C-36 CENTER SHORT CONE
RHIND SB-22 SANITARY BASE
DYLIMPIC FOUNDRY MH30 (OR APPROVED EQUAL)

M.H. #1
POLYETHYLENE
MANHOLE
RHIND C-48 CENTER SHORT CONE
RHIND SB-30 SANITARY BASE
DYLIMPIC FOUNDRY MH30 (OR APPROVED EQUAL)

ATTENTION: OREGON LAW REQUIRES YOU TO FOLLOW RULES ADOPTED BY THE OREGON UTILITY NOTIFICATION CENTER. THOSE RULES ARE SET FORTH IN OAR 952-001-0010 THROUGH 952-001-0090. YOU MAY OBTAIN COPIES OF THE RULES BY CALLING THE CENTER AT 1-800-332-2344. CALL BEFORE YOU DIG.

POST CONSTRUCTION DRAWINGS

THESE DRAWINGS REPRESENT THE CONSTRUCTION WORK AS NEAR AS CAN BE DETERMINED. THEY WERE PREPARED FROM INFORMATION GATHERED DURING CONSTRUCTION ACTIVITY BY THE CONTRACTORS AND INSPECTORS AND ARE THOUGHT TO BE ACCURATE. HOWEVER NO GUARANTEE OR WARRANTY IS EXPRESSED OR IMPLIED AS TO THEIR EXACTNESS AND THEY SHOULD BE USED ONLY AS A GENERAL REPRESENTATION OF THE CONSTRUCTION WORKS.

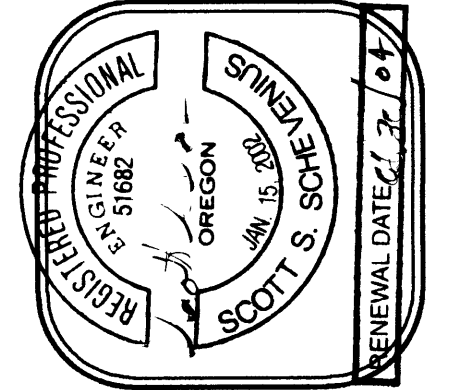

SURVEYING & ENGINEERING, INC.
ENGINEERING • SURVEYING • PLANNING

3078 NE DIAMOND LAKE BLVD.
ROSEBURG, OREGON 97170
TEL (541)872-2098
FAX (541)872-0611

Revision	1	Date	07/08/03
Revision		Date	

Drawn	MPS
Design	SSS
Checked	SSS
Reviewed	SSS

AA PROJECT #8078.02 09/16/03

TITLE: WINNGATE COURT ROAD, WATER, & SANITARY

PROJECT NAME: WINNGATE SUBDIVISION GREEN DISTRICT, OREGON

SHT.	3
OF	7

0000010