

SEC. 10 T 28 S R 6 W W.M.

FILED
RECEIVED
AUG 1 1979
COUNTY SURVEYOR
DOUGLAS COUNTY, ORE

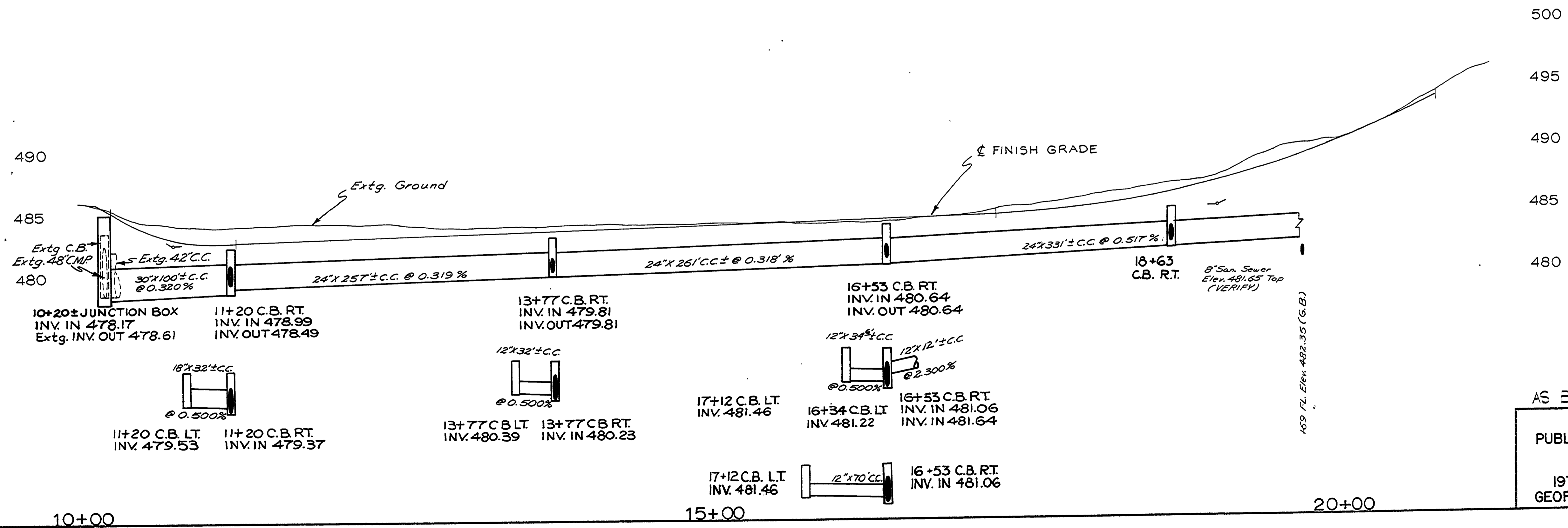
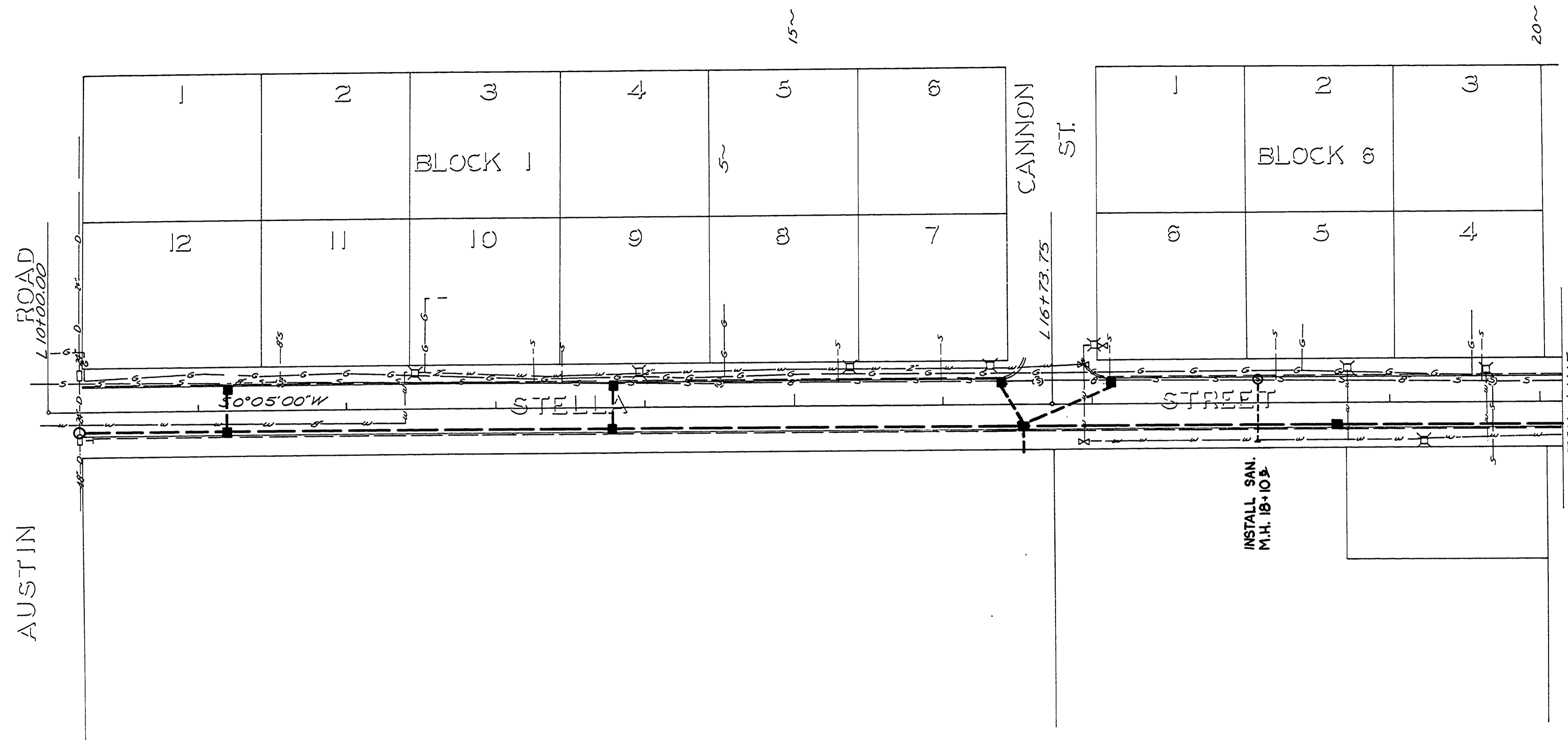

AS BUILT 8/1/79 L.L.
DOUGLAS COUNTY
PUBLIC WORKS DEPARTMENT
STELLA STREET
1979 SHT. 5
GEORGE E. GRUBB, DIRECTOR

00060026

1979 5/10