

N.E. PLEASANT STREET ROAD NUMBER 242
 ADOPTED BY RESOLUTION OF COUNTY COURT
 SHOWN IN RED JAN 21, 1958
V.L. Jackson COUNTY JUDGE
Frank Adley COUNTY COMM.
Anna M. Dwyer COUNTY COMM.

N.E. PLEASANT STREET SHOWN AS DEDICATED
 IN VOL. 6 PAGE 43 OFFICE OF THE
 DOUGLAS COUNTY SURVEYOR

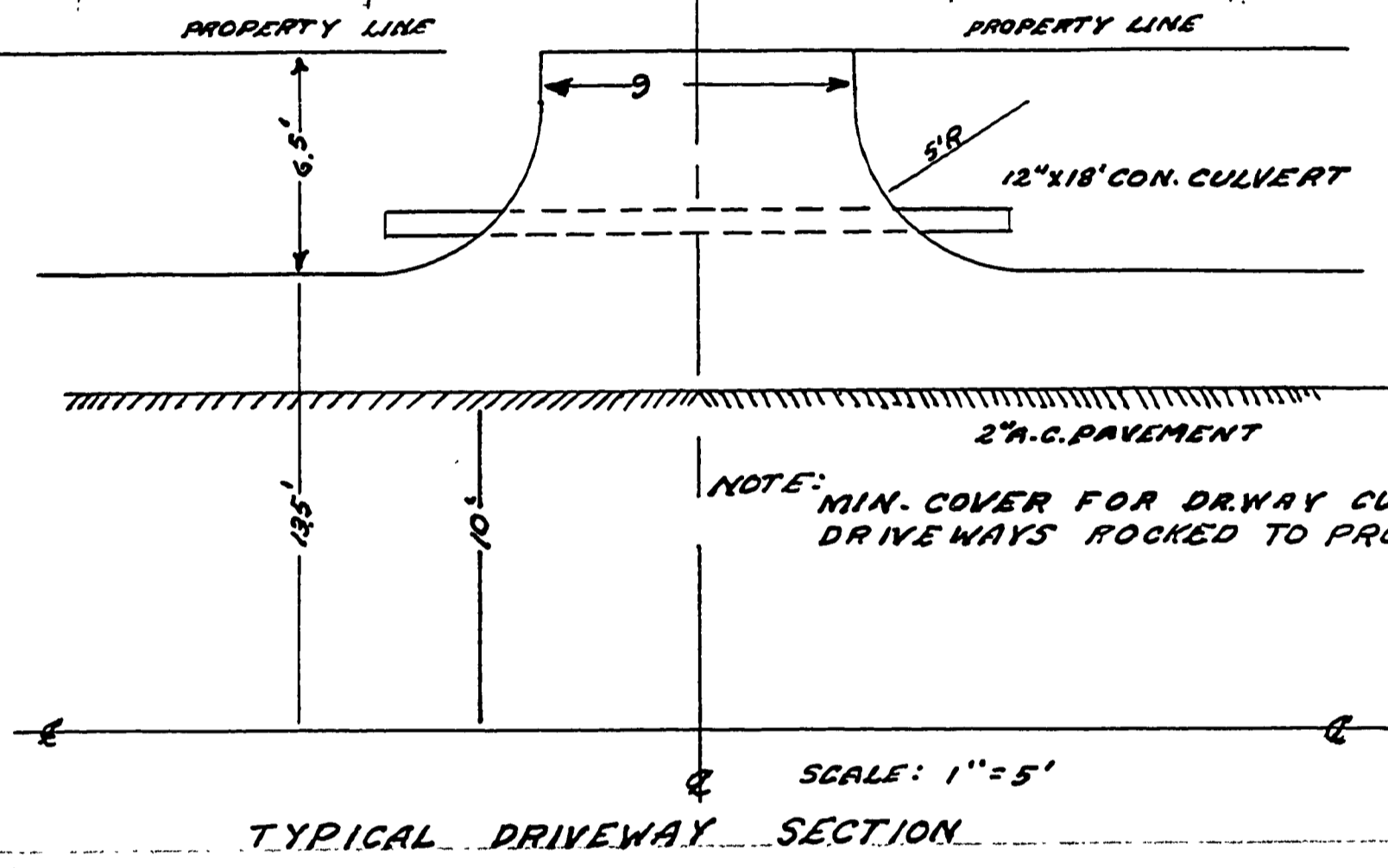

NOTE: MIN. COVER FOR DRYWAY CULVERTS 6"
 DRIVEWAYS ROCKED TO PROPERTY LINE 6" DEEP

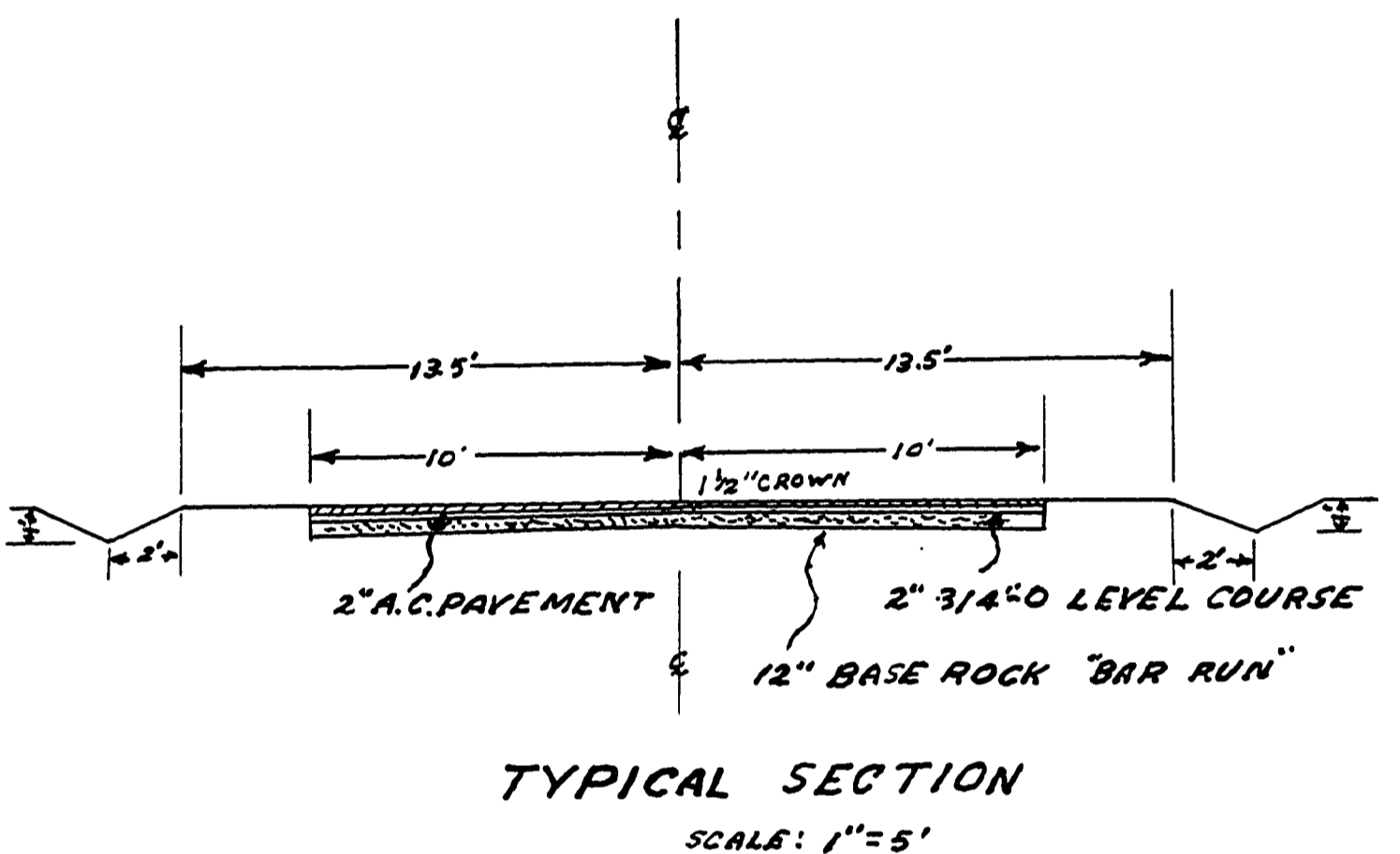
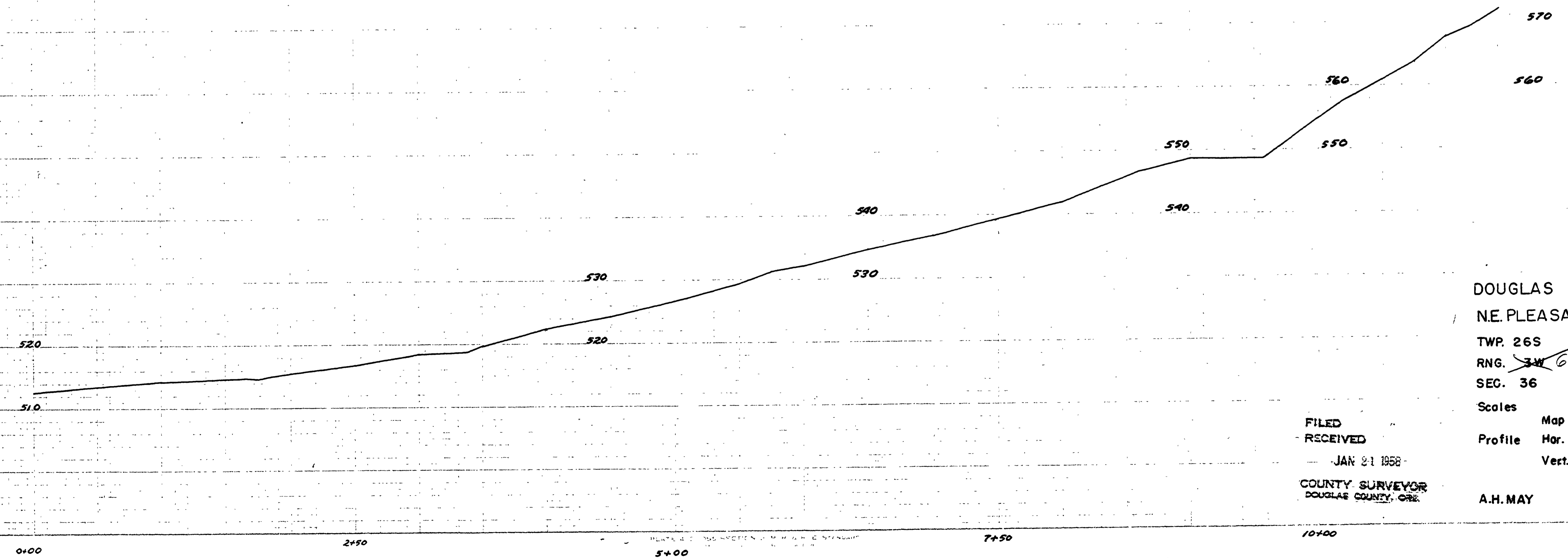

DOUGLAS COUNTY, OREGON
 N.E. PLEASANT ST. RD. NO. 242
 TWP. 26S April 1957
 RNG. 3W 6W Sheet No. 1
 SEC. 36 of 1 sheet
 Scales: Map 1" = 40'
 Profile Hor. 1" = 50'
 Vert. 1" = 10'
 A.H. MAY COUNTY ENGINEER

FILED
 RECEIVED
 JAN 21 1958
 COUNTY SURVEYOR
 DOUGLAS COUNTY, ORE.

April, 1957 Road No. 242
 ATC 1 of 1

M.P. 0.09 - 0.31

00090031