

- ① FIELD VERIFY LOCATION & DEPTH OF EXISTING 12" STORM PIPE
- ② INSTALL 15 LF OF 12" STS @ 1.0% MINIMUM SLOPE

CALL BEFORE YOU DIG!
ONE CALL (800) 332-2344
 OAR 952-001-0010 THROUGH
 OAR 952-001-0090

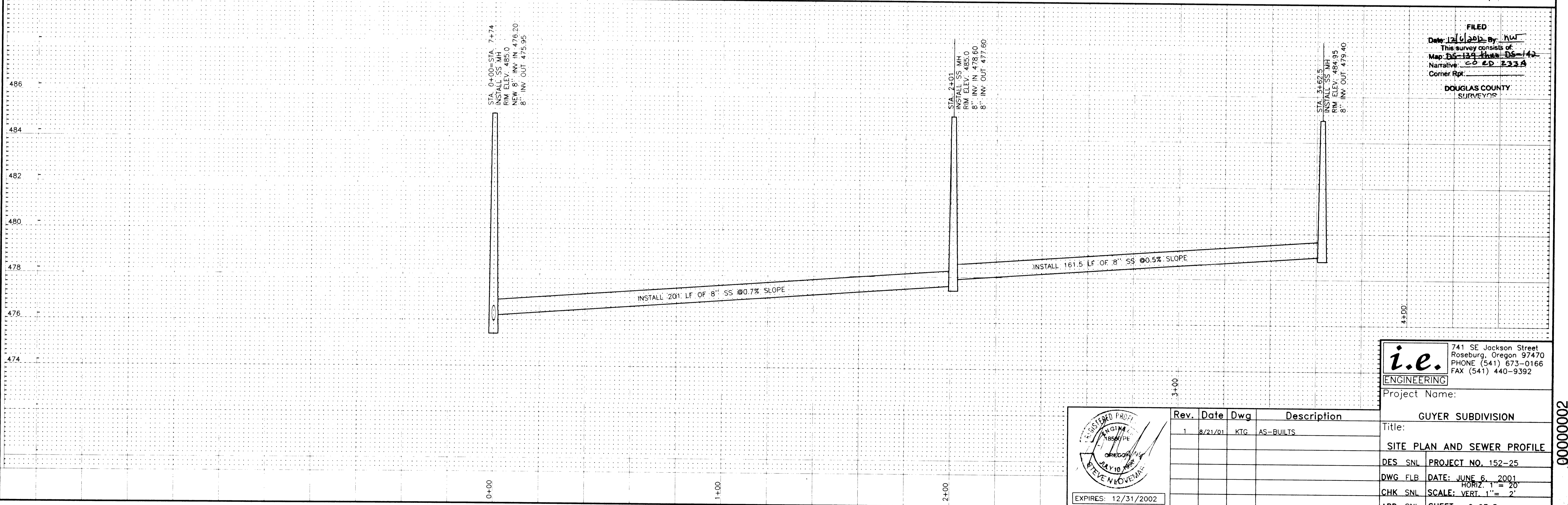

FILED
 Date: 12/6/2002 By: HW
 This survey consists of:
 Map: DS-123 thru DS-142
 Narrative: CO RD 233A
 Corner Rpt:
DOUGLAS COUNTY
 SURVEYOR

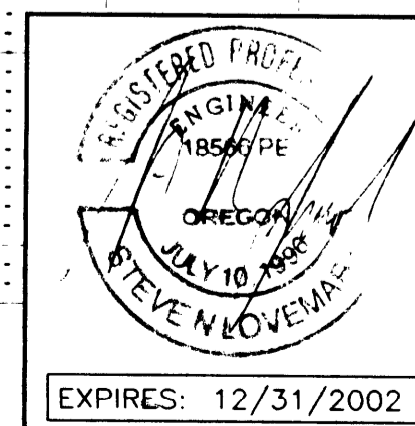

Rev.	Date	Dwg	Description
1	8/21/01	KTG	AS-BUILTS

i.e. ENGINEERING
 741 SE Jackson Street
 Roseburg, Oregon 97470
 PHONE (541) 673-0166
 FAX (541) 440-9392

Project Name: **GUYER SUBDIVISION**

Title: **SITE PLAN AND SEWER PROFILE**

DES SNL PROJECT NO. 152-25
 DWG FLB DATE: JUNE 6, 2001
 HORIZ. 1" = 20'
 CHK SNL SCALE: VERT. 1" = 2'
 APP SNL SHEET: 2 OF 5

Co. Rd. # 233A MP 0.00-0.02

00000002