

FILED  
RECEIVED  
MAY 11 1955  
COUNTY SURVEYOR  
DOUGLAS COUNTY, OREG.

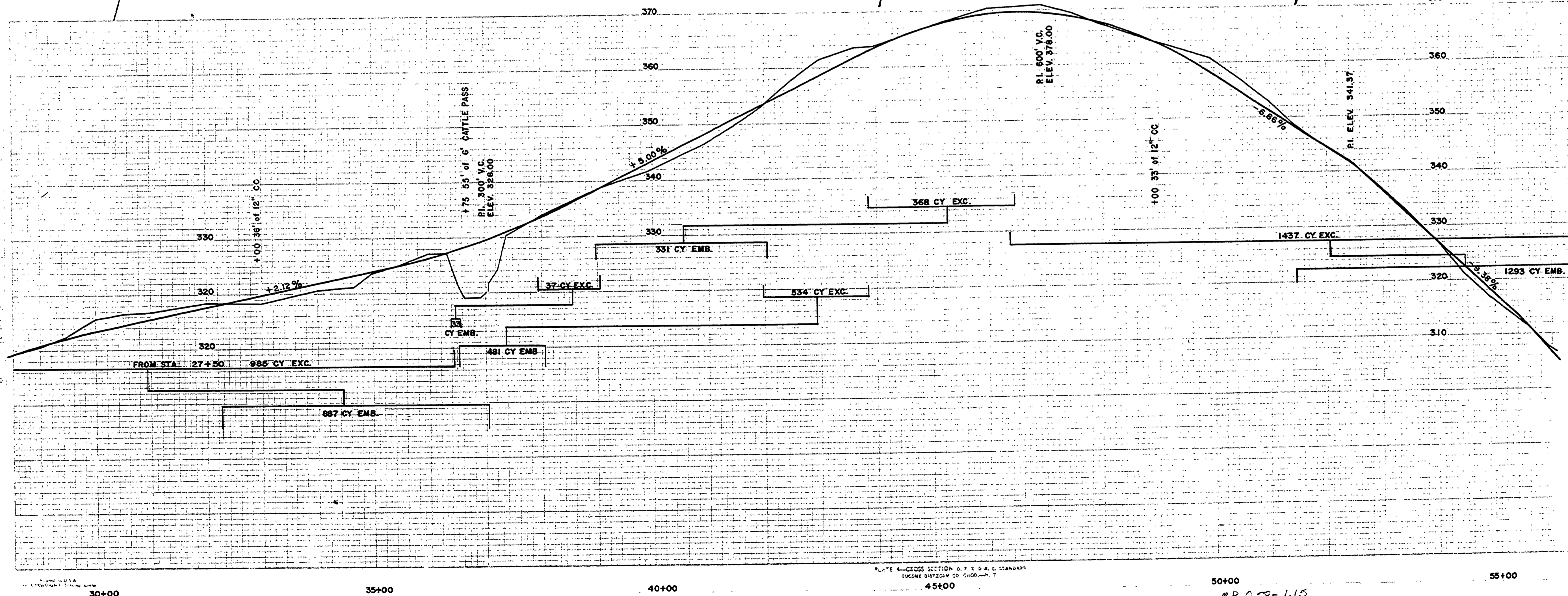

DOUGLAS COUNTY, OREGON  
ROAD NO. 223  
TWP 26 S Date 1955  
RNG 4 W Sheet No. 2  
SEC. 16, 17, 20, 21 of 3 Sheets  
Scale Map 1"=100'  
Profile Hor. 1"=100'  
Vert. 1"=10'

FLOYD C. FREAR COUNTY ENGINEER

00580115

Co. ROAD NO. 223  
60+00  
1955 sht. 2 of 3 (58)

M.P. 0.58-1.15