

FILED  
AUG 10 1987  
COUNTY SURVEYOR  
DOUGLAS COUNTY, ORE

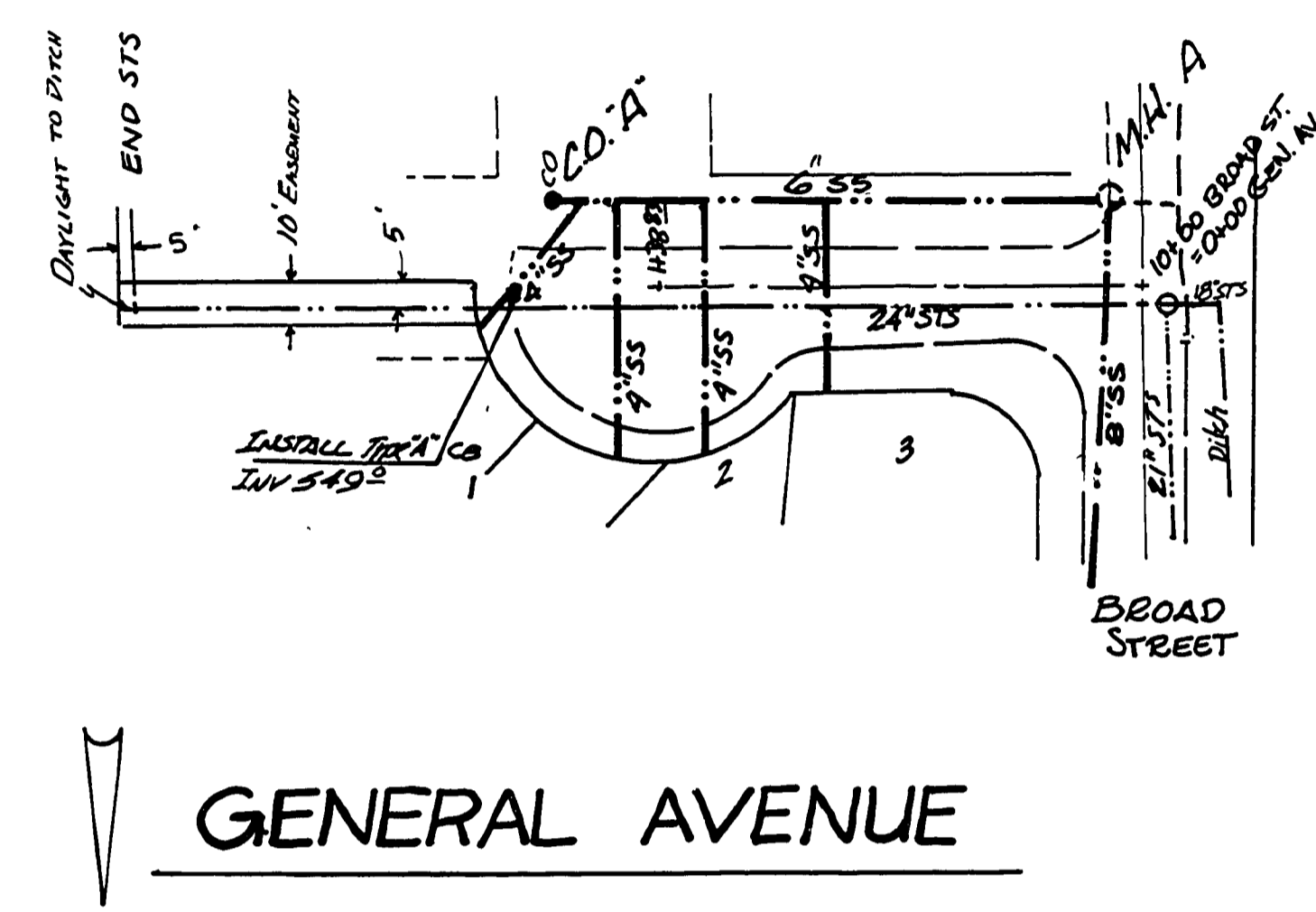
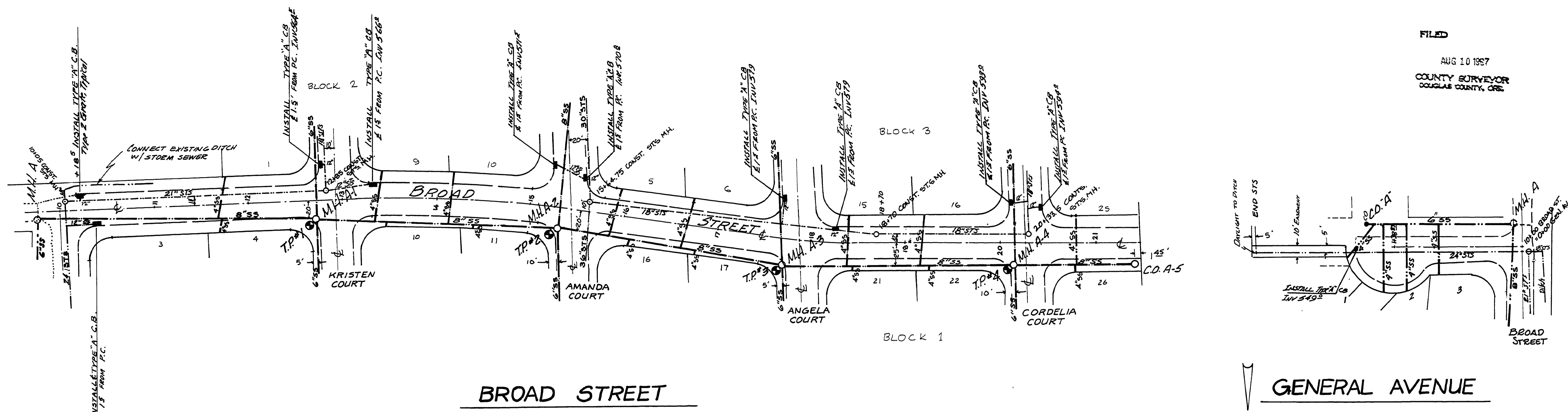

**BROAD STREET**

**GENERAL AVENUE**

Scale: 1" = 50'

Scale: 1" = 50'

PROFILE:  
HORIZONTAL: 1" = 50'  
VERTICAL: 1" = 10'

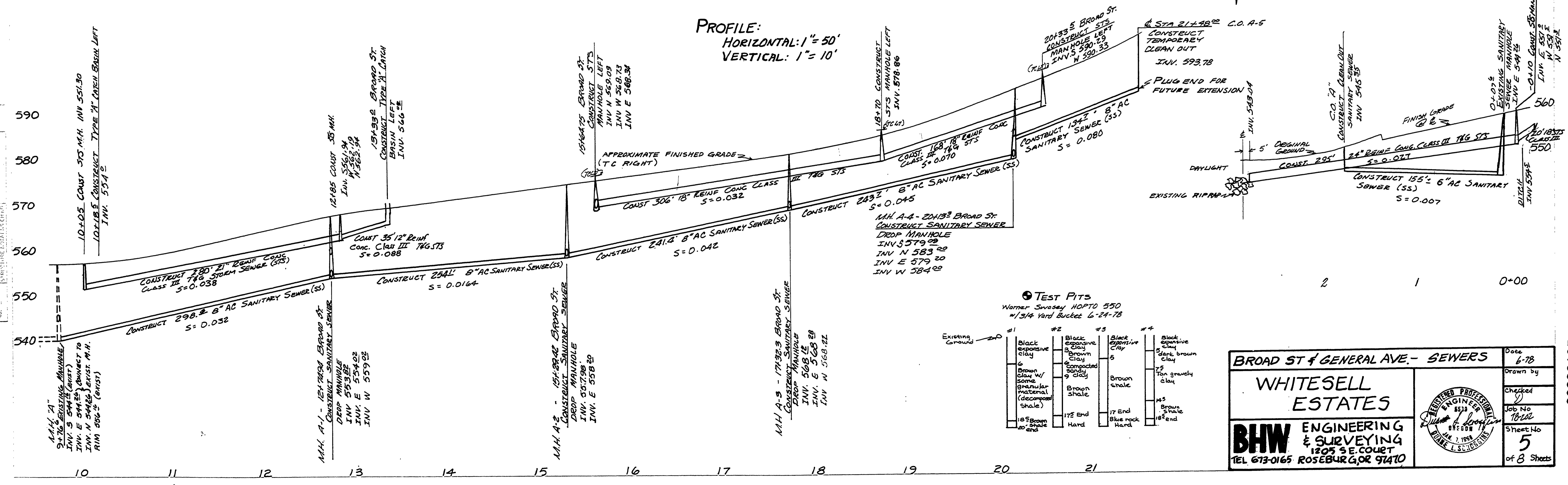

TEST PITS  
Warner Swasey HOPTO 550  
#1 3/4 Yard Buckets 6-24-78

#1	#2	#3	#4
Black expansive clay	Black expansive clay	Black expansive clay	Black expansive clay
5' clay	5' clay	5' clay	5' clay
6' Brown clay w/ some granular material (decomposed shale)	6' compacted sandy clay	7' Brown shale	7' Tan gravelly clay
18' Brown shale end	17' End Hard	17' End Blue rock Hard	18' End

**BROAD ST & GENERAL AVE. - SEWERS**

**WHITESELL ESTATES**

**BHW ENGINEERING & SURVEYING**  
1205 S.E. COURT  
TEL 673-0165 ROSEBURG, OR 97130

DATE: 6-78  
DRAWN BY: [Signature]  
CHECKED BY: [Signature]  
JOB NO: 1800  
SHEET NO: 5  
OF 8 SHEETS

REGISTERED PROFESSIONAL ENGINEER  
STATE OF OREGON  
JULY 2, 1988  
L.S. JOHNSON

00880105

RD # 217

1978

53E