

RD 200

18

NE 1/4 of SW 1/4

SE 1/4 of SW 1/4

NW 1/4 of NW 1/4

D 4° CR
Δ 54° 58' 15"
R 1432.40
T 745.20
L 1374.27

EDWARD G. KOLHAGEN
Vol. 204 Pg. 196

SW COR. DLC 44

233/712

S 49° 39' 00" W

R/W Line 2

R/W Line 3

SW 1/4 of SW 1/4

NW 1/4 of SW 1/4

NOTE:
Bearings and Coordinates - Lambert
Grid - Oregon South Zone

**DOUGLAS COUNTY, OREGON
ROAD NO. 200**

TWP 26 S. Date: 1954
RNG. 4 W. Sheet No. 8
SEC. 18 of Sheets
Scales Map 1"=100'
Profile: Hor. 1"=100'
Vert. 1"=10'
WALLY M. HECTOR COUNTY ENG.

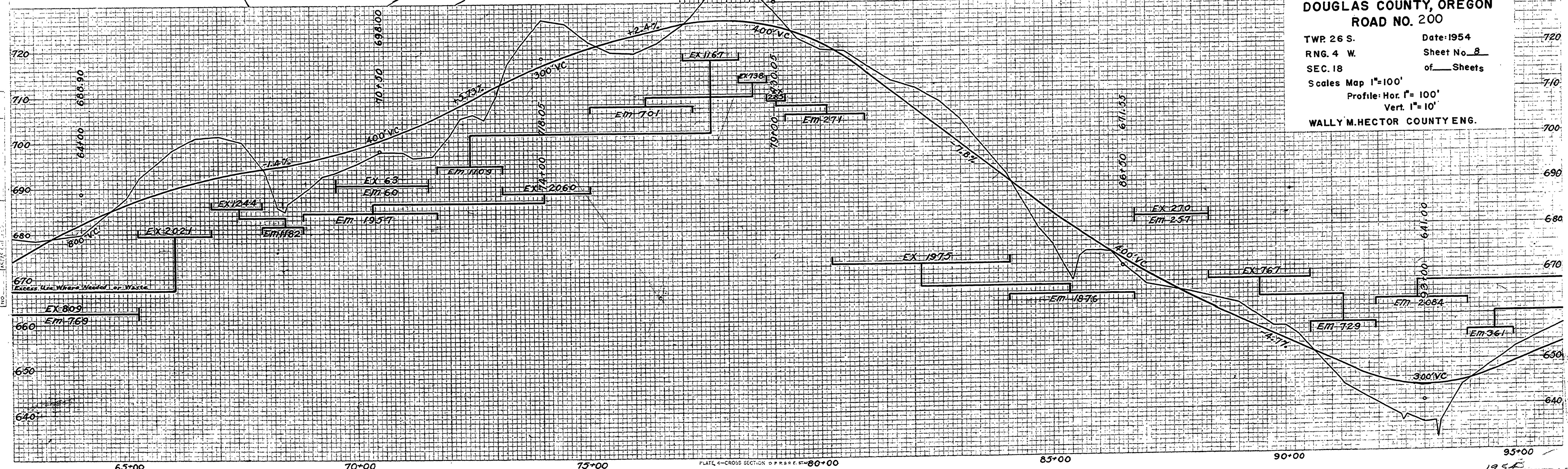

PLATE 4 - CROSS SECTION OF ROAD NO. 200 AT STATION 80+00

M.P. 10.00 - 9.34

1954
G. ROAD 200 5th 8 of 20 (20)

FINAL SURVEY
NOT RECORDED
DATE: 1954

ORIGINAL SURVEY
POINTS
REMARKS
NOTE BOOK
NO.

10000934