

Note: All Bearings on Lambert Grid - Oregon South Zone.

NOTE: 'o' R.P. - Iron Pin in R/W Lines

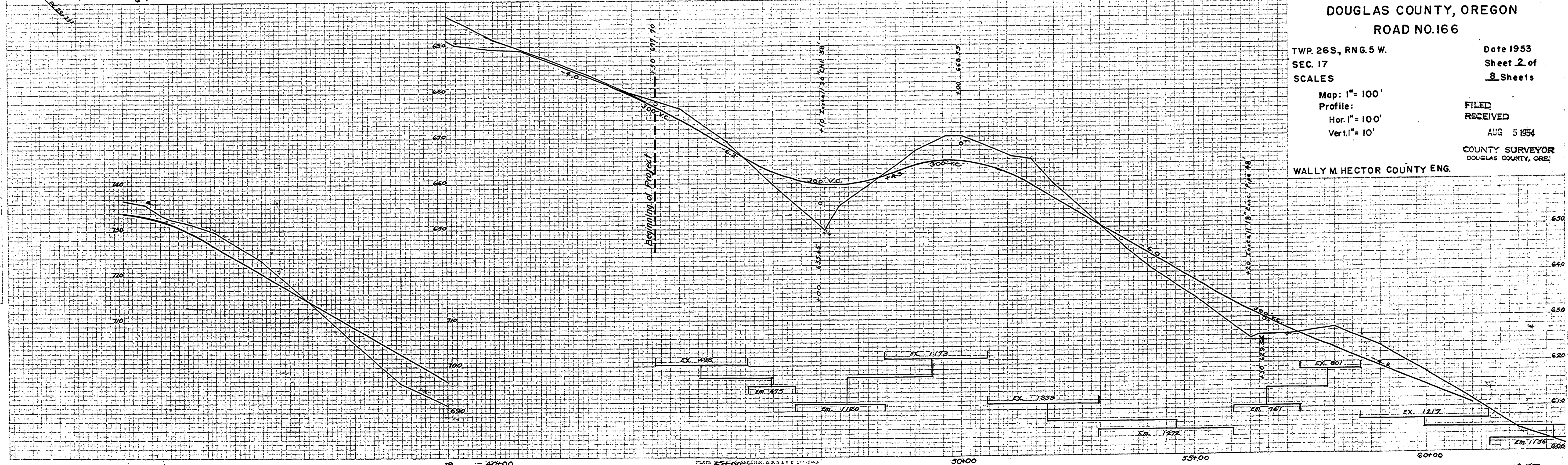

DOUGLAS COUNTY, OREGON
ROAD NO. 166
 TWP. 26S., RNG. 5 W.
 SEC. 17
 SCALES
 Map: 1" = 100'
 Profile: Hor. 1" = 100', Vert. 1" = 10'
 Date 1953
 Sheet 2 of 8 Sheets
 FILED
 RECEIVED
 AUG 5 1954
 COUNTY SURVEYOR
 DOUGLAS COUNTY, ORE.
 WALLY M. HECTOR COUNTY ENG.

01030167

M.P. 1.03-1.67

1953
 W.M. CALLED
 N. 200
 G.R. #166 sht 2 of 8